

Hemlock & Sugar

U. S. PUBLIC LAND SURVEY MONUMENT RECORD

INSTRUCTIONS:

This record shall show the location of the corner and shall include all of the following nine elements (a through i).

- (a) Identify the corner by reference to the U.S. public land survey system.
- = Corner monument restored.

Section corner to Sections 35-36, T33N, R14E and Sections 1-2, T32N, R14E, Langlade County, Wisconsin

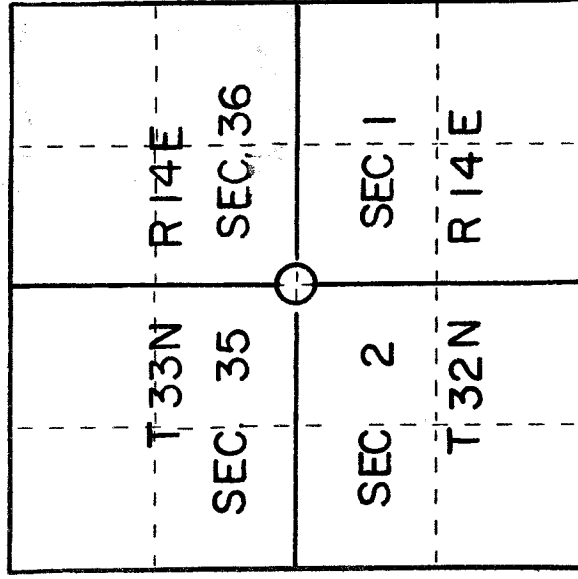

- (b) Describe any record evidence, monument evidence, occupational evidence, testimonial evidence or any other material evidence you considered, and whether the monument was found or placed.

In 1857 the government set a wood post 80.00 chains west with: Yellow Birch 22" N14E 60 links, Lynn 20" N20W 65 links, Hemlock 14" S55E 45 links, and a Hemlock 12" S55W 12 links.

At 77.20 chains a Hemlock line tree 12" in diameter

Found hardwood stump hole N20W 43 feet, Yellow Birch stump N14E 9.60', Hemlock stump S55W 7.92' and pieces of Hemlock S55#E 29.70'

At 182 feet east a Hemlock stump was found still standing above ground. I reset this corner from the bearing tree evidence located.

- (c) In the plan view drawing below, provide reference ties to at least 4 witness monuments, or, if the location is within a municipality, to at least 2 witness monuments. (Witness monuments shall be made of concrete, natural stone, iron or other equally durable material.) Describe witness monuments.

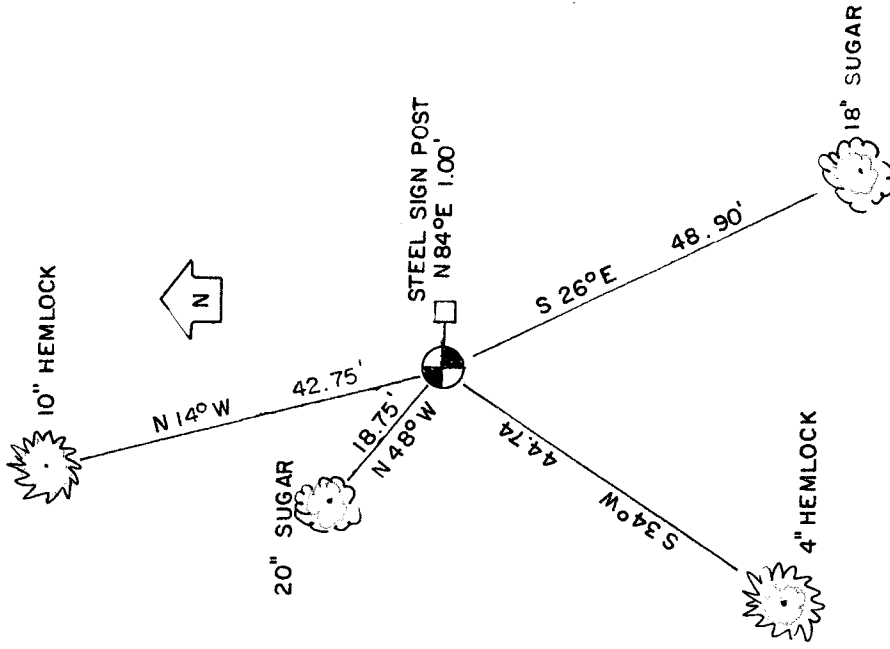

- (d) Show a plan view drawing depicting the relevant monuments and reference ties which is sufficient in detail to enable accurate relocation of the corner monument if the corner monument is disturbed. Indicate north.

Set a 2" x 30" Aluminum monument with cap stamped for corner with accessories set to USFS standard.

(e) Describe any material discrepancy between the location of the corner as restored or reestablished and the location of that corner as previously restored or reestablished by distance and direction. Show the discrepancy on the plan view drawing under (d), above. Show the distances between the corner as previously restored or reestablished and (1) the corner as restored or reestablished, and (2) to at least 2 of the witness monuments shown on the drawing in (d), above.

No discrepancy

(f) Was the corner restored through acceptance of (1) an obliterated evidence location, or, (2) a found perpetuated location?

Found perpetuated location

(g&h) Was the corner reestablished through lost corner proportionate methods? If so, show the method, including the directions and distances to other public land survey corners used as evidence or used for proportioning in determining the corner location?

NO

(i) I, Kim H Pritzlaff (type or print name) certify that the corner location shown on this record was determined by me or under my direction and control and that this U.S. Public Land Survey Monument Record is correct and complete to the best of my knowledge and belief.

Kim H Pritzlaff

6/25/84

Signature

Date

William J. Kelley Co. Surveyor *Northwest Corner 6-25-86*

