

CERTIFIED LAND CORNER RESTORATION

33-11

Index No. B-9

State of Wisconsin }
County of Langlade } ss.

History of original corner establishment:

Corner set in the 1930's by: C. W. Borth
E. F. Kowalke

I, Raymond J. Hallisy, do hereby certify that on the 11th day of June, 1968, I found evidence of the N 1/16 corner of Section 5, Township 33, North, Range 11, Fourth, Principal Meridian, as described hereon; and that from this evidence I established a new monument and accessories as described hereon to perpetuate the original location of this corner.

Description of corner evidence found:

Found squared stake standing. Fence running north and south
Marked 1/B S 5 S4

Resident witnesses:

.....
.....
.....

Description of monument and accessories I established to perpetuate the original location of this corner.

Set Std. 1 1/2" pipe with cap marked 5 4 N 1/16

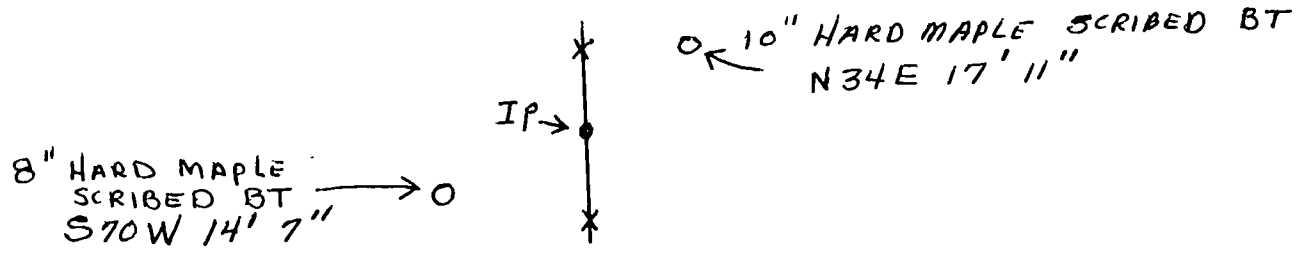
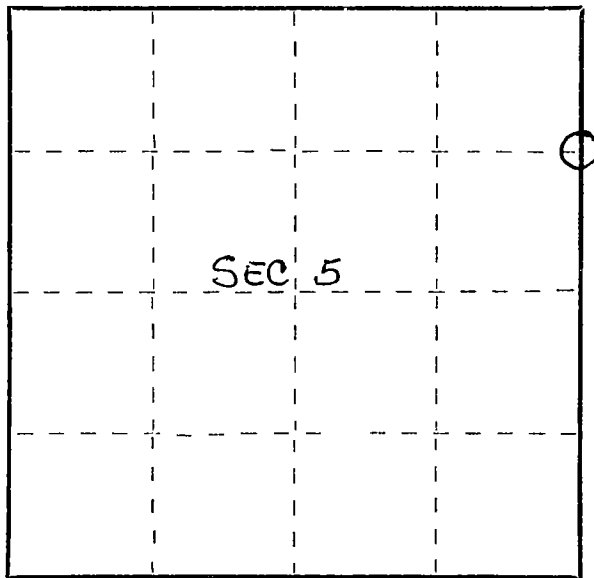

Dated at Antigo, Wis., this 11th day of June, 1968

Signature: Raymond J. Hallisy Title: Reg. Land Surveyor Registration No. 5-685
(County Surveyor, Registered Land Surveyor, or other duly authorized official)

Office of Register of Deeds, County of _____, I hereby certify that the within instrument was filed in this office for record on the _____ day of _____, 19____ at _____ o'clock _____ M.

(Register of Deeds)

By _____ Deputy

FORM 985 H. C. MILLER CO., MILWAUKEE

○ = Corner monument restored.