

CERTIFIED LAND CORNER RESTORATION

33-11

Index No. D-5

State of Wisconsin }
County of Langlade } ss.

History of original corner establishment:

I, Raymond J. Hallisy, do hereby certify that on the 11th day of June, 1968, I found evidence of the S 1/16 corner of Section 6 Township 33, North, Range 11, Fourth, Principal Meridian, as described hereon; and that from this evidence I established a new monument and accessories as described hereon to perpetuate the original location of this corner.

Corner set in the 1930's by: C. W. Borth
E. F. Kowalke

Description of corner evidence found:

**Found squared stake in rock fence
Marked 1/8 S5 S6**

Resident witnesses:

.....
.....
.....

Description of monument and accessories I established to perpetuate the original location of this corner.

Set Std. 1 1/2" pipe with cap marked 6 5 S 1/16

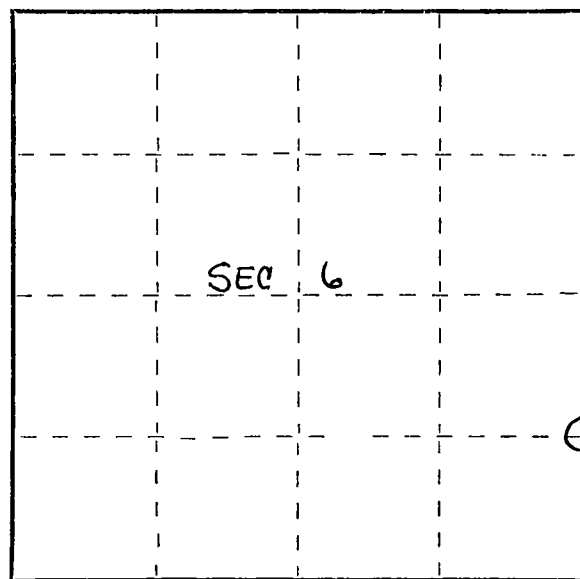
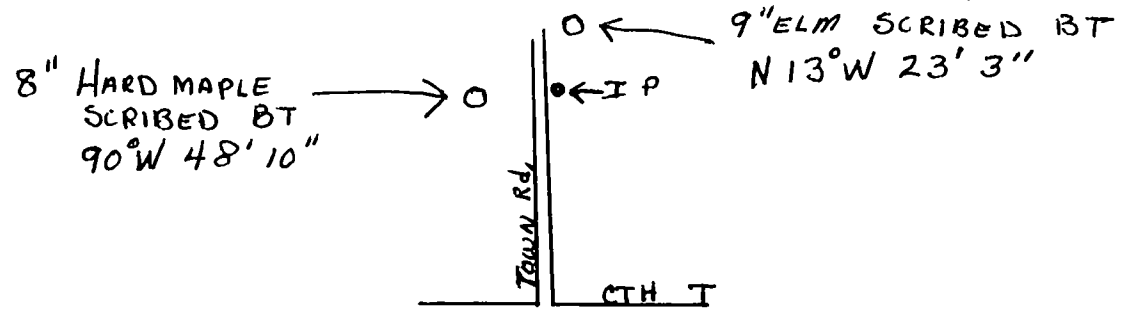

○ = Corner monument restored.

Dated at Antigo, Wis., this 11th day of June, 1968.

Signature Raymond J. Hallisy Title Land Surveyor Registration No. 5-685 Wis.
(County Surveyor, Registered Land Surveyor, or other duly authorized official)

Office of Register of Deeds, County of _____, I hereby certify that the within instrument was filed in this office for record on the _____ day of _____, 19____ at _____ o'clock _____ M.

.....
(Register of Deeds)

By _____ Deputy

FORM 985 H C MILLER CO., MILWAUKEE