

CERTIFIED LAND CORNER RESTORATION

Index No. J-9  
33-11

State of Wisconsin }  
County of Langlade } ss.

I Raymond J. Hallisy, do hereby certify that on the 9th day of October, 1977, I found evidence of the Section corner of 8, 9, 16, & 17 Township 33, North, Range 11E, Fourth Principal Meridian, as described hereon; and that from this evidence I established a new monument and accessories as described hereon to perpetuate the original location of this corner.

Resident witnesses:

.....  
.....  
.....

History of original corner establishment:

Corner set in the 1930 resurvey.

Description of corner evidence found:

4" iron pipe with Brass Cap.

Description of monument and accessories I established to perpetuate the original location of this corner.

New BT's

- 10" Red Pine S81E 2.7 Ft.
- 8" Hard Maple N21E 21.9 Ft.
- 8" Red Pine S89W 1.9 Ft.
- 10" Red Pine S16W 19.2 Ft.

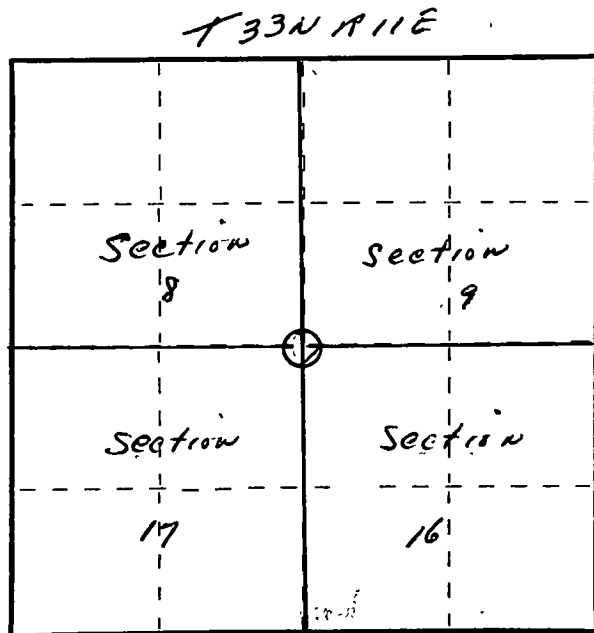
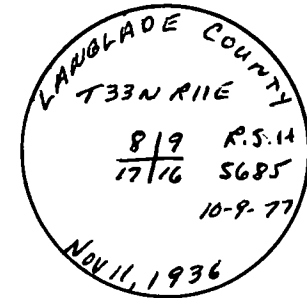

○ = Corner monument restored.

Dated at Antigo, Wis., this 9th day of October, 1977

Signature Raymond J. Hallisy Title Land Surveyor Registration No. S685  
(County Surveyor, Registered Land Surveyor, or other duly authorized official)

Office of Register of Deeds, County of \_\_\_\_\_, I hereby certify that the within instrument was filed in this office for record on the \_\_\_\_\_ day of \_\_\_\_\_, 19\_\_\_\_ at \_\_\_\_\_ o'clock \_\_\_\_\_ M.

(Register of Deeds)

By \_\_\_\_\_ Deputy