

CERTIFIED LAND CORNER RESTORATION

Index No. J-6

State of Wisconsin }
County of Lanai } ss.

I, Raymond Hally, do hereby certify that on the 4th day of August, 1974, I found evidence of the W 1/6 corner of Sec 8 E 17 Township 33, North, Range 11E, Fourth Principal Meridian, as described hereon; and that from this evidence I established a new monument and accessories as described hereon to perpetuate the original location of this corner.

Resident witnesses:

.....
.....
.....

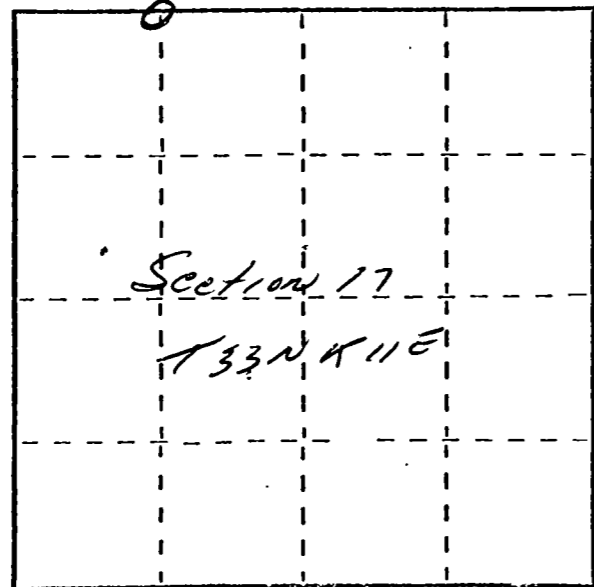

○ = Corner monument restored.

History of original corner establishment:

1930 Resurvey

Description of corner evidence found:

Wood post down, Rock mound

Description of monument and accessories I established to perpetuate the original location of this corner.

Set 1 1/2" pipe with Brass Cap
Rock mound
New BT

8" cherry S88E 15 FT. 7 inches



Dated at Antigo, Wis., this 4th day of August, 1974.

Signature Raymond Hally Title Reg. Land Surveyor Registration No. 5-685
(County Surveyor, Registered Land Surveyor, or other duly authorized official)

Office of Register of Deeds, County of....., I hereby certify that the within instrument was filed in this office for record on the.....day of....., 19..... at.....o'clock..... M.

.....
(Register of Deeds)

By.....Deputy

FORM 985 M. C. MILLER CO., MILWAUKEE