

CERTIFIED LAND CORNER RESTORATION

33-11

Index No. N-22

State of Wisconsin }  
County of Langlade } ss.

History of original corner establishment:

Corner set in the 1930 resurvey.

I, Raymond J. Hallisy, do hereby certify that on the 9th day of May, 1970, I found evidence of the W 1/16 corner of Section 24 Township 33, North, Range 11E, Fourth, Principal Meridian, as described hereon; and that from this evidence I established a new monument and accessories as described hereon to perpetuate the original location of this corner.

Description of corner evidence found:

Found old stake standing, rock mound, marked 24 13 1/8

Resident witnesses:

J. Weix  
J. Kryka

Description of monument and accessories I established to perpetuate the original location of this corner.

Set 2" pipe with brass cap, rock mound.

New B.T.'s

Hard maple 8" N57W 25 Ft. 1 inch  
Basswood 4" S5W 2 Ft.

B.T.'s faced at base of tree and scribed BT.

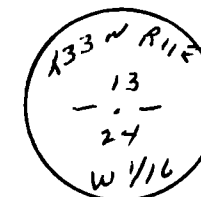

FORM 985 M. C. MILLER CO., MILWAUKEE

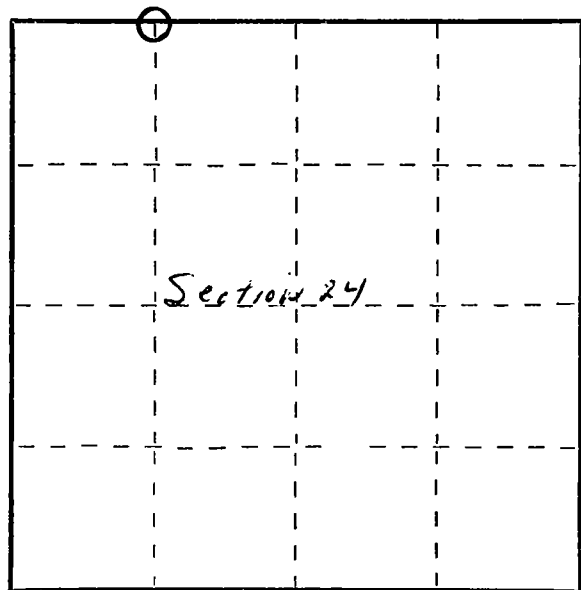

○ = Corner monument restored.

Dated at Antigo, Wis., this 9th day of May, 1970

Signature Raymond J. Hallisy Title Reg. Land Surveyor Registration No. S-685  
(County Surveyor, Registered Land Surveyor, or other duly authorized official)

Office of Register of Deeds, County of \_\_\_\_\_, I hereby certify that the within instrument was filed in this office for record on the \_\_\_\_\_ day of \_\_\_\_\_, 19\_\_\_\_ at \_\_\_\_\_ o'clock \_\_\_\_\_ M.

(Register of Deeds)

By \_\_\_\_\_ Deputy