

CERTIFIED LAND CORNER RESTORATION

Index No. L-25

433113 2000 1981

FORM 985 H. C. MILLER CO., MILWAUKEE

State of Wisconsin }  
County of LANGLADE } ss.

I RAYMOND J. HALLISY, do hereby certify that on the 28th day of MARCH, 1981, I found evidence of the 1/4 cor corner of SECTION 13 Township 33, North, Range 11 E, Fourth Principal Meridian, as described hereon; and that from this evidence I established a new monument and accessories as described hereon to perpetuate the original location of this corner.

Resident witnesses:

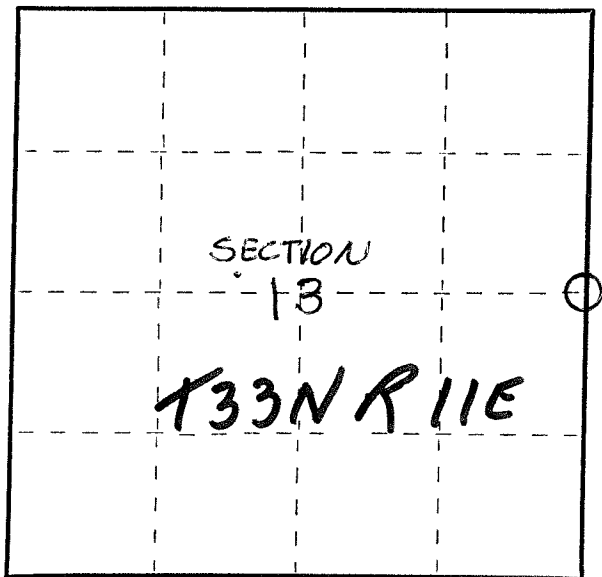

○ = Corner monument restored.

History of original corner establishment:

ESTABLISHED IN 1936 RESURVEY

Description of corner evidence found:

4" IRON PIPE WITH BRASS CAP  
B.O.  
STONE WITH X N14E 7' 2"  
STONE WITH + S87W 20' 10"

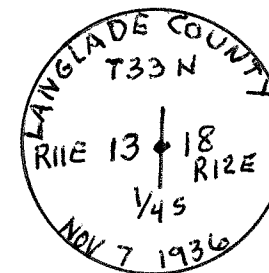

Description of monument and accessories I established to perpetuate the original location of this corner.

NEW B.T.S  
8" BASSWOOD N12W 11' 2"  
8" HARD MAPLE S5W 31' 1"  
8 BASSWOOD S86W 35'

Dated at ANTIGO, Wis., this 28th day of MARCH, 1981.

Signature Raymond Hallisy Title REGISTERED LAND SURVEYOR Registration No. 5685  
(County Surveyor, Registered Land Surveyor, or other duly authorized official)

Office of Register of Deeds, County of \_\_\_\_\_, I hereby certify that the within instrument was filed in this office for record on the \_\_\_\_\_ day of \_\_\_\_\_, 19\_\_\_\_ at \_\_\_\_\_ o'clock \_\_\_\_\_ M.

(Register of Deeds)

By \_\_\_\_\_ Deputy