

CERTIFIED LAND CORNER RESTORATION

33-11

Index No. N-20

State of Wisconsin }
County of Langlade } ss.

I, Raymond J. Hallisy, do hereby certify that on the 5th day of July, 19 69, I found evidence of the E 1/16 corner of Section 23 Township T33, North, Range 11E, Fourth, Principal Meridian, as described hereon; and that from this evidence I established a new monument and accessories as described hereon to perpetuate the original location of this corner.

History of original corner establishment:

Corner set in the 1930 resurvey

Description of corner evidence found:

Found wood post standing, rock mound in white spruce plantation
Post marked 1/8 26 23

Resident witnesses:

.....
.....
.....

Description of monument and accessories I established to perpetuate the original location of this corner.

Set 2" iron pipe with brass cap, rock mound
B/T.'s to corner
6" white spruce N8W 5 Ft.
7" white spruce S57E 9 Ft. 10 inches
B.T.'s faced at base and scribed BT

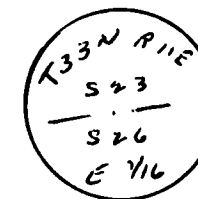

FORM 985 H. C. MILLER CO., MILWAUKEE

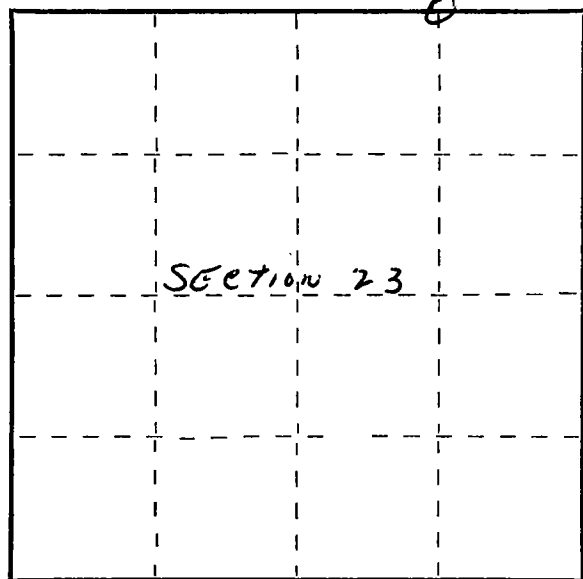

○ = Corner monument restored.

Dated at Antigo, Wis., this 5th day of July, 19 69.

Signature Raymond J. Hallisy Title Reg. Land Surveyor Registration No. S-685
(County Surveyor, Registered Land Surveyor, or other duly authorized official)

Office of Register of Deeds, County of _____, I hereby certify that the within instrument was filed in this office for record on the _____ day of _____, 19 _____ at _____ o'clock _____ M.

.....
(Register of Deeds)

By _____ Deputy