

CERTIFIED LAND CORNER RESTORATION

33-11 Index No. N-8

State of Wisconsin }
County of Lanqade } ss.

History of original corner establishment:

I, Robert J. Poss, do hereby certify that on the 22nd day of May, 1968, I found evidence of the East 1/4 corner of Sections 17 & 20 Township 33, North, Range 11 East, Fourth, Principal Meridian, as described hereon; and that from this evidence I established a new monument and accessories as described hereon to perpetuate the original location of this corner.

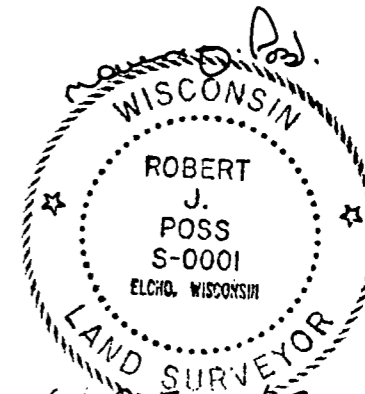

Description of corner evidence found:

Original Cor. Obliterated; found pickets of L.C. Forest Crew.

Resident witnesses:

.....
.....
.....

Description of monument and accessories I established to perpetuate the original location of this corner.

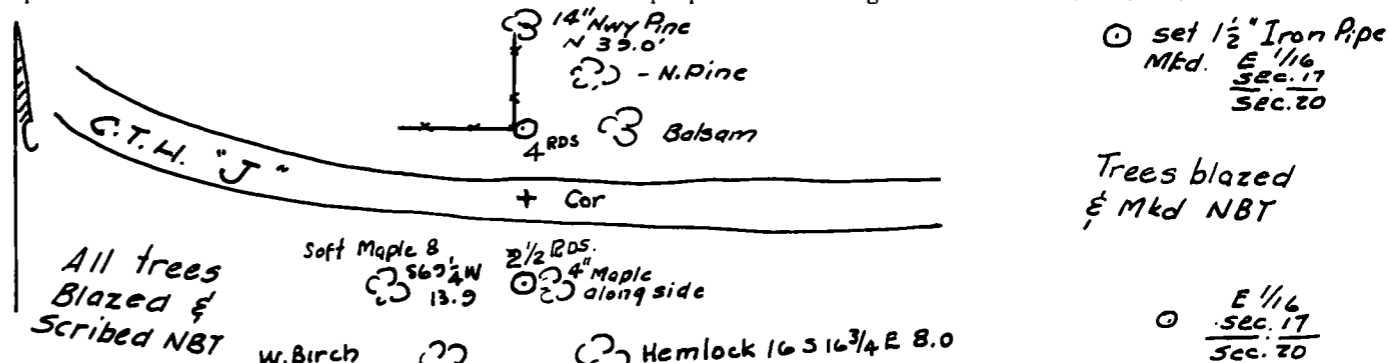
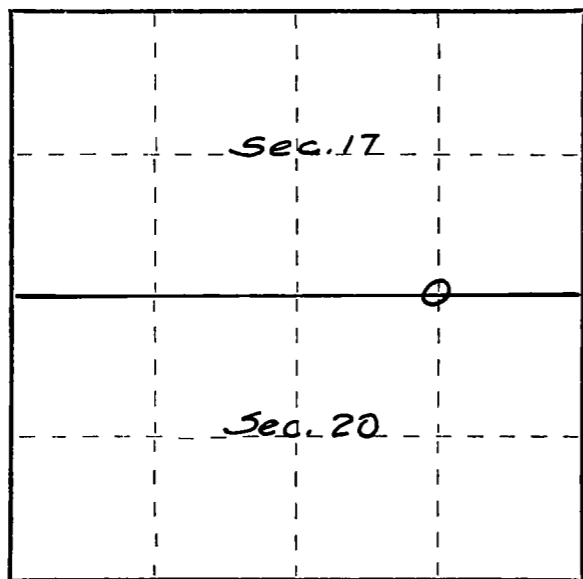

Dated at Elcho, Wis., this 23rd day of May, 1968.

Signature Robert J. Poss Title Reg. Land Surveyor Registration No. 5-1
(County Surveyor, Registered Land Surveyor, or other duly authorized official)

Office of Register of Deeds, County of _____, I hereby certify that the within instrument was filed in this office for record on the _____ day of _____, 19____ at _____ o'clock _____ M.

(Register of Deeds)

By _____ Deputy

○ = Corner monument restored.

FORM 985 R. C. MILLER CO., MILWAUKEE