

CERTIFIED LAND CORNER RESTORATION

Index No. P-5

State of Wisconsin }
County of Lan glade } ss.

I Raymond J. Hallisy, do hereby certify that on the 14th day of March, 1981, I found evidence of the 1/4 corner of Section 19 & 20 Township 33, North, Range 11E, Fourth Principal Meridian, as described hereon; and that from this evidence I established a new monument and accessories as described hereon to perpetuate the original location of this corner.

Resident witnesses:
.....
.....
.....

FORM 985 K. C. MILLER CO., MILWAUKEE

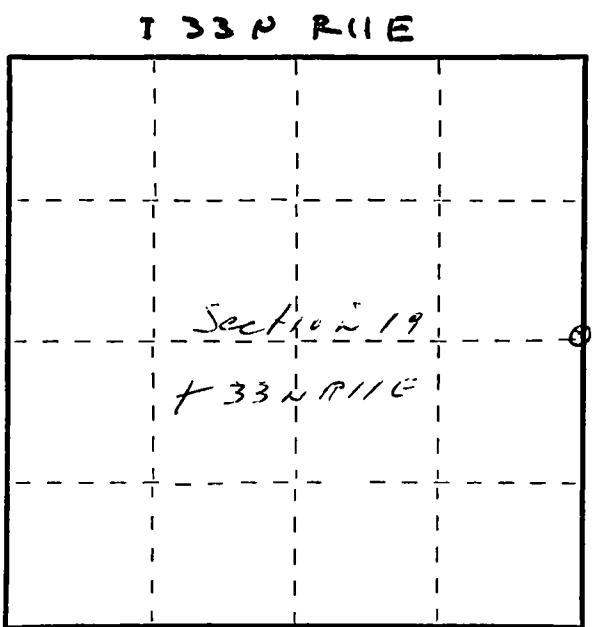

○ = Corner monument restored.

History of original corner establishment:
Corner set in the 1930 resurvey.

Description of corner evidence found:
1" pipe with brass cap, 1 1/2" pipe alongside.
B.O.'s
6" cedar post, marked 1/4 S BT N20W 6'2"
6" cedar post, marked 1/4 S BT S20E 6'

08/16/96 Dave Tlusty *FB12-23*
Found 4" iron pipe with brass cap flush with swamp (bog). Found solid 6" cedar post NW, 6'+ and SE, 6'+. Nailed BT signs to both posts. Nailed 2 BT signs to tamarac, 2", N20°E, 11'+. This is the only tree of any size in the area. Set vinyl sign post, S20°E, 0.8'. Painted all blue. Corner is 370' south of high ground to the north.

Dave E. Tlusty
8/21/96

Description of monument and accessories I established to perpetuate the original location of this corner.

No new BT's, corner sets in a leatherleaf bog with no trees nearby.

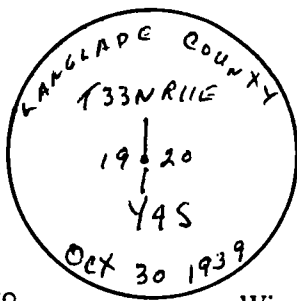

Dated at Antigo, Wis., this 14th day of March, 1981

Signature Raymond J. Hallisy Title Reg. surveyor Registration No. S-685
(County Surveyor, Registered Land Surveyor, or other duly authorized official)

Office of Register of Deeds, County of....., I hereby certify that the within instrument was filed in this office for record on the.....day of....., 19..... at..... o'clock..... M.

.....
(Register of Deeds)

By.....Deputy