

CERTIFIED LAND CORNER RESTORATION

Index No. P-3

State of Wisconsin }
 County of LANGLADE } ss.

I, WILLIAM F. KELLY, do hereby certify that on the 17th day of NOVEMBER, 1980, I found evidence of the CENTER corner of SEC. 19 Township 33, North, Range 11 EAST, Fourth Principal Meridian, as described hereon; and that from this evidence I established a new monument and accessories as described hereon to perpetuate the original location of this corner.

Resident witnesses:

.....

FORM 985 H. C. MILLER CO., MILWAUKEE

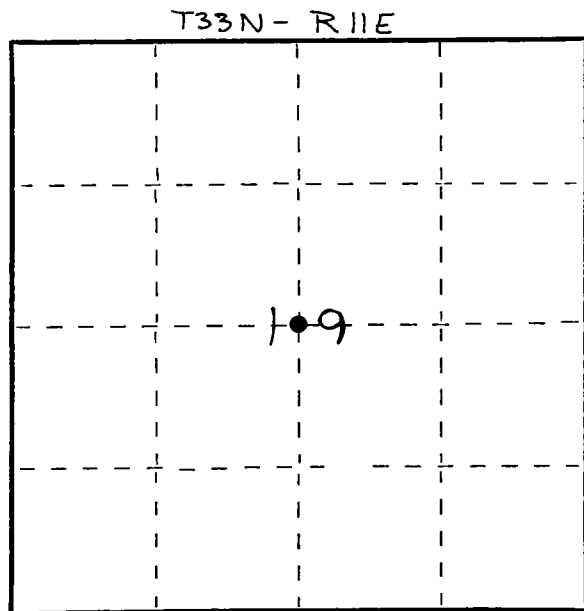

○ = Corner monument restored.

History of original corner establishment:

Description of corner evidence found:

REPLACED 1" IRON PIPE FOUND IN PLACE WITH A 2" BRASS CAP MONUMENT. CORNER EST. BY PREVIOUS SURVEY OF SEC 19 BY C BORTH

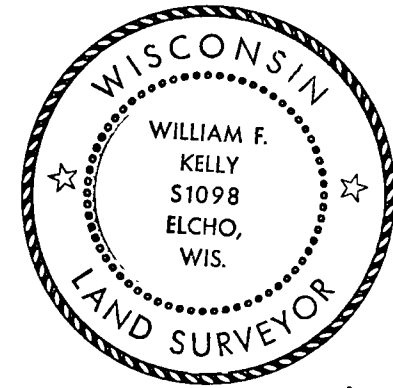

William F. Kelly

SET 2" x 42" BLACK IRON PIPE WITH BRASS CAP MONUMENT.
 Description of monument and accessories I established to perpetuate the original location of this corner.

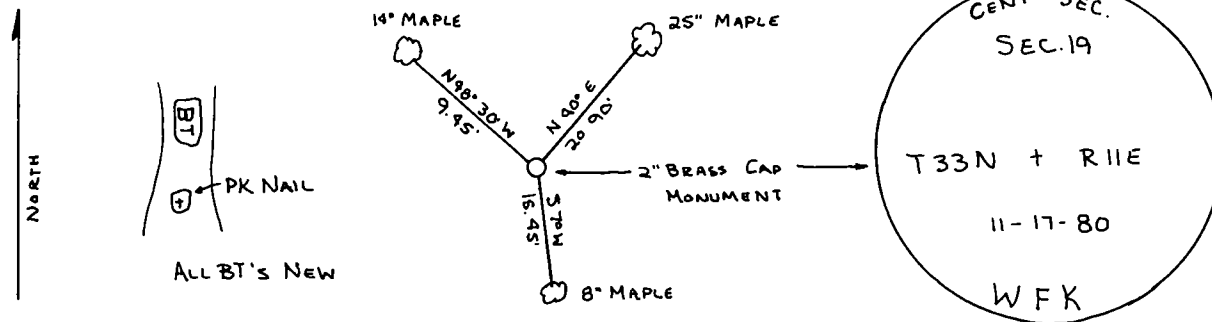

Dated at ELCHO, Wis., this 17th day of NOV, 1980.

Signature William F. Kelly Title COUNTY SURVEYOR Registration No. 1098
 (County Surveyor, Registered Land Surveyor, or other duly authorized official)

Office of Register of Deeds, County of _____, I hereby certify that the within instrument was filed in this office for record on the _____ day of _____, 19____ at _____ o'clock _____ M.

.....
 (Register of Deeds)

By _____ Deputy