

CERTIFIED LAND CORNER RESTORATION

33-11
Index No. Q-25

State of Wisconsin }
County of Langlade } ss.

I Raymond J. Hallisy do hereby certify that on the 9th day of May, 19 70, I found evidence of the S 1/16 corner of XX Section 24 Township 33, North, Range 11 & 12E, Fourth, Principal Meridian, as described hereon; and that from this evidence I established a new monument and accessories as described hereon to perpetuate the original location of this corner.

Resident witnesses:

J. Weir
J. Kryka

FORM 985 W. C. MILLER CO., MILWAUKEE

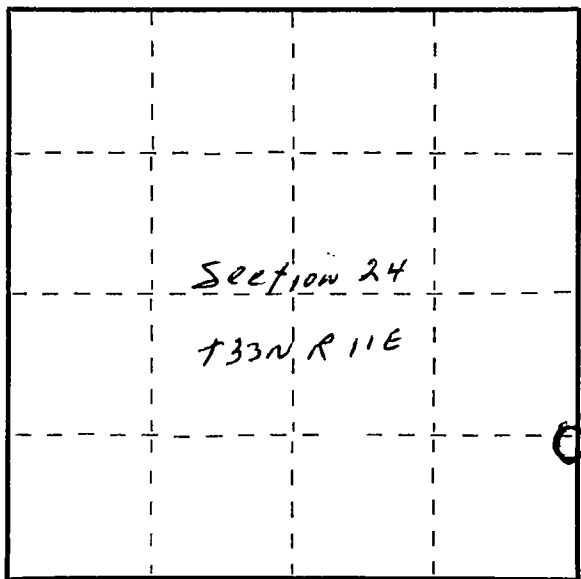

○ = Corner monument restored.

History of original corner establishment:

Corner set in the 1930 resurvey.

Description of corner evidence found:

Found old stake standing, rock mound, marked ~~XXIX~~ 1/8 19 24

Description of monument and accessories I established to perpetuate the original location of this corner.

Set 2" pipe with brass cap, rock mound.

New B.T.'s
Red maple 4" N57W 7 Ft. 10 inches
Spruce 5" S58W 18 Ft. 3 inches
B.T.'s faced at base of tree and scribed BT.



Dated at Antigo, Wis., this 9th day of May, 19 70

Signature Raymond J. Hallisy Title Reg. Land Surveyor Registration No. S-685
(County Surveyor, Registered Land Surveyor, or other duly authorized official)

Office of Register of Deeds, County of _____, I hereby certify that the within instrument was filed in this office for record on the _____ day of _____, 19 _____ at _____ o'clock _____ M.

(Register of Deeds)

By _____ Deputy