

CERTIFIED LAND CORNER RESTORATION

Index No. V-22-23

State of Wisconsin }  
County of Lanaiade } ss.

I Raymond Hallisy, do hereby certify that on the 20th day of June, 1987, I found evidence of the M.C. corner on West shore of Pence LK. Township 33, North, Range 11E, Fourth Principal Meridian, as described hereon; and that from this evidence I established a new monument and accessories as described hereon to perpetuate the original location of this corner.

Resident witnesses:

History of original corner establishment:

set in 1930, s Resurvey

Description of corner evidence found:

White pine B.T gone

4" BRASS

CAPO N

IRON

Pipe in

PARKING LOT - TOP OF CORNER LEVEL WITH PARKING LOT

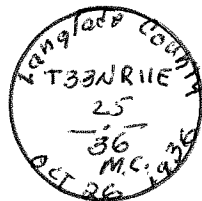

Description of monument and accessories I established to perpetuate the original location of this corner.

NEW BT'S

White Birch 7" N27°E 151.5 LKS

Cherry 3" N2°E 120.5 LKS

Aspen 6" N19°W 129 LKS

T33N R11E

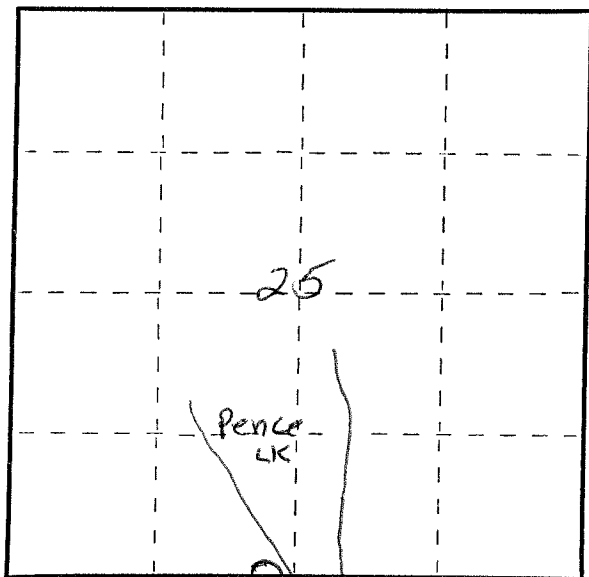

○ = Corner monument restored.

Dated at Antigo, Wis., this 20th day of June, 1987

Signature Raymond Hallisy Title Land Surveyor Registration No. 3-685  
(County Surveyor, Registered Land Surveyor, or other duly authorized official)

Office of Register of Deeds, County of \_\_\_\_\_, I hereby certify that the within instrument was filed in this office for record on the \_\_\_\_\_ day of \_\_\_\_\_, 19\_\_\_\_ at \_\_\_\_\_ o'clock \_\_\_\_\_ M.

(Register of Deeds)

By \_\_\_\_\_ Deputy