

CERTIFIED LAND CORNER RESTORATION

33-11

Index No. V-20

State of Wisconsin }
County of Langlade } ss.

I Raymond J. Hallisy do hereby certify that on the 10th day of May, 19 70, I found evidence of the E 1/16 corner of Section 26 Township 33, North, Range 11E, Fourth, Principal Meridian, as described hereon; and that from this evidence I established a new monument and accessories as described hereon to perpetuate the original location of this corner.

Resident witnesses:
J. Weiss
J. Kuyper

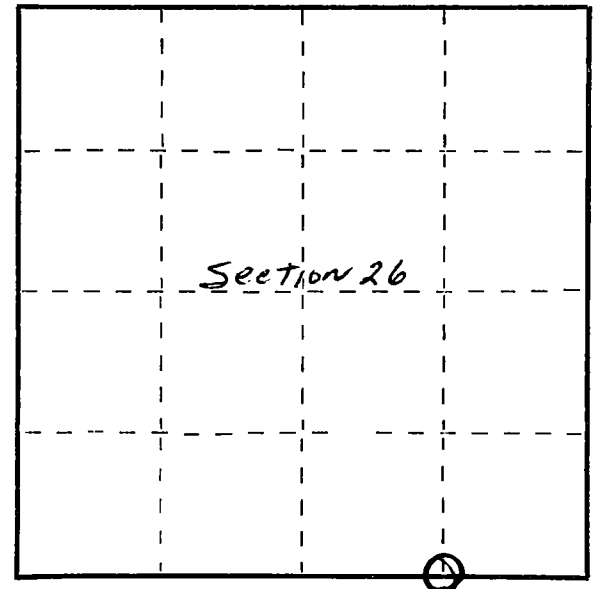

○ = Corner monument restored.

History of original corner establishment:

Corner set in the 1930 resurvey.

Description of corner evidence found:

Found old stake standing in fence line. Fence east, west, and south. Marked 1/8 26 35, rock mound.

Description of monument and accessories I established to perpetuate the original location of this corner.

Set 2" pipe with brass cap, rock mound.
New B.T.'s

- Red maple 6" N72W 15 Ft. 7 inches
- Red maple 8" N24W 16 Ft. 9 inches

B.T.'s faced ~~XXX~~ at base of tree and scribed BT.



Dated at Antigo, Wis., this 10th day of May, 19 70

Signature Raymond J. Hallisy Title Reg. Land Surveyor Registration No. S-685
(County Surveyor, Registered Land Surveyor, or other duly authorized official)

Office of Register of Deeds, County of _____, I hereby certify that the within instrument was filed in this office for record on the _____ day of _____, 19 _____ at _____ o'clock _____ M.

(Register of Deeds)

By _____ Deputy

FORM 985 H. C. MILLER CO., MILWAUKEE