

CERTIFIED LAND CORNER RESTORATION

33-11

Index No. U-21

State of Wisconsin }
County of Lanlade } ss.

History of original corner establishment:

Corner set in the 1930's by: E. F. Kowalke
C. W. Borth

I, Raymond J. Hallisy, do hereby certify that on the 22nd day of June, 1968, I found evidence of the S 1/16 corner of Section 26 Township 33, North, Range 11, Fourth, Principal Meridian, as described hereon; and that from this evidence I established a new monument and accessories as described hereon to perpetuate the original location of this corner.

Description of corner evidence found:

Found squared stake, bed rail in original hole, rock mound.
Stake marked 1/8 S25 S26

Resident witnesses:

Description of monument and accessories I established to perpetuate the original location of this corner.

Set std. 1 1/2" pipe with cap marked S 1/16 26 25

SEE NOTE ON REVERSE
2/22/02
D. B. [unclear]

IP
O ← 9" ASPEN 14'4" SCRIBED BT
O ← 8" ASPEN S18E 3'2" SCRIBED BT

FORM 985 H. C. MILLER CO., MILWAUKEE

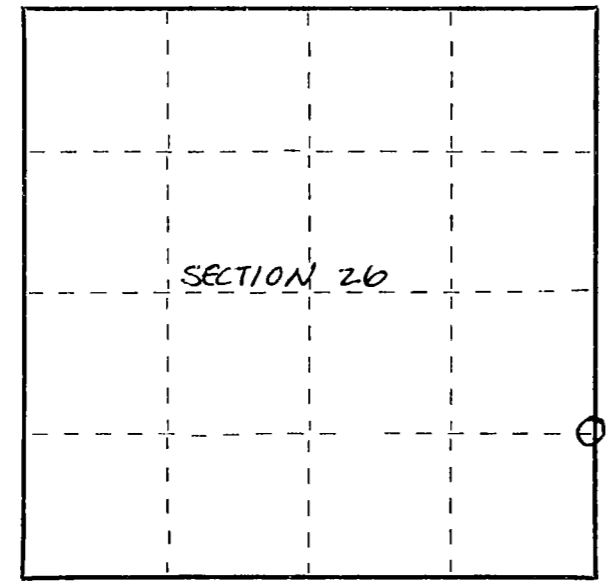

○ = Corner monument restored.

Dated at Antigo, Wis., this 22nd day of June, 1968.

Signature: Raymond J. Hallisy Title: Land Surveyor Registration No. S-685
(County Surveyor, Registered Land Surveyor, or other duly authorized official)

Office of Register of Deeds, County of _____, I hereby certify that the within instrument was filed in this office for record on the _____ day of _____, 19____ at _____ o'clock _____ M.

(Register of Deeds)

By _____ Deputy

02/21/2002

Dave Tlusty, Dale Carlson found this iron pipe w/brass cap and bed rail on west edge of 9" red pine, approximately 125 feet south of Pence Lake Road. We get a GPS distance of 1428' from this point to the 1/4 corner to the north. The 1936 resurvey distance was 1332.9'. The 1936 survey showed that the 1/16th corner was approximately 32.9 feet south of Pence Lake Road. I believe the corner tied by Hallisy is wrong. At the computed location for the 1/16th corner we found a 2" aluminum capped monument which is approximately 33 feet south of the center of Pence Lake Road. I believe someone traversed from the SW corner to the W1/4 of Section 25, and set this aluminum monument for the 1/16th corner. No ties to the aluminum monument were made at this time. This note has been added to the corner form just to make future users aware that the iron pipe with brass cap as shown on the front side of this form is not correct.

D. Tlusty
2/22/02

