

CERTIFIED LAND CORNER RESTORATION

33-11

Index No. S-21

State of Wisconsin }
County of Langlade } ss.

I Raymond Hellisy do hereby certify that on the 12TH day of MAY, 1973, I found evidence of the N 1/4 corner of Section 25 & 26 Township 33, North, Range 11E, Fourth, Principal Meridian, as described hereon; and that from this evidence I established a new monument and accessories as described hereon to perpetuate the original location of this corner.

Resident witnesses:

.....
.....
.....

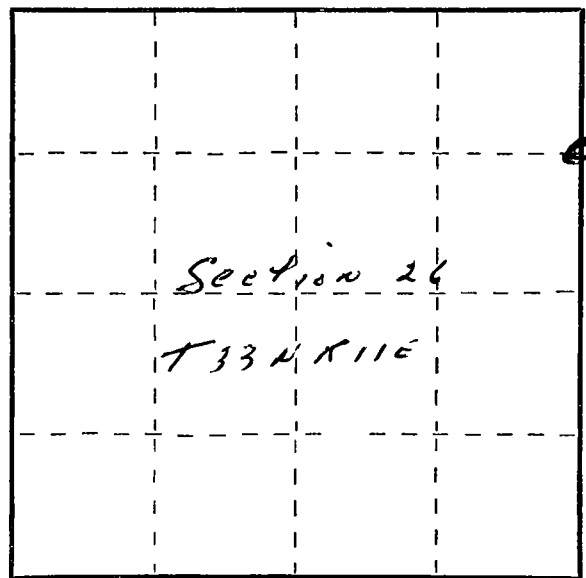

○ = Corner monument restored.

History of original corner establishment:

Corner set in the 1930 resurvey

Description of corner evidence found:

Wood stake standing in large rock mound
marked S 25, 26 1/4

Description of monument and accessories I established to perpetuate the original location of this corner.

Set 1 1/2" iron pipe with brass cap - marked
New BT's
Red oak 12" S30E 14 FT
Red oak 10" N38E 7 FT. 10 in.

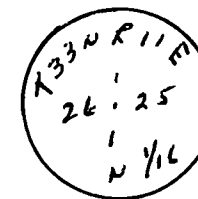

Dated at Antigo, Wis., this 12TH day of MAY, 1973.

Signature Raymond Hellisy Title Reg. Land Surveyor Registration No. 5-685
(County Surveyor, Registered Land Surveyor or other duly authorized official)

Office of Register of Deeds, County of _____, I hereby certify that the within instrument was filed in this office for record on the _____ day of _____, 19____ at _____ o'clock _____ M.

.....
(Register of Deeds)

By _____ Deputy

FORM 985 M. C. MILLER CO., MILWAUKEE