

CERTIFIED LAND CORNER RESTORATION

32-11

Index No. A-12

State of Wisconsin }  
County of Langlade } ss.

History of original corner establishment:

I Raymond J. Hallisy, do hereby certify that on the 12th day of June, 1971, I found evidence of the E 1/16 corner of Section 4 & 33 Township 32 & 33, North, Range 11E, Fourth, Principal Meridian, as described hereon; and that from this evidence I established a new monument and accessories as described hereon to perpetuate the original location of this corner.

Corner set in the 1930 resurvey.

Description of corner evidence found:

Found old wood stake down, point intact, rock mound, Marked 1/8

Resident witnesses:

.....  
.....  
.....

Description of monument and accessories I established to perpetuate the original location of this corner.

Set 2" pipe with brass cap, rock mound.

BT's to corner  
5" Red Maple N64E 45 Feet 7 inches  
8" Red Maple N55W 40 Feet 5 inches  
BT's faced at base of tree and ~~XX~~ scribed BT.

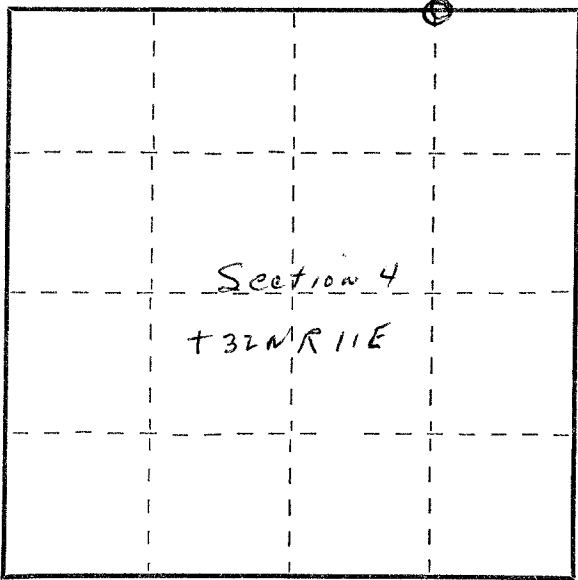

○ = Corner monument restored.

Dated at Antigo, Wis., this 12th day of June, 1971

Signature R. J. Hallisy Title Reg. Land Surveyor Registration No. S-685  
(County Surveyor, Registered Land Surveyor, or other duly authorized official)

Office of Register of Deeds, County of....., I hereby certify that the within instrument was filed in this office for record on the..... day of....., 19..... at..... o'clock..... M.

(Register of Deeds)

By..... Deputy

FORM 985 H. C. MILLER CO., MILWAUKEE