

CERTIFIED LAND CORNER RESTORATION

Index No. V-W-23

State of Wisconsin }
County of Lan g l a d e } ss.

I, Raymond S. Hallisy, do hereby certify that on the 28th day of August, 1976, I found evidence of the M.C. corner of Pence Lake, Section 36 Township 33, North, Range 11E, Fourth Principal Meridian, as described hereon; and that from this evidence I established a new monument and accessories as described hereon to perpetuate the original location of this corner.

Resident witnesses:

.....
.....
.....

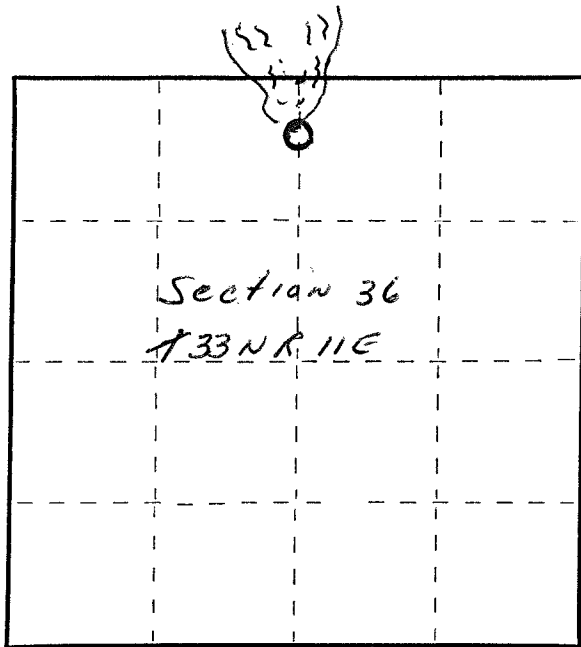

○ = Corner monument restored.

History of original corner establishment:

Set by Dorr.

Description of corner evidence found:

1 1/2" pipe on South Shore of Pence Lake on the center line of Section 36

Description of monument and accessories I established to perpetuate the original location of this corner.

Set 2" pipe with brass cap alongside 1 1/2" pipe

New BT's

14" OAK S83E 25.3 FT

8" White Birch S73W 12.4 FT

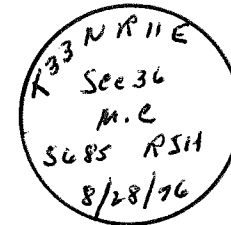

Dated at Antigo, Wis., this 28th day of August, 1976.

Signature Raymond S. Hallisy Title Reg. Land Surveyor Registration No. 5685
(County Surveyor, Registered Land Surveyor, or other duly authorized official)

Office of Register of Deeds, County of _____, I hereby certify that the within instrument was filed in this office for record on the _____ day of _____, 19____ at _____ o'clock _____ M.

.....
(Register of Deeds)

By _____ Deputy