

CERTIFIED LAND CORNER RESTORATION

Index No. H-21

State of Wisconsin }
 County of LANGLADE } ss.

I WILLIAM F. KELLY, do hereby certify that on the 16th day of APRIL, 19 81, I found evidence of the S 1/4 corner of SEC. 11 1/2 Township 33, North, Range 13 EAST, Fourth Principal Meridian, as described hereon; and that from this evidence I established a new monument and accessories as described hereon to perpetuate the original location of this corner.

Resident witnesses:

.....

FORM 985 M. C. MILLER CO. - MILWAUKEE

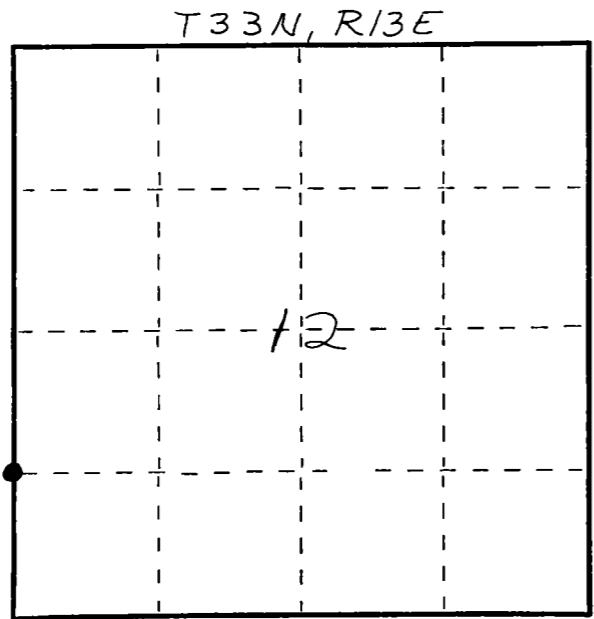

○ = Corner monument restored.

History of original corner establishment:
 ORIGINAL CORNER ESTABLISHED
 BY JAMES L NOWLIN IN 1865.

Description of corner evidence found:
 CORNER SET AT MID POINT
 BETWEEN W 1/4 CORNER
 AND SW CORNER SECT 12
 T 33 N R 13 E



William F. Kelly

Description of monument and accessories I established to perpetuate the original location of this corner.

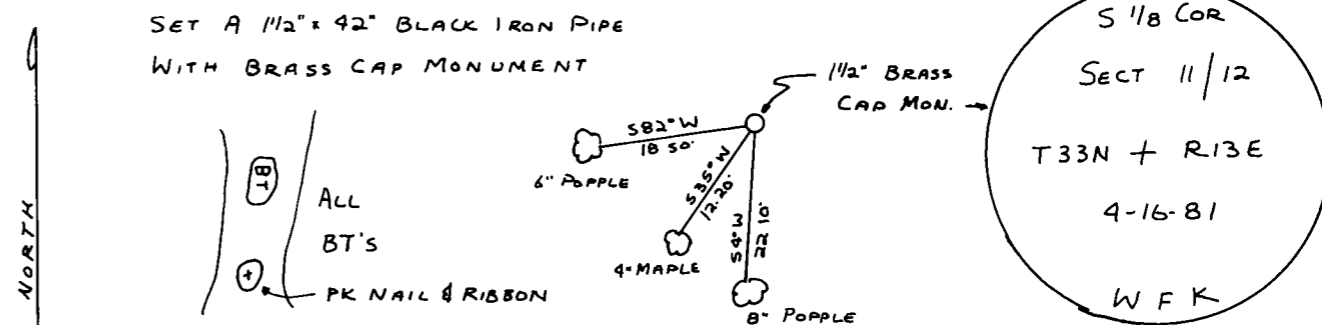

Dated at ELCHO, Wis., this 16th day of APRIL, 19 81.

Signature William F. Kelly Title COUNTY SURVEYOR Registration No. 1098
 (County Surveyor, Registered Land Surveyor, or other duly authorized official)

Office of Register of Deeds, County of _____, I hereby certify that the within instrument was filed in this office for record on the _____ day of _____, 19 _____ at _____ o'clock _____ M.

(Register of Deeds)

By _____ Deputy