

LANGLADE COUNTY U.S. PUBLIC LAND CORNER RESTORATION

The quarter corner common to Sections 19 & 20, T. 33 N., R. 13 E., Langlade County, WI.

- Corner was: (check all that apply)
- Restored through acceptance of an obliterated evidence location.
 - Restored through acceptance of a found perpetuated location.
 - Determined to be lost and re-established through proportionate methods.
 - Show bearings and distances to PLSS corners used for proportioning, and show original distances).
 - Restored/recovered/re-established in a location that differs from a previously established position.
 - Check here if additional information is shown on the reverse side of this form.

4331319 2000 2019

Describe record evidence, recovered physical evidence, occupational evidence, testimonial evidence and all other evidence considered in the recovery/restoration of the corner.

The original corner was established in 1865 by James Nowlin. Original bearing trees: sugar, 15", S66E, 75 lks and a sugar, 8", N66W, 30 links. In 1977, Ray Hallisy found a 1" axle that he said was set by Hutchinson in 1928. He replaced the axle with a 2" iron pipe with brass cap and marked three new BT's (1 white pine and 2 hemlocks). On Nov. 30, 2016, Luke Williams and I found Hallisy's pipe and his hemlocks green and his pine now a snag. Left existing monument in place and measured references as shown below.

Physical description of the monument set:

I found the existing monument in good condition and left it as found.
I set a 6' steel channel post with sign, 0.65 ft west of corner monument.

Describe the accessories used to perpetuate the corner. Include a plan view drawing and accessories found/set. Describe measuring point on bearing trees. Show any topographic features that would aid in future recovery of the corner.

Langlade County Coordinates NAD83(2011)
 Northing(Y) Easting(X) Description
 408538.92 683722.61 3x rt ave 2"ipbc 1/4cor

LEGEND

- 2" iron pipe with brass cap found

Trees measured to an aluminum nail in the side of the tree shown T. Bearing trees painted blue and have Bearing Tree sign facing the corner.

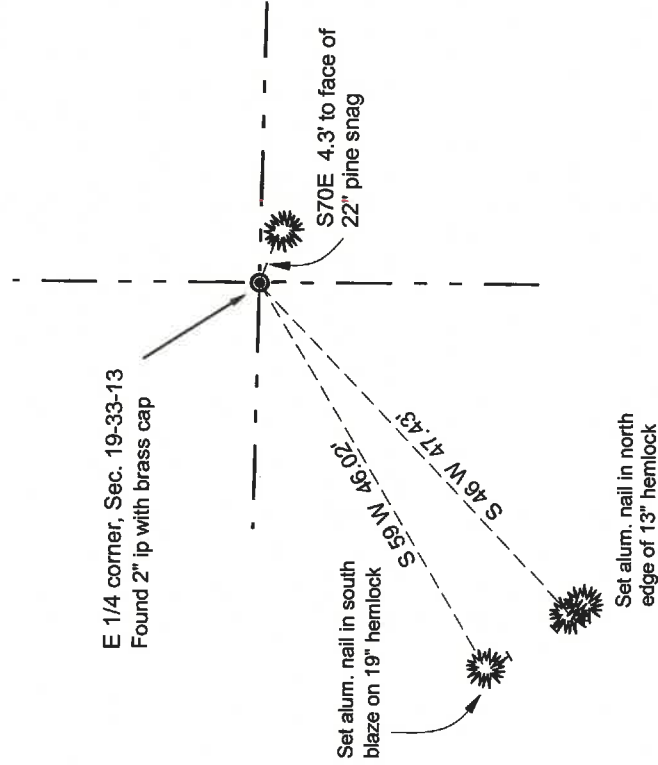

FB 21-116

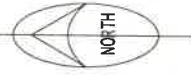

David E. Tlusty
 12/17/19



Index No. P 5 33-13

O = corner perpetuated
 The East 1/4 corner
 of Section 19,
 T. 33 N., R. 13 E.,
 Langlade County, WI

I, David E. Tlusty, Registered Land Surveyor, as Langlade County Surveyor, certify that the corner location on this record was determined by me and that this U.S. Public Land Survey Monument Record is correct to the best of my knowledge and belief.

PLSS field condition report

Date: 4-22-20 Time of day: 9:00 am

By: Cory Burkhead

Section 19 Town 33N Range 13E
(circle corner location on diagram)

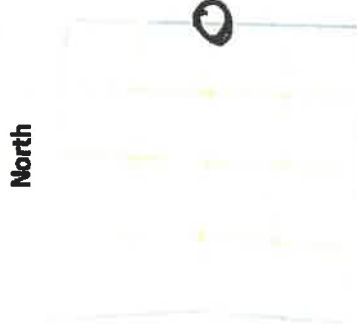

Does the monument appear to be tilted, smashed, uprooted, covered or otherwise damaged by the windstorm?
YES NO

Are any bearing trees broken, uprooted, missing or otherwise damaged by the windstorm? YES NO

4331319 2000

TAKE PICTURES

For the first four pictures, do them in this order:

Looking north, looking east, looking south, looking west and, by standing about 6 feet behind the monument, include the monument in each picture.

Then take a picture of the top of the monument, close enough to be able to read what is stamped on the cap. Make sure all pictures are in focus.

P 5' 33-13

CERTIFIED LAND CORNER RESTORATION

Index No. P-5
33-13

State of Wisconsin }
County of Lanlade } ss.

I Raymond J. Hallisy, do hereby certify that on the 21st day of April, 1979, I found evidence of the EAST 1/4 corner of 19 Township 33, North, Range 13 EAST, Fourth Principal Meridian, as described hereon; and that from this evidence I established a new monument and accessories as described hereon to perpetuate the original location of this corner.

Resident witnesses:
.....
.....
.....

History of original corner establishment:
CORNER REESTABLISHED in 1928 BY M. HUTCHINSON
County Surveyor

Description of corner evidence found:
1" Axle for corner
4"x4" scribed cedar post 10" south of axle
old B.T.
Pine stump 558W 11'3"

Description of monument and accessories I established to perpetuate the original location of this corner.
Set 2" IRON PIPE WITH BRASS CAP IN PLACE OF AXLE
New B.T.'s
White pine 22" S75E 4'3"
Hemlock 14" S41W 47'6"
Hemlock 14" S45W 45'9"

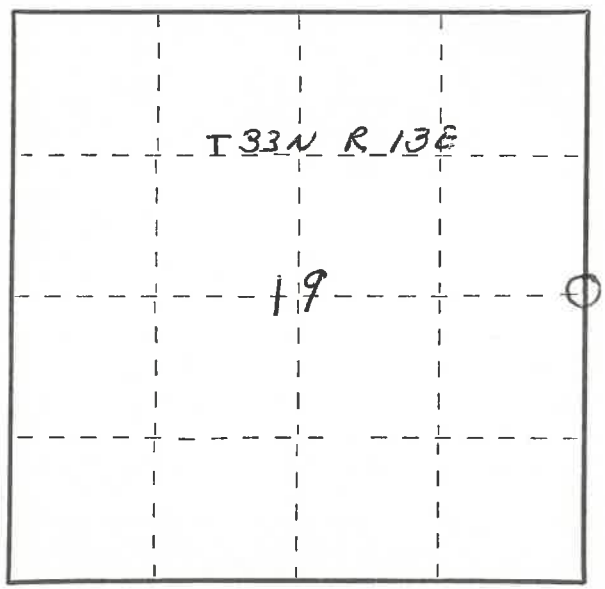
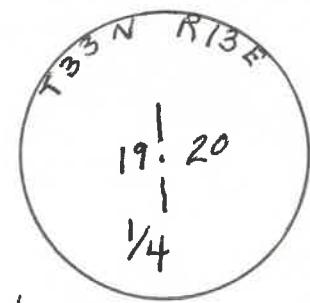

○ = Corner monument restored.

Dated at Antigo, Wis., this 21st day of April, 1979.

Signature Raymond J. Hallisy Title Reg Land Surveyor Registration No. 5685
(County Surveyor, Registered Land Surveyor, or other duly authorized official)

Office of Register of Deeds, County of _____, I hereby certify that the within instrument was filed in this office for record on the _____ day of _____, 19____ at _____ o'clock _____ M.

.....
(Register of Deeds)
By.....Deputy

FORM 985 H. C. MILLER CO., MILWAUKEE