

CERTIFIED LAND CORNER RESTORATION

State of Wisconsin }  
County of Langlade } ss.

I Raymond J. Hallisy, do hereby certify that on the 9th day of May 19 81, I found evidence of the Center 1/4 corner of Section 19 Township 33, North, Range 13E, Fourth Principal Meridian, as described hereon; and that from this evidence I established a new monument and accessories as described hereon to perpetuate the original location of this corner.

Resident witnesses:

.....  
.....  
.....

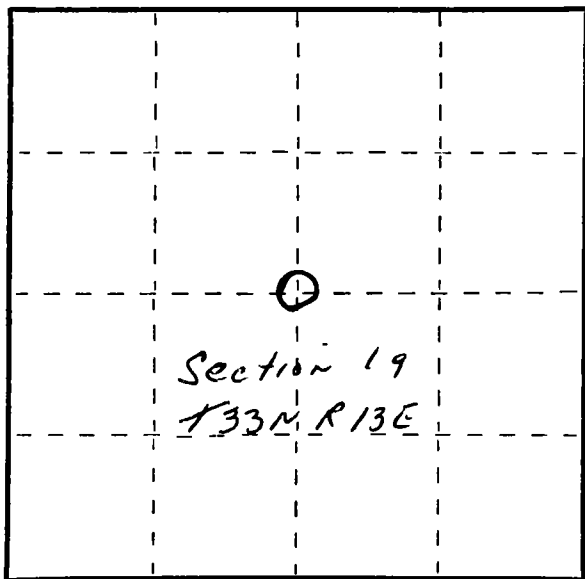

○ = Corner monument restored.

History of original corner establishment:

Corner set by M. Hutchinson in the 1920's

Description of corner evidence found:

Found scribed wood post, Marked 1/4S, His BT's are stumps.

Description of monument and accessories I established to perpetuate the original location of this corner.

Set 2" iron pipe with brass cap.

New BT's

- 16" Hemlock N29W 10'4"
- 18" Hemlock S66W 24'1"
- 12" Hemlock S3E 19'6"

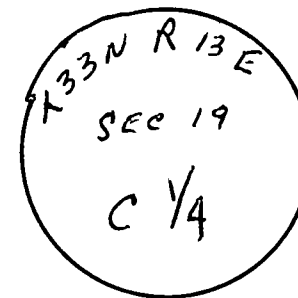

Dated at Antigo, Wis., this 9th day of May, 19 81

Signature Raymond J. Hallisy Title Reg. Land Surveyor Registration No. S-685  
(County Surveyor, Registered Land Surveyor, or other duly authorized official)

Office of Register of Deeds, County of....., I hereby certify that the within instrument was filed in this office for record on the..... day of....., 19..... at..... o'clock..... M.

.....  
(Register of Deeds)

By..... Deputy