

CERTIFIED LAND CORNER RESTORATION

33-13

Index No. W-7

State of Wisconsin }  
County of Langlade } ss.

I Raymond J. Hallisy do hereby  
certify that on the 3rd day  
of July, 19 71, I found  
evidence of the NORTH CENTER 1/4  
corner of SECTION 32  
Township 33, North, Range  
13 EAST, Fourth, Principal Meridian,  
as described hereon; and that from this evidence  
I established a new monument and accessories  
as described hereon to perpetuate the original  
location of this corner.

Resident witnesses:  
\_\_\_\_\_  
\_\_\_\_\_  
\_\_\_\_\_

History of original corner establishment:

OWENS - ILLINOIS SURVEY

Description of corner evidence found:

1" IRON PIPE  
OID BT  
HEMLOCK 18" N33E 21.9 FT

Description of monument and accessories I established to perpetuate the original location of this corner.

SET 2" PIPE WITH BRASS CAP ROCK MOUND  
NEW BT  
WHITE BIRCH 8" N44W 22.5 FT  
HEMLOCK 18" N33E 21.9 FT

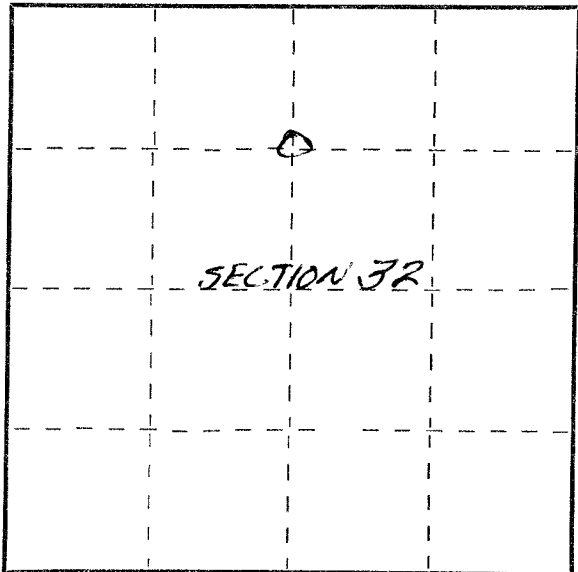
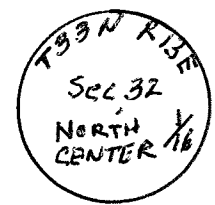

○ = Corner monument restored.

Dated at Antigo, Wis., this 3rd day of July, 19 71

Signature R. J. Hallisy Title Reg. Land Surveyor Registration No. 685  
(County Surveyor, Registered Land Surveyor, or other duly authorized official)

Office of Register of Deeds, County of \_\_\_\_\_, I hereby certify that the within  
instrument was filed in this office for record on the \_\_\_\_\_ day of \_\_\_\_\_, 19\_\_\_\_  
at \_\_\_\_\_ o'clock \_\_\_\_\_ M.

\_\_\_\_\_  
(Register of Deeds)  
By \_\_\_\_\_ Deputy

FORM 985 H. C. MILLER CO., MILWAUKEE