

CERTIFIED LAND CORNER RESTORATION

Index No. E-8

State of Wisconsin }
 County of Lancaster } ss.

I, Raymond J. Hallisy, do hereby certify that on the 2nd day of May, 1981, I found evidence of the E 1/8 corner of Section 5 & 8 Township 34, North, Range 9E, Fourth Principal Meridian, as described hereon; and that from this evidence I established a new monument and accessories as described hereon to perpetuate the original location of this corner.

Resident witnesses:

.....

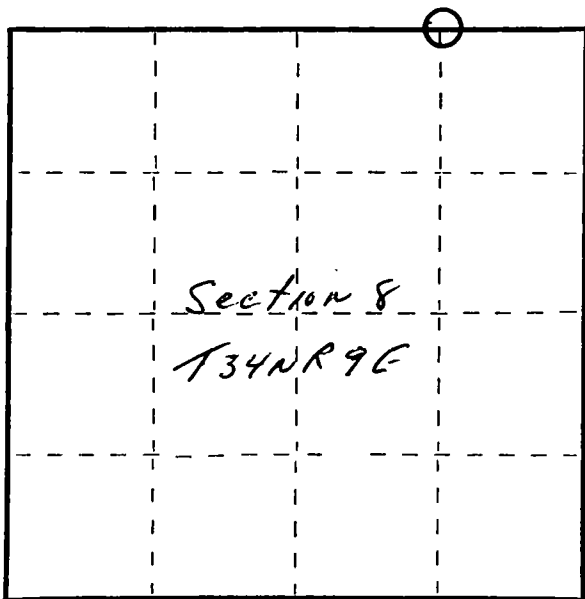

○ = Corner monument restored.

History of original corner establishment:

Corner set in the 1930 resurvey.

Description of corner evidence found:

Found ~~12~~ squared wood post down, point intact, marks plain.

Description of monument and accessories I established to perpetuate the original location of this corner.

Set $1\frac{1}{2}$ " iron pipe with brass cap.

New BT's

8"	Hard Maple	S40E	1'4"
8"	Hard Maple	S75W	9'8"
7"	Hard Maple	N45E	10'7"

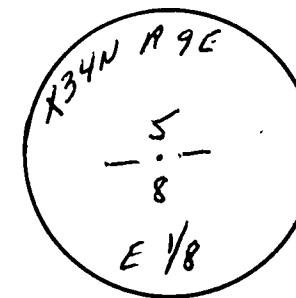

Dated at Antigo, Wis., this 2nd day of May, 1981

Signature Raymond J. Hallisy Title Reg. Land Surveyor Registration No. S-685
 (County Surveyor, Registered Land Surveyor, or other duly authorized official)

Office of Register of Deeds, County of Lancaster, I hereby certify that the within instrument was filed in this office for record on the 2nd day of May, 1981 at 10 o'clock AM.

.....
 (Register of Deeds)

By..... Deputy