

LANGLADE COUNTY U.S. PUBLIC LAND CORNER RESTORATION

The South Quarter corner of Section 9, T. 34 N., R. 9 E., Langlade County, WI.

Corner was: (check all that apply)

- Restored through acceptance of an obliterated evidence location.
- Restored through acceptance of a found perpetuated location.
- Determined to be lost and re-established through proportionate methods.
- Show bearings and distances to PLSS corners used for proportioning, and show original distances).
(Show difference in plan view below).
- Restored/recovered/re-established in a location that differs from a previously established position.
- Check here if additional information is shown on the reverse side of this form.

4340909 0020

Describe record evidence, recovered physical evidence, occupational evidence, testimonial evidence and all other evidence considered in the recovery/restoration of the corner.

The original corner was established in 1864 by James L. Nowlin. Original bearing trees: hemlock, 8", S36E, 16 links and a hemlock, 8", N41E, 18 links. In 1936 during the resurvey of this township by Kilroe & Hintz, they stated: "to 1/4 cor. Not org. but excepted by U.S. Land Commission Pratt va P.R.S.C." and noted bearing trees: hemlock, 7", N30E, 24; tam, 18", S52 1/2E, 40 1/2; New hem. 10", S82E, 59 and a birch, 18", N27W, 47.01. In 1980, Ray Hallisy found a 4" pipe with brass cap. He also found the 1936 tamarack (stump) and birch BT. He marked new BT's: tam., 10", S48E, 14'7"; spruce, 8", N68E, 16'7" and a red maple, 6", N32W, 18' 9". On May 21, 2016, D. Tlusty and Cody Brauner found Hallisy's NE spruce standing dead, then found the 4" pipe with brass cap, frost heaved and horizontal in swamp and also found scribing on tamarac stump, S40E, 15 feet. Found the monument hole at the base of the heaved monument. I accepted this evidence as the location of the quarter corner and in said monument hole, I set a 1" dia. x 42" long, barbed bottom aluminum monument with aluminum cap, flush with swamp. Set and marked references as shown below.

Physical description of the monument set:

Replaced the found 1936 monument with the aluminum monument described above.
Set a white vinyl sign post at the north edge of the new monument.

Describe the accessories used to perpetuate the corner. Include a plan view drawing and accessories found/set. Describe measuring point on bearing trees. Show any topographic features that would aid in future recovery of the corner.

Bearings magnetic with hand compass.
Trees are blazed, painted blue and have "Bearing Tree" signs attached. Tree ties are measured to an aluminum nail in a low blaze on the side of the tree shown as:

S 1/4 corner, Sec. 9-34-09
Found iron pipe w/brass cap, and replaced it with alum. mon. described above.

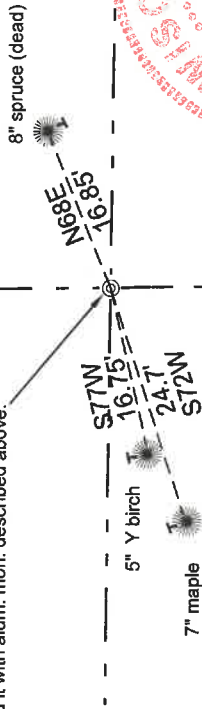

| Langlade County coordinates NAD83(2011) | North(Y) | Easting(X) | Description |
|---|------------|------------|-------------------|
| 448960.513 | 563823.142 | ALMONSET | 3XRTKAVE:06212016 |

Field book 28-19



Index No. J11 34-09

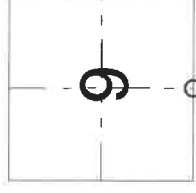

O = corner perpetuated
The South Quarter
corner of Section 9,
T. 34 N., R. 9 E.,
Langlade County, WI



I, David E. Tlusty, Registered Land Surveyor, as Langlade County Surveyor, certify that the corner location on this record was determined by me and that this U.S. Public Land Survey Monument Record is correct to the best of my knowledge and belief.