

CERTIFIED LAND CORNER RESTORATION

State of Wisconsin }
County of Lanlade } ss.

History of original corner establishment:

Corner set in the 1930 resurvey

I Raymond J. Hallisy, do hereby certify that on the 14th day of June, 19 69, I found evidence of the S 1/16 corner of Sec 15 Township 34, North, Range 9E, Fourth Principal Meridian, as described hereon; and that from this evidence I established a new monument and accessories as described hereon to perpetuate the original location of this corner.

Description of corner evidence found:

**Found squared post in place, marked 1/8S
B.T. Hemlock 14" N65W 21.21 Lks.**

Resident witnesses:

.....
.....
.....

Description of monument and accessories I established to perpetuate the original location of this corner.

**Reset 2" pipe with brass cap, rock mound
B.T.'s to corner
Red Maple 8" S54W 31 Ft. 4 inches
Y. Birch 19" N21W 3 Ft. 10 inches
B.T.'s faced at base and scribed BT**

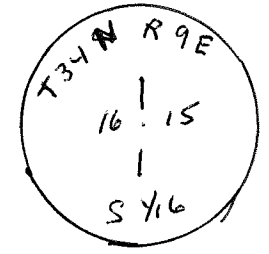

4340916 1000 1969

FORM 985 H. C. MILLER CO., MILWAUKEE

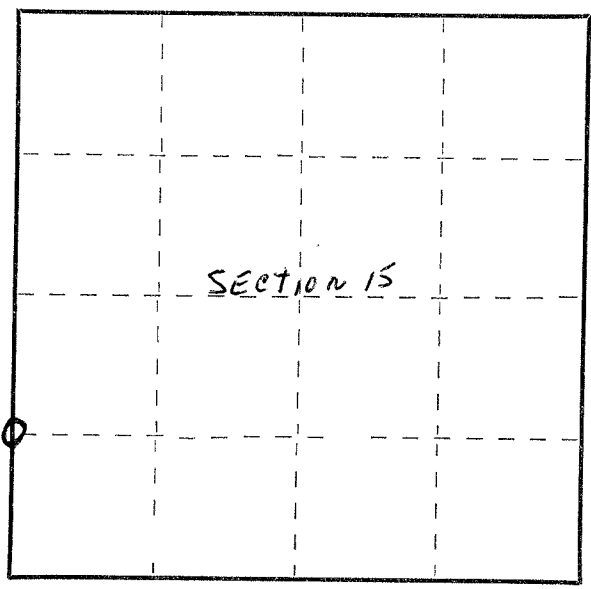

○ = Corner monument restored.

Dated at Antigo, Wis., this 14th day of June, 19 69

Signature Raymond J. Hallisy Title Reg. Land Surveyor Registration No. S-685
(County Surveyor, Registered Land Surveyor, or other duly authorized official)

Office of Register of Deeds, County of Lanlade, I hereby certify that the within instrument was filed in this office for record on the 14th day of June, 19 69 at 10 o'clock AM.

.....
(Register of Deeds)

By.....Deputy