

CERTIFIED LAND CORNER RESTORATION

Index No. R-2

State of Wisconsin }
 County of LANGLADE } ss.

I, WILLIAM F. KELLY, do hereby certify that on the 28TH day of DECEMBER, 1976, I found evidence of the 5/4 corner of SECTION 20 Township 34, North, Range 9E, Fourth Principal Meridian, as described hereon; and that from this evidence I established a new monument and accessories as described hereon to perpetuate the original location of this corner.

Resident witnesses:

.....

FORM 985 H. C. MILLER CO., MILWAUKEE

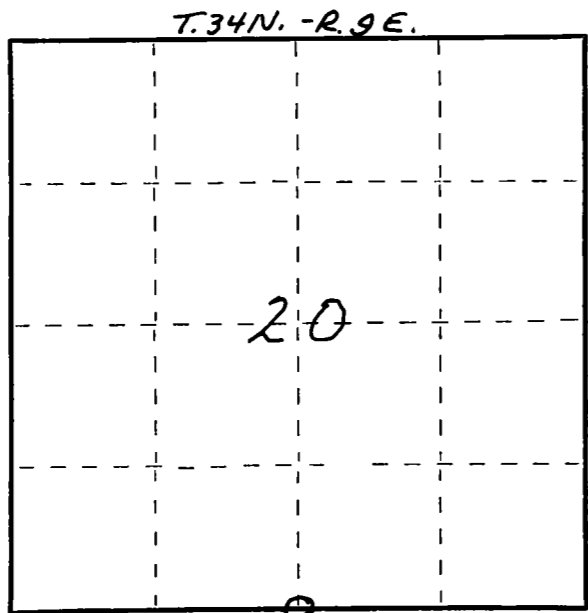

○ = Corner monument restored.

History of original corner establishment:

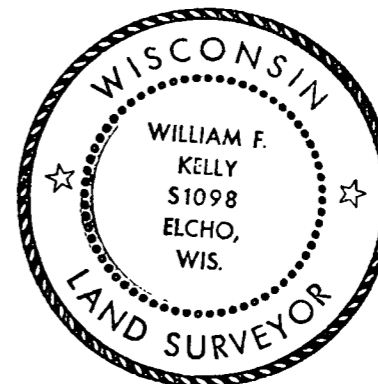

William F. Kelly 12-28-76

Description of corner evidence found:
4" IRON PIPE WITH BRASS CAP. SET ON RESURVEY BY T. KILROE AND D. HINTZ IN 1937.

Description of monument and accessories I established to perpetuate the original location of this corner.
4" IRON PIPE WITH BRASS CAP SET IN CONCRETE
 MARKED:

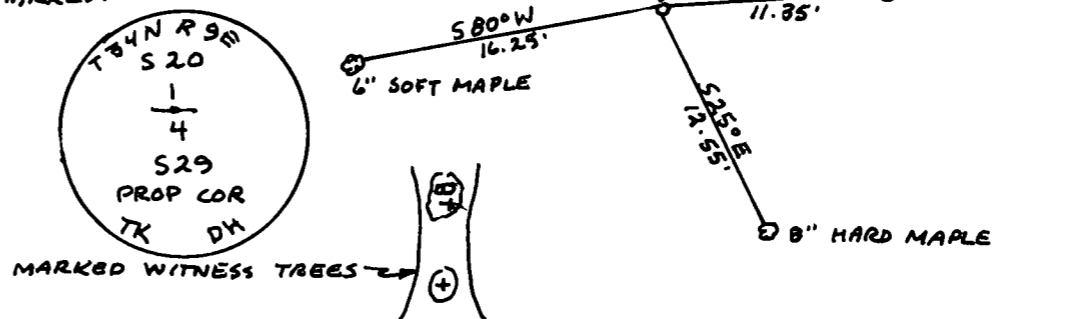

Dated at ELCHO, Wis., this 28TH day of DECEMBER, 1976.

Signature William F. Kelly Title REGISTERED LAND SURVEYOR Registration No. 51098
 (County Surveyor, Registered Land Surveyor, or other duly authorized official)

Office of Register of Deeds, County of....., I hereby certify that the within instrument was filed in this office for record on the..... day of....., 19..... at..... o'clock..... M.

.....
 (Register of Deeds)

By..... Deputy