

CERTIFIED LAND CORNER RESTORATION

34-9

Index No. R-6

State of Wisconsin }
County of Langlade } ss.

I Raymond J. Hallisy, do hereby certify that on the 5th day of October, 1969, I found evidence of the W 1/16 corner of Section 29 Township T34, North, Range 9E, Fourth, Principal Meridian, as described hercon; and that from this evidence I established a new monument and accessories as described hereon to perpetuate the original location of this corner.

Resident witnesses:

FORM 985 H. C. MILLER CO., MILWAUKEE

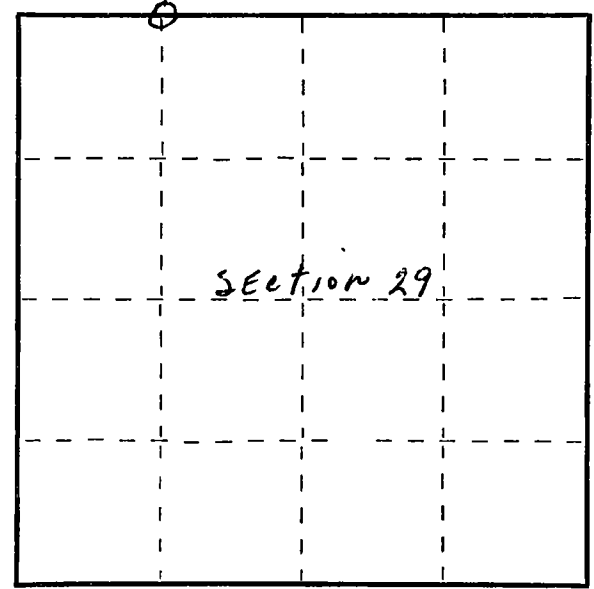

○ = Corner monument restored.

History of original corner establishment:

Corner set in the 1930 resurvey

Description of corner evidence found:

Found old wood post standing marked 1/8

Description of monument and accessories I established to perpetuate the original location of this corner.

Set 2" pipe with brass cap
B.T.'s to corner
Black Ash 7" S56W 7 Ft
Black Ash 5" N90E 8 Ft 3 inches
B.T.'S faced at base of tree and scribed BT



Dated at Antigo, Wis., this 5th day of October, 1969.

Signature Raymond J. Hallisy Title Reg. Land Surveyor Registration No. S-685
(County Surveyor, Registered Land Surveyor, or other duly authorized official)

Office of Register of Deeds, County of _____, I hereby certify that the within instrument was filed in this office for record on the _____ day of _____, 19____ at _____ o'clock _____ M.

(Register of Deeds)

By _____ Deputy