

CERTIFIED LAND CORNER RESTORATION

Index No. Z-19

State of Wisconsin }
County of LANGLADE } ss.

I WILLIAM F. KELLY, do hereby certify that on the 17th day of DEC, 1981, I found evidence of the S. 1/4 corner of SEC 35 Township 34, North, Range 9 E, Fourth Principal Meridian, as described hereon; and that from this evidence I established a new monument and accessories as described hereon to perpetuate the original location of this corner.

Resident witnesses:

.....
.....
.....

FORM 985 M. C. MILLER CO., MILWAUKEE

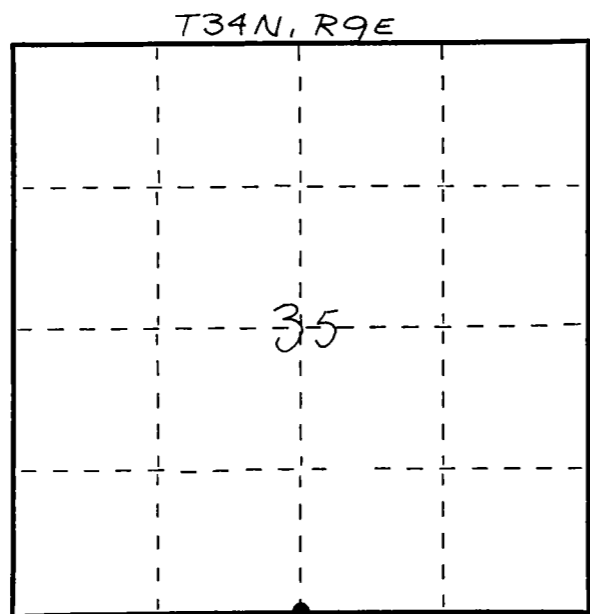

○ = Corner monument restored.

History of original corner establishment:

ORIGINAL CORNER ESTABLISHED BY
JAMES L NOWLIN IN SEPT-OCT, 1864.

MONUMENT EST. BY CCC
RE SURVEY IN 1937

Description of corner evidence found:

4" BRASS CAP MONUMENT, FOUND IN PLACE.

LOCATION TAG SIGNED BY: S.E. BANISH > 1/20/58
J.R. SPOERKE

J. WEIX > 6/7/67
J. KRYKA

MARKED 3 BT'S.

Description of monument and accessories I established to perpetuate the original location of this corner.

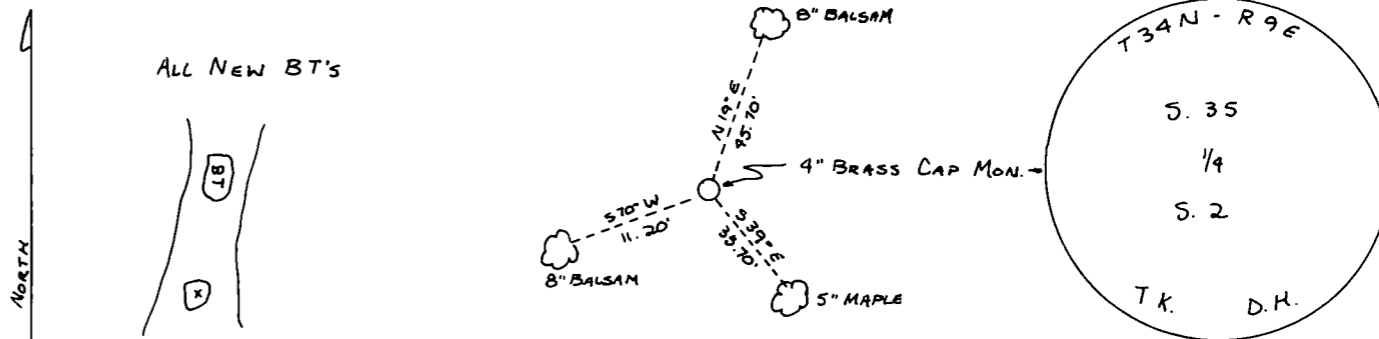

Dated at ELCHO, Wis., this 17th day of DEC, 1981.

Signature William F. Kelly Title COUNTY SURVEYOR Registration No. 1098
(County Surveyor, Registered Land Surveyor, or other duly authorized official)

Office of Register of Deeds, County of _____, I hereby certify that the within instrument was filed in this office for record on the _____ day of _____, 19____ at _____ o'clock _____ M.

.....
(Register of Deeds)

By..... Deputy

