

CERTIFIED LAND CORNER RESTORATION

Index No. C-25

State of Wisconsin }
County of LANGLADE } ss.

History of original corner establishment:

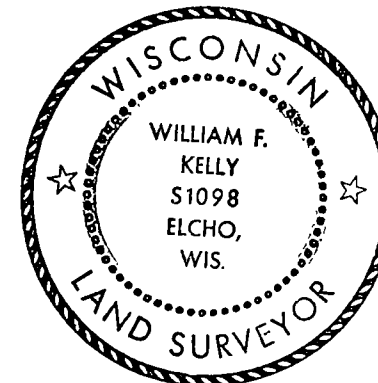

William F. Kelly 12-20-76

I WILLIAM F. KELLY, do hereby certify that on the 20TH day of DECEMBER, 1976, I found evidence of the E 1/4 COR corner of SECTIONS 1 & 6 Township 34, North, Range 10 E, Fourth Principal Meridian, as described hereon; and that from this evidence I established a new monument and accessories as described hereon to perpetuate the original location of this corner.

Description of corner evidence found:
FOUND BRASS CAP SET ON SURVEY IN 1937.

Resident witnesses:

E. GOEPFERT

S. RUSTIC

Description of monument and accessories I established to perpetuate the original location of this corner.
MARKED WITNESS TREES.

FORM 985 H. C. MILLER CO., MILWAUKEE

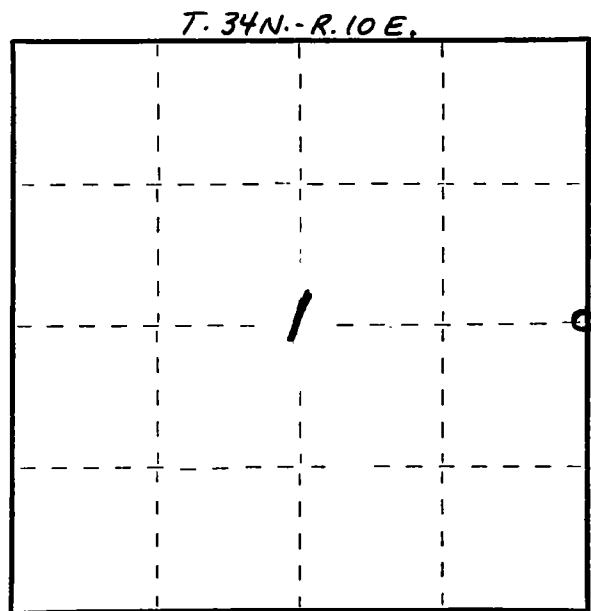

○ = Corner monument restored.

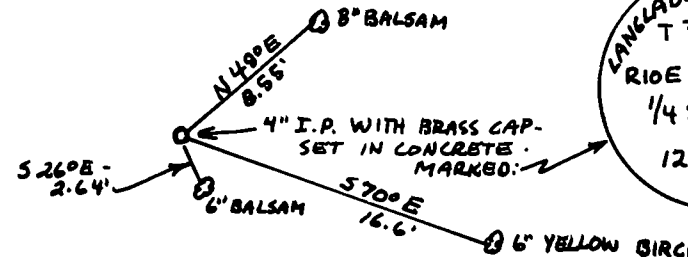
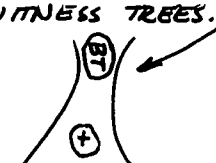

Dated at ELCHO, Wis., this 20TH day of DECEMBER, 1976.

Signature William F. Kelly Title REGISTERED LAND SURVEYOR Registration No. S1098
(County Surveyor, Registered Land Surveyor, or other duly authorized official)

Office of Register of Deeds, County of _____, I hereby certify that the within instrument was filed in this office for record on the _____ day of _____, 19____ at _____ o'clock _____ M.

(Register of Deeds)

By _____ Deputy