

CERTIFIED LAND CORNER RESTORATION

34-10
Index No. J-2

State of Wisconsin }
County of Langlade } ss.

History of original corner establishment:

I, Raymond J. Hallisy, do hereby certify that on the 11th day of June, 1968, I found evidence of the W 1/16 corner of Section 18 Township 34, North, Range 10, Fourth, Principal Meridian, as described hereon; and that from this evidence I established a new monument and accessories as described hereon to perpetuate the original location of this corner.

Corner set in the 1930's by: C. W. Borth
E. F. Kowalke
D. A. Hintz

Description of corner evidence found:

Found squared stake and 1" pipe along side, Y Birch BT N50E 30.8Lks
Stake marked W 1/16 S7 S18

Resident witnesses:

.....
.....
.....

Description of monument and accessories I established to perpetuate the original location of this corner.

Set Std. 1 1/2" pipe with cap marked 7 18 W 1/16

BASS LK. Rd

FORM 983 H. C. MILLER CO., MILWAUKEE

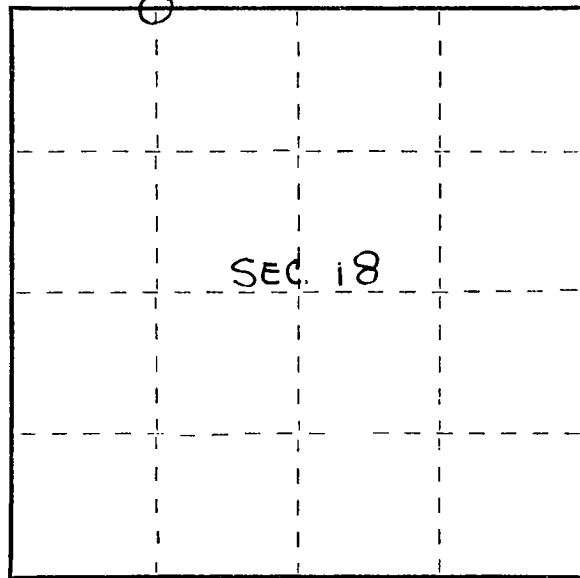

BLACK ASH SCRIBED BT
N80°W 25' 7" → ○

IP

○ ← 7" ELM SCRIBED BT
N72°E 5' 4"

Dated at Antigo, Wis., this 11th day of June, 1968.

Signature Raymond J. Hallisy Title Reg. Land Surveyor Registration No. 5-685
(County Surveyor, Registered Land Surveyor, or other duly authorized official)

Office of Register of Deeds, County of _____, I hereby certify that the within instrument was filed in this office for record on the _____ day of _____, 19____ at _____ o'clock _____ M.

.....
(Register of Deeds)

By _____ Deputy

○ = Corner monument restored.