

CERTIFIED LAND CORNER RESTORATION

34-10

Index No. H-9

State of Wisconsin }  
County of Langlade } ss.

History of original corner establishment:

Corner set in the 1930's by: C. W. Borht  
E. F. Kowalke  
D. A. Hintz

I, Raymond J. Hallisy, do hereby certify that on the 10th day of June, 1968, I found evidence of the S 1/16 corner of Section 8 Township 34, North, Range 10, Fourth, Principal Meridian, as described hereon; and that from this evidence I established a new monument and accessories as described hereon to perpetuate the original location of this corner.

Description of corner evidence found:

~~XXXXXX~~  
Found squared stake standing, 4" cement stake 1 Ft. N.  
Marked S8 S9 S 1/16 Cor 50 LKS W.

Resident witnesses:

Description of monument and accessories I established to perpetuate the original location of this corner.  
Set Std. 1 1/2" pipe with cap marked W.C. C. 50 LKS W. S 1/16  
BT's to witness corner.

FORM 985 H. C. MILLER CO., MILWAUKEE

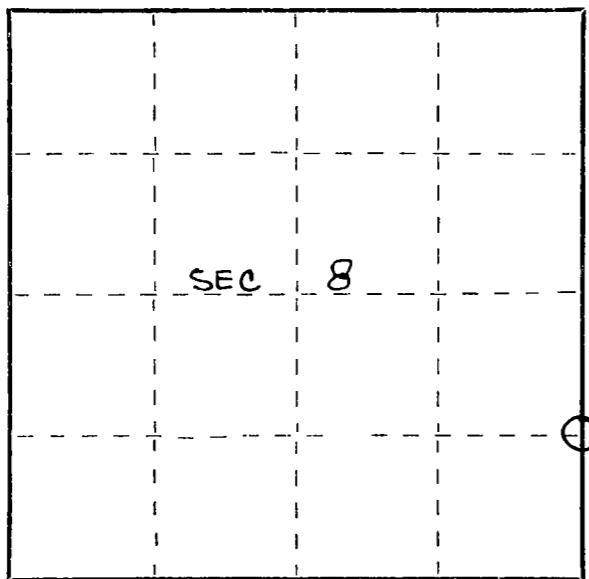

○ = Corner monument restored.

12" ELM SCRIBED BT  
N46°W 4' 3"  
9" ELM SCRIBED BT  
S8E 25' 10"

Dated at Antigo, Wis., this 10th day of June, 1968

Signature Raymond J. Hallisy Title Reg Land Surveyor Registration No. 1685  
(County Surveyor, Registered Land Surveyor, or other duly authorized official)

Office of Register of Deeds, County of \_\_\_\_\_, I hereby certify that the within instrument was filed in this office for record on the \_\_\_\_\_ day of \_\_\_\_\_, 19\_\_\_\_ at \_\_\_\_\_ o'clock \_\_\_\_\_ M.

(Register of Deeds)

By \_\_\_\_\_ Deputy