

CERTIFIED LAND CORNER RESTORATION

34-10
Index No. J-20

State of Wisconsin }
County of LANGLADE } ss.

I, ROBERT J. POSS, do hereby certify that on the 19TH day of JUNE, 1968, I found evidence of the EAST 1/8 corner of SECS 11 & 14 Township 34, North, Range 10 EAST, Fourth, Principal Meridian, as described hereon; and that from this evidence I established a new monument and accessories as described hereon to perpetuate the original location of this corner.

Resident witnesses:
.....
.....
.....

History of original corner establishment:

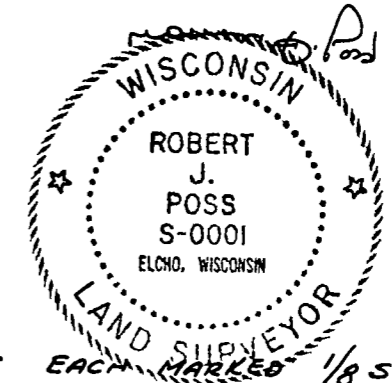

Description of corner evidence found:
FOUND 2 SQD STAKES EACH MARKED 1/8 S
ONE - 2RDS N OTHER 2RDS S.

Description of monument and accessories I established to perpetuate the original location of this corner.

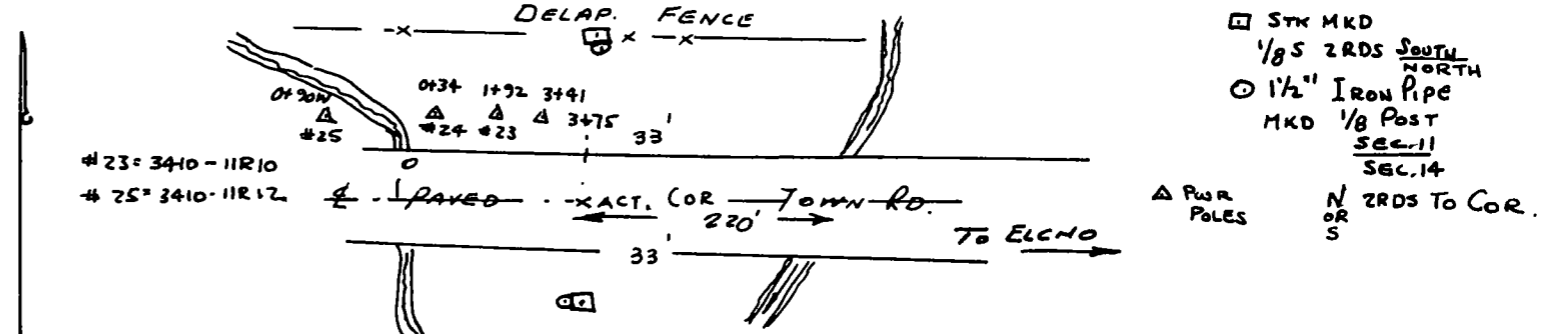
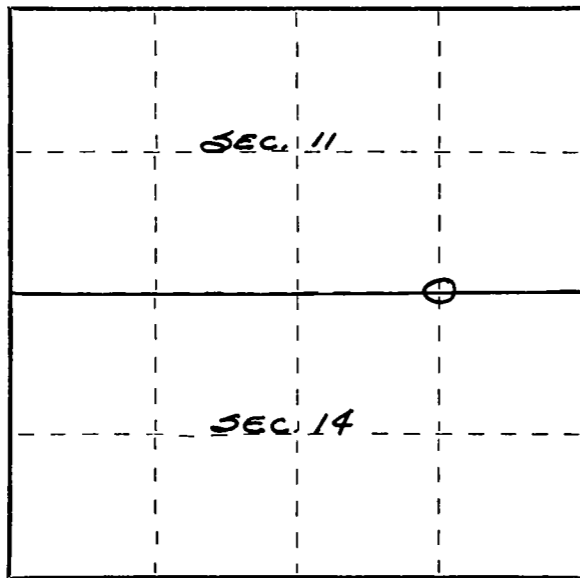

NO BEARINGS TAKEN
Dated at ELCHO, Wis., this 21ST day of JUNE, 1968.

Signature Robert J. Poss, Title REG. LAND SURVEYOR, Registration No. 5-1
(County Surveyor, Registered Land Surveyor, or other duly authorized official)

Office of Register of Deeds, County of....., I hereby certify that the within instrument was filed in this office for record on the..... day of....., 19..... at..... o'clock..... M.

.....
(Register of Deeds)
By..... Deputy

FORM 985 H. C. MILLER CO., MILWAUKEE

○ = Corner monument restored.