

CERTIFIED LAND CORNER RESTORATION

Index No. L-9

State of Wisconsin }  
County of LANGLADE } ss.

History of original corner establishment:

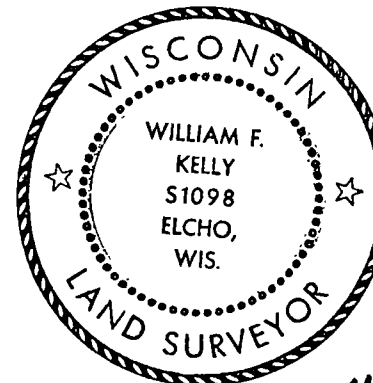

*William F. Kelly 12/17/76*

I WILLIAM F. KELLY, do hereby certify that on the 17TH day of DECEMBER, 1976, I found evidence of the 1/4 SECTION corner of SECTIONS 17 & 16 Township 34, North, Range 10E, Fourth Principal Meridian, as described hereon; and that from this evidence I established a new monument and accessories as described hereon to perpetuate the original location of this corner.

Description of corner evidence found:  
FOUND 4" IRON PIPE WITH BRASS CAP SET ON RESURVEY OF TWP. IN 1937.

Resident witnesses:

.....  
.....  
.....

Description of monument and accessories I established to perpetuate the original location of this corner.

MARKED WITNESS TREES:

BRASS CAP MARKED:

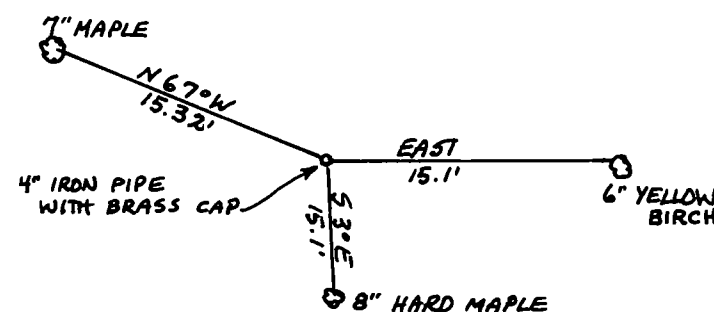
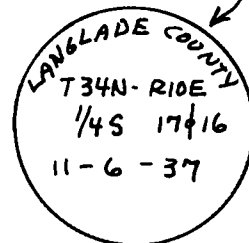

FORM 983 H. C. MILLER CO., MILWAUKEE

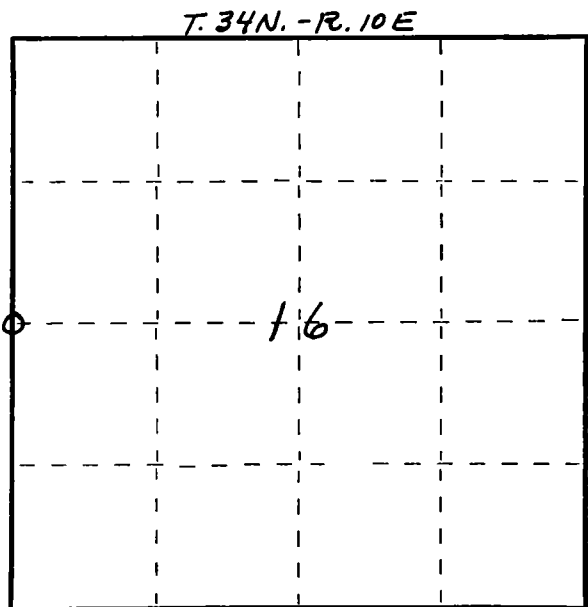

○ = Corner monument restored.

Dated at ELCHO, Wis., this 17TH day of DECEMBER, 1976

Signature William F. Kelly Title REGISTERED LAND SURVEYOR Registration No. 51098  
(County Surveyor, Registered Land Surveyor, or other duly authorized official)

Office of Register of Deeds, County of ....., I hereby certify that the within instrument was filed in this office for record on the ..... day of ....., 19..... at ..... o'clock ..... M.

.....  
(Register of Deeds)

By ..... Deputy