

CERTIFIED LAND CORNER RESTORATION

34-10

Index No. R-2

State of Wisconsin }
County of Langlade } ss.

History of original corner establishment:

Corner set in the 1930's by: C. W. Borth
E. F. Kowalke
D. A. Hintz

I, Raymond J. Hallisy, do hereby certify that on the 25th day of May, 1968, I found evidence of the W 1/16 corner of Section 30 Township 34, North, Range 16, Fourth, Principal Meridian, as described hereon; and that from this evidence I established a new monument and accessories as described hereon to perpetuate the original location of this corner.

Description of corner evidence found:

Found squared stake - badly decayed.
Stake marked - W 1/8 S19 S30

Resident witnesses:

.....
.....
.....

Description of monument and accessories I established to perpetuate the original location of this corner.

Set Std. 1 1/2" pipe with cap marked W 1/16

FORM 985 H. C. MILLER CO., MILWAUKEE

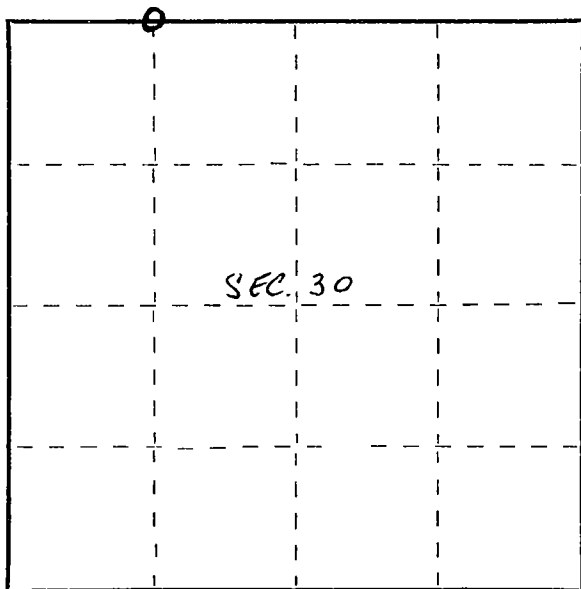

IP
O
8' ELM S 38° W 61' 6"
SERIBED BT
O

O 18" BASSWOOD E 90° 45' F.T.
SERIBED BT

Dated at Antigo, Wis., this 25th day of May, 1968

Signature Raymond J. Hallisy Title Reg. Land Surveyor Registration No. S-685
(County Surveyor, Registered Land Surveyor, or other duly authorized official)

Office of Register of Deeds, County of _____, I hereby certify that the within instrument was filed in this office for record on the _____ day of _____, 19____ at _____ o'clock _____ M.

.....
(Register of Deeds)

By..... Deputy

O = Corner monument restored.