

CERTIFIED LAND CORNER RESTORATION

Index No. P-9

State of Wisconsin }
County of LANGLADE } ss.

I RAYMOND J. HALLISY, do hereby certify that on the 28th day of MARCH, 1981, I found evidence of the EAST 1/4 corner of SECTION 20 Township 34, North, Range 10 EAST, Fourth Principal Meridian, as described hereon; and that from this evidence I established a new monument and accessories as described hereon to perpetuate the original location of this corner.

Resident witnesses:

.....
.....
.....

FORM 985 H. C. MILLER CO., MILWAUKEE

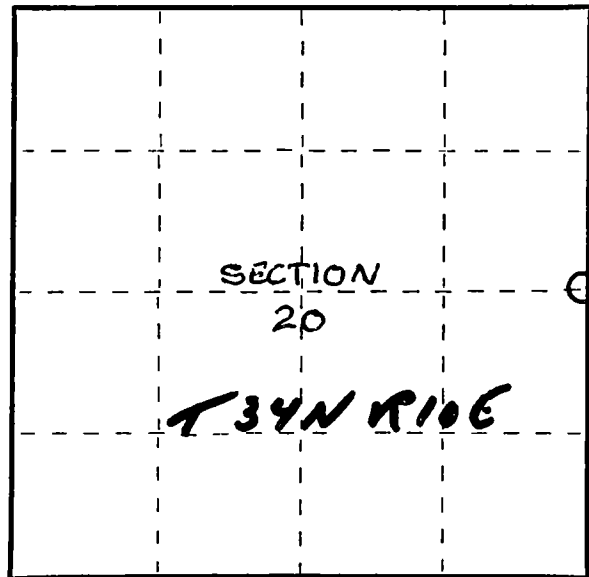

○ = Corner monument restored.

History of original corner establishment:

ESTABLISHED IN 1937 RESURVEY

Description of corner evidence found:

4 INCH IRON PIPE WITH BRASS CAP
OLD BT,S
12" TAM S62W 52 LKS

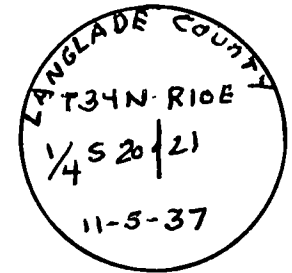

Description of monument and accessories I established to perpetuate the original location of this corner.

NEW BT,S
5" TAM N32E 9' 9"
5" SPRUCE N44W 20' 6"
5" TAM S80W 12' 9"

Dated at ANTIGO, Wis., this 28th day of MARCH, 1981.

Signature Raymond J. Hallisy Title Registered Land Surveyor Registration No. 5685
(County Surveyor, Registered Land Surveyor, or other duly authorized official)

Office of Register of Deeds, County of....., I hereby certify that the within instrument was filed in this office for record on the.....day of....., 19..... at.....o'clock..... M.

.....
(Register of Deeds)

By.....Deputy