

CERTIFIED LAND CORNER RESTORATION

34-10

Index No. R-14

State of Wisconsin }  
County of Lancaster } ss.

History of original corner establishment:

Corner set in the 1930 Resurvey

I Raymond J. Hallisy, do hereby certify that on the 28<sup>th</sup> day of October, 1972, I found evidence of the West 1/4 corner of Section 22 Township 34, North, Range 10 E, Fourth, Principal Meridian, as described hereon; and that from this evidence I established a new monument and accessories as described hereon to perpetuate the original location of this corner.

Description of corner evidence found:

Found corner standing in low ground blazed line to the north

Resident witnesses:

.....  
.....  
.....

Description of monument and accessories I established to perpetuate the original location of this corner.

Set 2" pipe with brass cap

New BT's

Hemlock 10" N83W 5FT 1 IN.

Hemlock 10" N65E 11FT 3 IN.

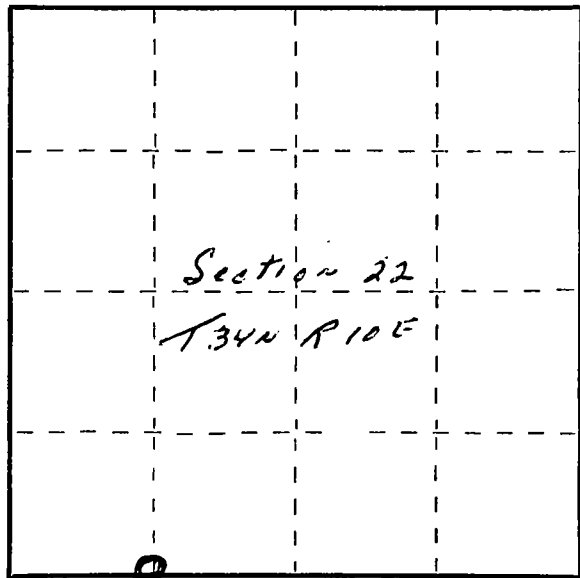
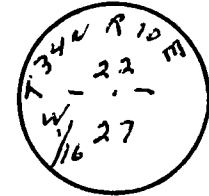

○ = Corner monument restored.

Dated at Antigo, Wis., this 28<sup>th</sup> day of October, 1972.

Signature Raymond J. Hallisy Title Reg. Land Surveyor Registration No. S685  
(County Surveyor, Registered Land Surveyor, or other duly authorized official)

Office of Register of Deeds, County of....., I hereby certify that the within instrument was filed in this office for record on the..... day of....., 19..... at..... o'clock..... M.

.....  
(Register of Deeds)

By..... Deputy