

CERTIFIED LAND CORNER RESTORATION

Index No. U-14

State of Wisconsin }  
County of Langlade } ss.

I Daniel K. Pleoger, do hereby certify that on the 12th day of August, 1980, I ~~found~~ established ~~at~~ the SW 1/16 corner of Section 27 Township 34, North, Range 10 East, Fourth Principal Meridian, as described hereon; and that from this evidence I established a new monument and accessories as described hereon to perpetuate the original location of this corner.

Resident witnesses:

.....  
.....  
.....

FORM 983 M. C. MILLER CO., MILWAUKEE

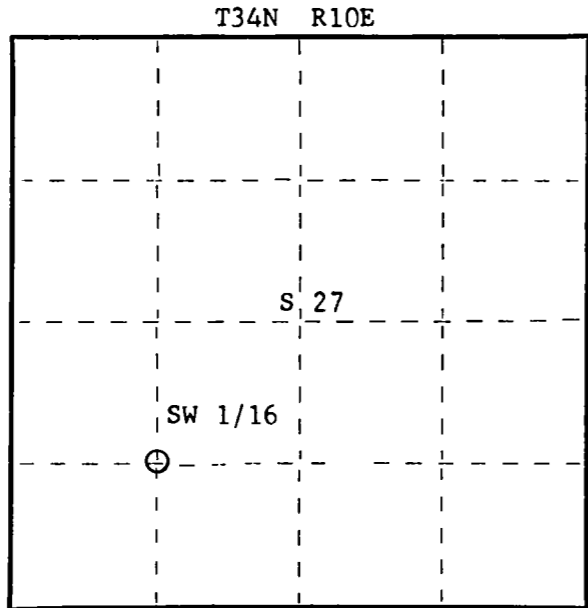

○ = Corner monument restored.

History of original corner establishment:  
No evidence of any previous corner.



Description of corner evidence found:

Corner established by subdivision of the SW 1/4 section 27.  
Computed location of SW 1/16 corner is N0-17-12W 1335.543 feet of W 1/16 corner between sections 27 and 34 and S0-17-12E 1335.55 feet of W.C. 1/16 section 27.

Description of monument and accessories I established to perpetuate the original location of this corner.  
Set a 1-1/2" I.D. iron pipe with screw-on brass cap - stamped:  
Monument projects 8" above ground.

Marked NBT's -  
Sugar 6" S68°E 7.25 feet  
Sugar 8" S59°W 2.60 feet  
Sugar 8" N19°W 19.68 feet  
scribed 1/16 BT.

T34N R10E  
SW 1/16 S 27  
S1537-1980

Dated at Rhineland, Wis., this 16th day of October, 1980

Signature Daniel K. Pleoger Title Registered Land Surveyor Registration No. 1537  
(County Surveyor, Registered Land Surveyor, or other duly authorized official)

Office of Register of Deeds, County of....., I hereby certify that the within instrument was filed in this office for record on the..... day of....., 19..... at..... o'clock..... M.

.....  
(Register of Deeds)

By..... Deputy