

CERTIFIED LAND CORNER RESTORATION

Index No. U-9

State of Wisconsin }
County of Langlade } ss.

I Glen Barker, do hereby certify that on the 11th day of November, 19 83, I ~~found~~ established S 1/16 corner of Sections 28 & 29 Township 34, North, Range 10 East, Fourth Principal Meridian, as described hereon; and that from this evidence I established a new monument and accessories as described hereon to perpetuate the original location of this corner.

Resident witnesses:

J. Clafin, Reg. Land ~~Surveyor~~

H. Wagoner

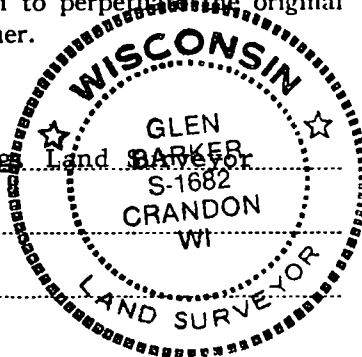

History of original corner establishment:

No evidence of any previous corner.

Description of corner evidence found:

Total distance from section corner 28-29-32-33 to 1/4 corner between sections 28 and 29 is 2766.84'.
Set S 1/16 1383.42 intermediate.

Description of monument and accessories I established to perpetuate the original location of this corner.

Set a 3/4" x 25" iron pipe on east edge of east-west logging road. Drove iron pipe 12" below ground.

Marked NBT's:

- Sugar 5" N45E 21.26'
 - Maple 7" N72W 36.40'
- scribed 1/16-B.T.

Stock No. 26272
FORM 985
H.C. Miller Company

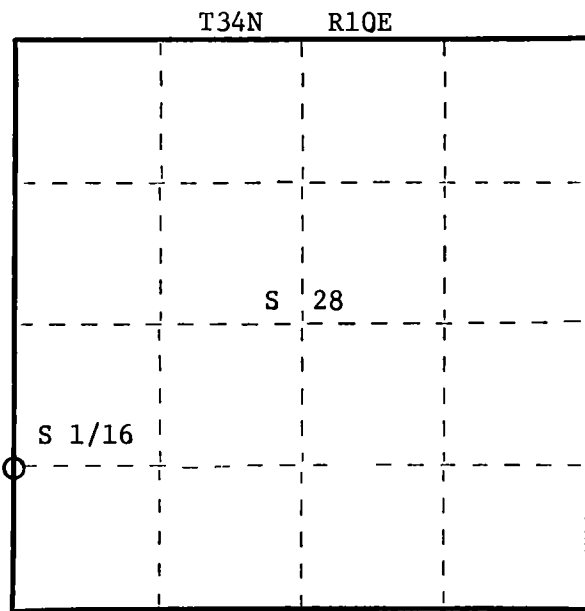

○ = Corner monument restored.

Dated at Rhineland, Wis., this 19th day of December, 19 83

Signature Glen Barker Title Registered Land Surveyor Registration No. S-1682
(County Surveyor, Registered Land Surveyor, or other duly authorized official)

Office of Register of Deeds, County of _____, I hereby certify that the within instrument was filed in this office for record on the _____ day of _____, 19 _____ at _____ o'clock _____ M.

(Register of Deeds)

By _____ Deputy