

CERTIFIED LAND CORNER RESTORATION

Index No. V-4

State of Wisconsin }  
County of Langlade } ss.

History of original corner establishment:

I Raymond J. Hallisy, do hereby certify that on the 8th day of April, 19 79, I found evidence of the E 1/16 corner of Section 30 & 31 Township 34, North, Range 10E, Fourth Principal Meridian, as described hereon; and that from this evidence I established a new monument and accessories as described hereon to perpetuate the original location of this corner.

Corner set in the 1930 resurvey.

Description of corner evidence found:

Found wood post down, point intact, marked S30 S31 1/16

Resident witnesses:

.....  
.....  
.....

Description of monument and accessories I established to perpetuate the original location of this corner.

Set 1 1/2" pipe with brass cap, rock mound  
New BT's

- 12" Hemlock S23F 17'
- 14" Yellow Birch N55E 8.9'
- 14" Cedar N39E 24.8'

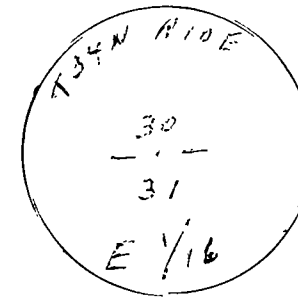

FORM 985 H. C. MILLER CO., MILWAUKEE

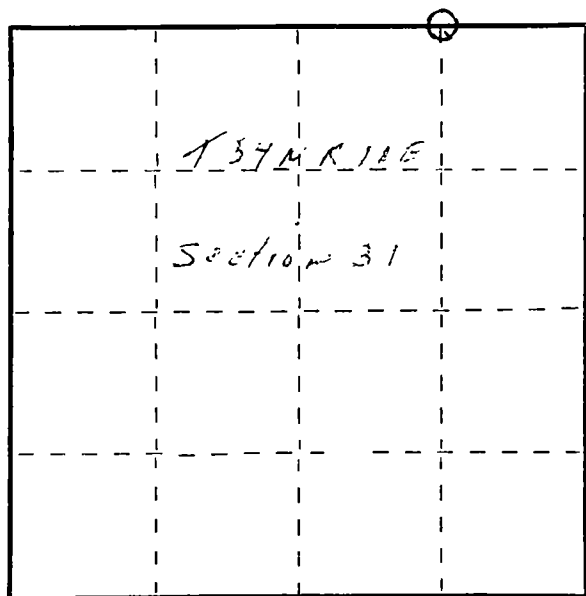

○ = Corner monument restored.

Dated at Antigo, Wis., this 8th day of April, 1979.

Signature Raymond J. Hallisy Title Reg. Surveyor Registration No. S-685  
(County Surveyor, Registered Land Surveyor, or other duly authorized official)

Office of Register of Deeds, County of \_\_\_\_\_, I hereby certify that the within instrument was filed in this office for record on the \_\_\_\_\_ day of \_\_\_\_\_, 19 \_\_\_\_\_ at \_\_\_\_\_ o'clock \_\_\_\_\_ M.

.....  
(Register of Deeds)

By \_\_\_\_\_ Deputy