

U. S. PUBLIC LAND SURVEY MONUMENT RECORD

INSTRUCTIONS: This record shall show the location of the corner and shall include all of the following nine elements (a through i).

(a) Identify the corner by reference to the U.S. public land survey system.

○ = Corner monument restored.

Section corner to Sections 5, 6, 31, and 32, T.33-34N., R.14E.

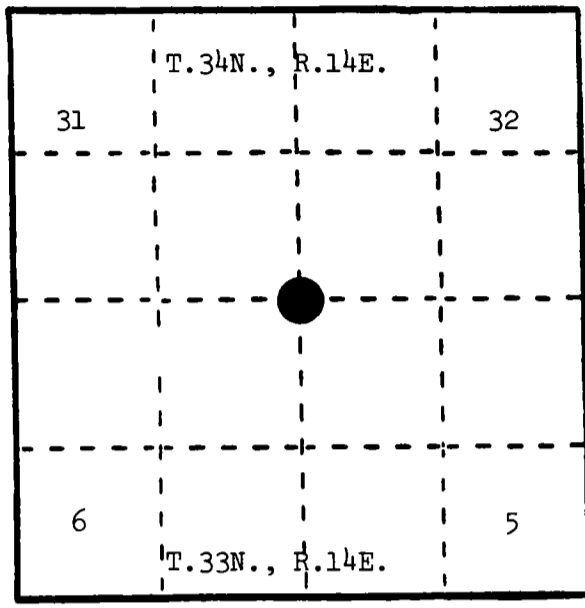

T. 33N, R. 14E.

(b) Describe any record evidence, monument evidence, occupational evidence, testimonial evidence or any other material evidence you considered, and whether the monument was found or placed.

In June, 1857, Alfred Millard set wood post and made the following BTs: Hemlock, 28", S.55°E., 40 links; Yellow Birch, 14", S.45°W., 48 links; Hemlock, 16", N.43°W., 38 links; Hemlock, 14", N.60°E., 58 links.

1962, Neal Spearhake set aluminum monument (Kimberly Clark) off scribed bearing tree-- see "e" on reverse side.

In April, 1984, Milo Stefan restored corner position from the remains of the original bearing tree stumps.

(c) In the plan view drawing below, provide reference ties to at least 4 witness monuments, or, if the location is within a municipality, to at least 2 witness monuments. (Witness monuments shall be made of concrete, natural stone, iron or other equally durable material.) Describe witness monuments.

(d) Show a plan view drawing depicting the relevant monuments and reference ties which is sufficient in detail to enable accurate relocation of the corner monument if the corner monument is disturbed. Indicate north.

1. Balsam, 8", N.36°E., 30.60 feet
2. Aspen, 6", S.70°E., 27.38 feet
3. Balsam, 3", S.13°W., 6.70 feet
4. Balsam, 7", N.30°W., 15.26 feet
5. Steel Sign Post, West, 1.87 feet
6. Kimberly Clark monument, S.37°E., 5.80 feet
7. 2" x 36" aluminum monument stamped to identify the corner.

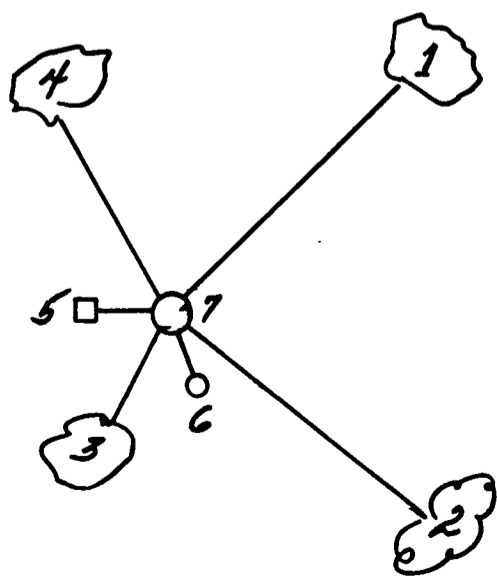

- (e) Describe any material discrepancy between the location of the corner as restored or reestablished and the location of that corner as previously restored or reestablished by distance and direction. Show the discrepancy on the plan view drawing under (d), above. Show the distances between the corner as previously restored or reestablished and (1) the corner as restored or reestablished, and (2) to at least 2 of the witness monuments shown on the drawing in (d), above.

Kimberly Clark monument was set from resurvey bearing tree, origin unknown, which resulted in Kimberly Clark corner position being S.37°E., 5.8 feet from original corner position.

- (f) Was the corner restored through acceptance of (1) an obliterated evidence location, or, (2) a found perpetuated location?

(1) an obliterated evidence location.

- (g) Was the corner reestablished through lost corner proportionate methods? If so, show the method, including the directions and distances to other public land survey corners used as evidence or used for proportioning in determining the corner location?

127819

CHECKED 6/7/85 W.F. Kullig S-1098

- (1) I, Milo E. Stefan
(Type or print name) certify that the corner location shown on this record was determined by me or under my direction and control and that this U.S. Public Land Survey Monument Record is correct and complete to the best of my knowledge and belief.

Milo E. Stefan
Signature

8/19/85
Date



U. S. PUBLIC LAND SURVEY MONUMENT RECORD

INSTRUCTIONS:

This record shall show the location of the corner and shall include all of the following nine elements (a through i).

- (a) Identify the corner by reference to the U.S. public land survey system.
- = Corner monument restored.

Section Corner to Sections 5, 6, 31, and 32, T.33-34N., R.14E., Forest and Langlade Counties, WI.

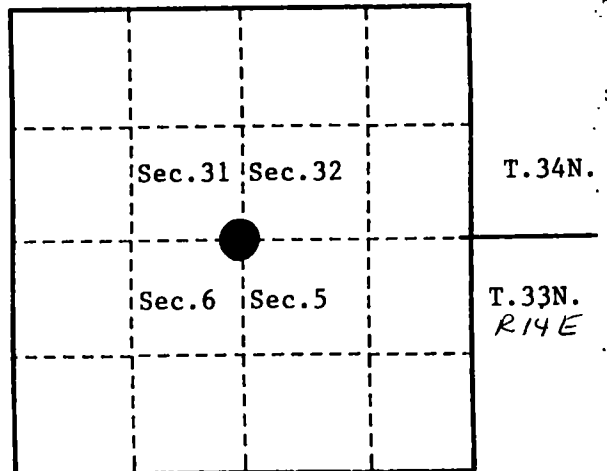

State Plane Coordinates
 Wisconsin North Zone
 79585.37562-N
 2281752.35877-E

Geographic Coordinates
 45-22-41.97973-N

- (b) 088-46-51.60845-W Describe any record evidence, monument evidence, occupational evidence, testimonial evidence or any other material evidence you considered, and whether the monument was found or placed.

Original survey in 1857 by Alfred Millard. Set wood post and the following bearing trees; Hemlock, 28", S.55°E., 40 links, Yellow Birch, 14", S.45°W., 48 links, Hemlock, 16", N.43°W., 38 links, Hemlock, 14", N.60°E., 58 links.

In 1962 Neal Spearhake set an aluminum monument (Kimberly Clark) off a scribed bearing tree. See "e" on reverse side.

In 1983, Milo Stefan, R.L.S., restored the corner from the remains of 3 original bearing tree stumps. Set a 2" x 36" aluminum monument with a tablet stamped to identify corner. Blazed and scribed new bearing trees; Balsam, 8", N.36°E., 30.60 feet, Aspen, 6", S.70°E., 27.38 feet, Balsam, 3", S.13°W., 6.70 feet, Balsam, 7", N.30°W., 15.26 feet, Steel sign post, West, 1.87 feet. Kimberly-Clark monument, S.37°E., 5.80 feet.

On March 26 1991, Alan Harrison, R.L.S., found monument and bearing trees as set in 1983. Northwest bearing tree is dead. Made 1 new bearing tree; Balsam, 8", S.55°W., 26.50 feet.

On November 1 1993, Alan Harrison, R.L.S., found monument and bearing trees as set in 1983 and 1991. Cut down all but the Northeast bearing tree. Blazed and scribed 3 new bearing trees; Aspen, 7", S.69°E., 42.19 feet, Aspen, 8", S.17°W., 32.60 feet, Balsam, 9", N.83°W., 63.79 feet.

- (c) In the plan view drawing below, provide reference ties to at least 4 witness monuments, or, if the location is within a municipality, to at least 2 witness monuments. (witness monuments shall be made of concrete, natural stone, iron or other equally durable material.)

- (d) Show a plan view drawing depicting the relevant monuments and reference ties which is sufficient in detail to enable accurate relocation of the corner monument if the corner monument is disturbed. Indicate north.

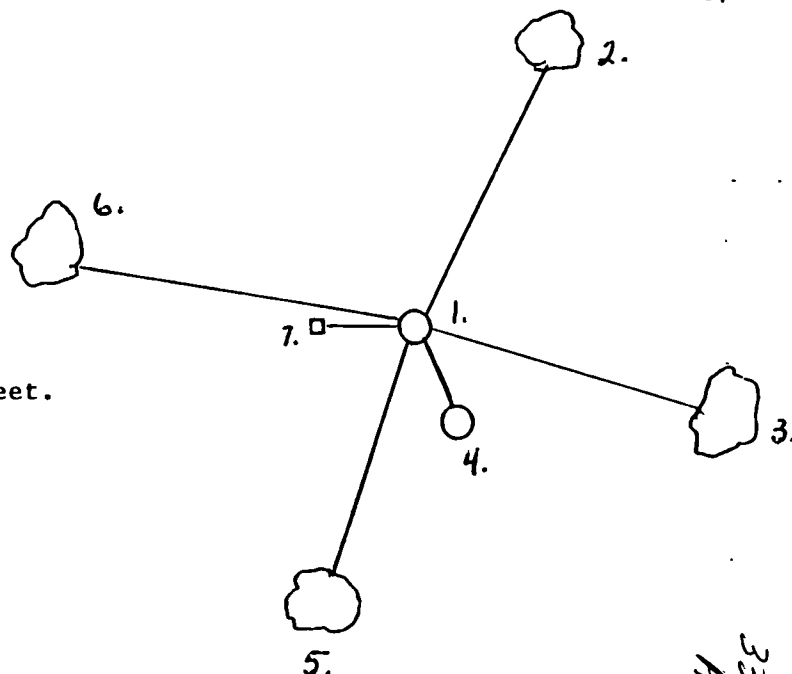

1. 2" x 36" aluminum monument with tablet stamped to identify corner.
2. Balsam, 8", N.36°E., 30.60 feet.
3. Aspen, 7", S.69°E., 42.19 feet.
4. Kimberly-Clark Monument, S.37°E., 5.80 feet.
5. Aspen, 8", S.17°W., 32.60 feet.
6. Balsam, 9", N.83°W., 63.79 feet.
7. Steel sign post, West, 1.87 feet.

(e) Describe any material discrepancy between the location of the corner as restored or reestablished and the location of that corner as previously restored or reestablished by distance and direction. Show the discrepancy on the plan view drawing under (d), above. Show the distances between the corner as previously restored or reestablished and (1) the corner as restored or reestablished, and (2) to at least 2 of the witness monuments shown on the drawing in (d), above.

Kimberly-Clark monument was set from a resurvey bearing tree, origin unknown, which resulted in Kimberly-Clark monument being S.37°E., 5.80 feet from original corner position.

(f) Was the corner restored through acceptance of (1) an obliterated evidence location, or, (2) a found perpetuated location?

(1)

(g & h) Was the corner reestablished through lost corner proportionate methods? If so, show the method, including the directions and distances to other public land survey corners used as evidence or used for proportioning in determining the corner location?

No

(1) I, Alan D. Harrison

(type or print name) certify that the corner location shown on this record was determined by me or under my direction and control and that this U.S. Public Land Survey Monument Record is correct and complete to the best of my knowledge and belief.

Alan D. Harrison 10/26/94

Signature

Date

CERTIFICATE READY FOR FILING:

Sue Vap
District Ranger

