

4341432 0000 2017

U.S. PUBLIC LAND SURVEY MONUMENT RECORD

Note: This form is intended and designed to fulfill all requirements of Wisconsin Administrative Code, Chapter A-E 7.08 U.S. Public Land Survey Monument Record (3)(a-i).

WISCRS - Langlade County

N: 427,217.26 USft

E: 721,176.04 USft

WISCRS - Forest County

N: 500,531.31 USft

E: 872,378.83 USft

Datum: NAD 83(2011)

GNSS Method: WISCORS RTN

	SEC. 5		
	T33N	R14E	

(b) HISTORY OF ORIGINAL CORNER ESTABLISHMENT

Original Surveyor: Alfred Millard

Original Accessories:

Date of Survey Commenced: August, 1857
 Completed: August, 1857

Hemlock 24" N15°W, 29 lks.
 Hemlock 25" S57°W, 31 lks.
 Y. Birch 10" S54°E, 9 lks.
 Sugar 10" N75°E, 48 lks.

(b)(f)(g)(h) Description of monument found at this corner and if it was accepted, state all evidence (material, testimonial, occupational, plats, records, other monuments) used as a basis for accepting. If not accepted or if nothing was found, state evidence used as basis for establishing location. If re-established through lost corner proportionate methods, indicate all monuments, distances and directions used to establish. Indicate type of monument and sign post found or set.

This is a perpetuation of a previous USPLS Monument Record by Alan D. Harrison, RLS dated January 17, 1984 and filed in the office of the Langlade County Surveyor. A complete history of the corner can be found on the previous monument record. I accept the previous location as a true and faithful perpetuation or reestablishment of the original corner location and further perpetuate it as follows.

November 13, 2016: I found and accepted the record monument, a 2-1/2" diam. aluminum pipe with a 3-1/4" diam. aluminum cap flush in the West track of a woods road. I set a DEEP-1 magnet adjacent to the monument. The record birch bearing tree is a stump. I found or established accessories as shown below. A USFS steel sign post bears South, 9.2 ft. I set a white vinyl sign post bearing West, 4.8 ft.

(c)(d)(e) Plan view of corner with ties to at least 4 witness monuments. If in disagreement with previously established corner, show the distances between the two corners and also indicate the ties to the disputed.

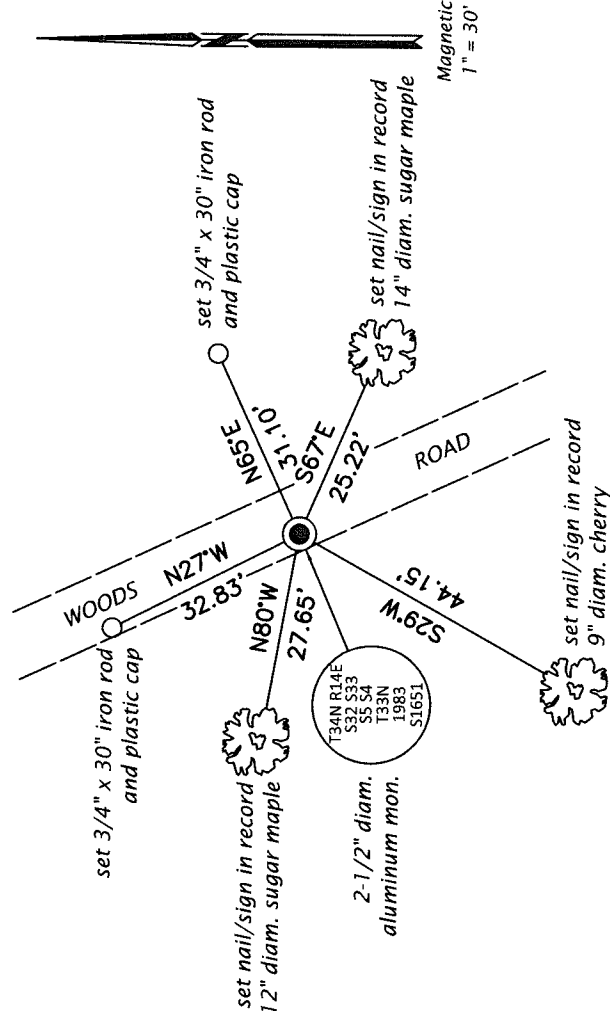

(i) I, Jeffrey W. Austin, Professional Land Surveyor No. S-1885, hereby certify that the corner location on this record was determined by me or under my direction and control and that this U.S. Public Land Survey Monument Record is correct and complete to the best of my knowledge and belief.

 Signature
 Date May 4, 2017

