

INDEX OF SHEETS

- SHEET NO. 1 TITLE
- SHEET NO. 2 TYPICAL CROSS SECTIONS
- SHEET NO. 2 ESTIMATE OF QUANTITIES
- SHEET NO. 2A MISCELLANEOUS QUANTITIES
- SHEET NO. — RIGHT OF WAY PLAT
- SHEET NO. 3-7 PLAN AND PROFILE STA. 427+00 TO STA. 555+50
- SHEET NO. 8-12 STANDARD DETAILS
- SHEET NO. — DRAINAGE STRUCTURES
- SHEET NO. 13-19 EARTHWORK COMPUTATIONS (I.B.M.)

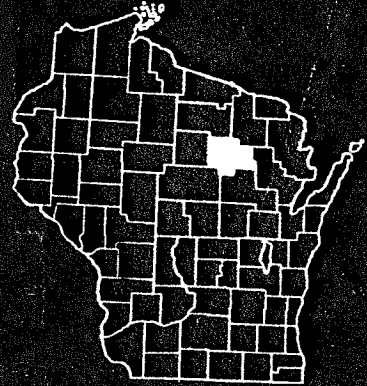

QUA
STATE OF WISCONSIN
STATE HIGHWAY COMMISSION OF WISCONSIN

CONTRACT NO. 1		PROJECT	SHEET NUMBER	TOTAL SHEETS
		S0938(4)	2	19
PROVISIONS AS				
CO. AND HIGHWAY				
34.6	93		1	19

PLAN AND PROFILE OF PROPOSED
SWAMP CREEK - S.T.H. 55 ROAD
C.T.H. "K"
LANGLADE COUNTY
PROJECT S0938(4)

BEGINNING AT A POINT APPROXIMATELY 1280 FT. SOUTHERLY AND 750 FT. WESTERLY FROM THE EAST QUARTER CORNER OF SEC. 7 T.34N. R.12E. THENCE IN AN EASTERLY DIRECTION TO A POINT APPROXIMATELY 1613 FT. EASTERLY AND 1320 FT. NORTHERLY FROM THE SOUTHWEST COR. OF SEC. 10 T.34N. R.12E.

SCALES { PLAN 1 IN. = 100 FT.
PROFILE HOR. 1 IN. = 100 FT. VERT. 1 IN. = 10 FT.
CROSS SECTIONS HOR. 1 IN. = 5 FT. VERT. 1 IN. = 5 FT.

20011

RECORD # 20011

APPROVED FOR LANGLADE COUNTY OFFICE

DATE FILED: *7/29/58* BY *DL*

7/29/58 COUNTY HIGHWAY COMMISSIONER

11002

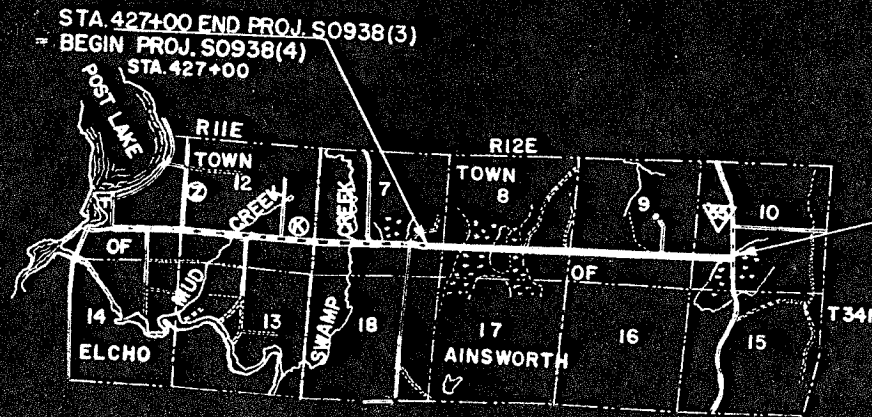

STA. 555+50
END PROJ. S0938(4)

CONVENTIONAL SIGNS

- | | | | |
|------------------------|-------|-------------------------------|------------------|
| LINE | ----- | CULVERTS IN PLACE | ----- |
| TOWNSHIP OR RANGE LINE | ----- | CULVERTS REQUIRED | ----- |
| SECTION LINE | ----- | DROP INLET | ----- |
| RIGHT OF WAY LINE | ----- | POWER POLE | ----- |
| LEFT RIGHT OF WAY LINE | ----- | TELEPHONE OR TELEGRAPH POLE | ----- |
| FENCE { WOVEN | ----- | RIGHT OF WAY MARKERS | ----- |
| BARBED | ----- | REFERENCE STAKE FOR HUBS ONLY | ----- |
| PROPERTY LINE | ----- | MARSH | ----- |
| RAILROAD | ----- | HEDGE | ----- |
| ADJACENT SURVEY LINE | ----- | TREES | ----- |
| | | GROUND ELEVATION | DATUM LINE 75.9 |
| | | GRADE ELEVATION | DATUM LINE 75.16 |

LAYOUT

SCALE 0 1/2 1 MILE

TOTAL NET LENGTH OF CENTERLINE = 2.434 MI.

STATE HIGHWAY
COMMISSION OF WISCONSIN
MADISON, WIS.

SURVEYOR: *AMH* NOTE BOOK: *18M*

DIVISION ENGINEER: *LMB* M. O. CHECKER

DISTRICT CHECKER: *ERD* CORRECT

CORRECT:

DATE: *7-11-58* *Max J. Jett* DISTRICT ENGINEER

RECOMMENDED FOR APPROVAL:

DATE: *7-15-58* *J. J. Bell* ENGINEER OF DESIGN

APPROVED:

DATE: *7/15/58* *E. C. Rustin* STATE HIGHWAY ENGINEER

DEPARTMENT OF COMMERCE
BUREAU OF PUBLIC ROADS

APPROVED:

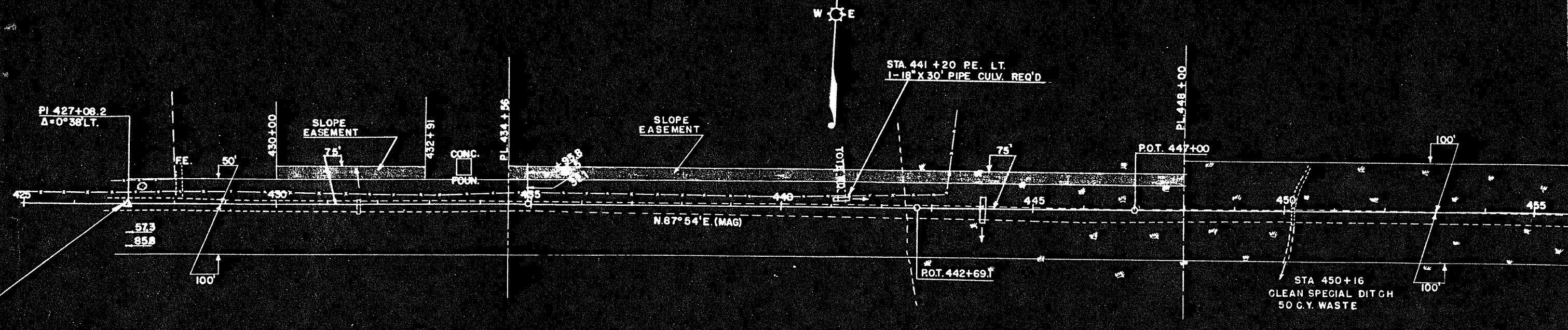

427+00 BEGIN PROJ. S0938(4)
= END PROJ. S0938(3)

BENCH MARKS

NO.	STATION	DESCRIPTION	ELEV.
47	422+30	SPIKE IN 16" ASPEN 110' LT.	58.07
48	433+00	SPIKE IN 20" ELM 115' LT.	64.66
49	440+80	SPIKE IN 8" ASPEN 95' RT.	40.37
50	455+50	SPIKE IN 6" ASPEN 120' RT.	38.64

T CENTER LINE LENGTH STA 427+00 - 455+00 = 2800 FT

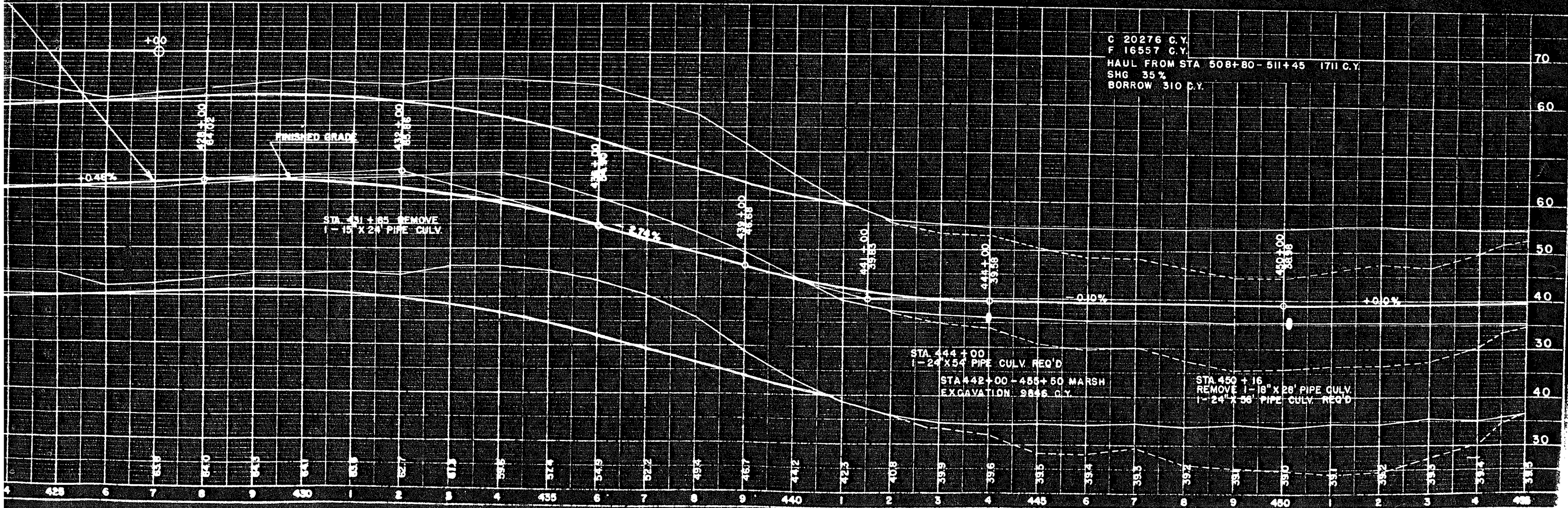

C 20276 C.Y.
F 16557 C.Y.
HAUL FROM STA 508+80 - 511+45 1711 C.Y.
SHG 35%
BORROW 310 C.Y.

STA 444+00
1-24\"/>

STA 450+16
REMOVE 1-18\"/>

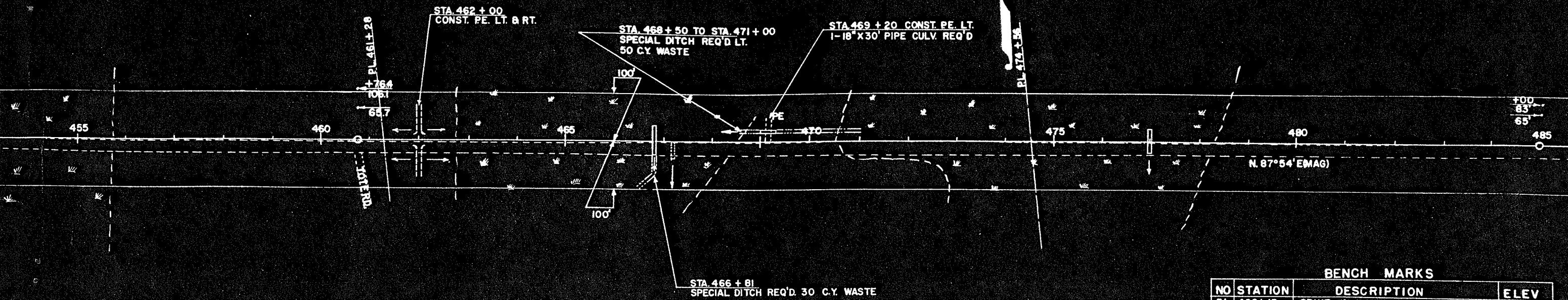
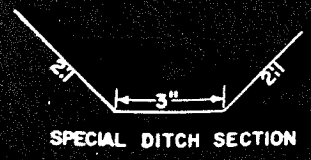

BENCH MARKS

NO	STATION	DESCRIPTION	ELEV
51	462+15	SPIKE IN W. BIRCH 125' RT	40.12
52	474+10	SPIKE IN 6" W. BIRCH 70' RT	42.08
53	483+50	SPIKE IN 6" W. BIRCH 65' RT	65.82

NET CENTER LINE LENGTH STA. 455+00-485+00 = 3000 FT.

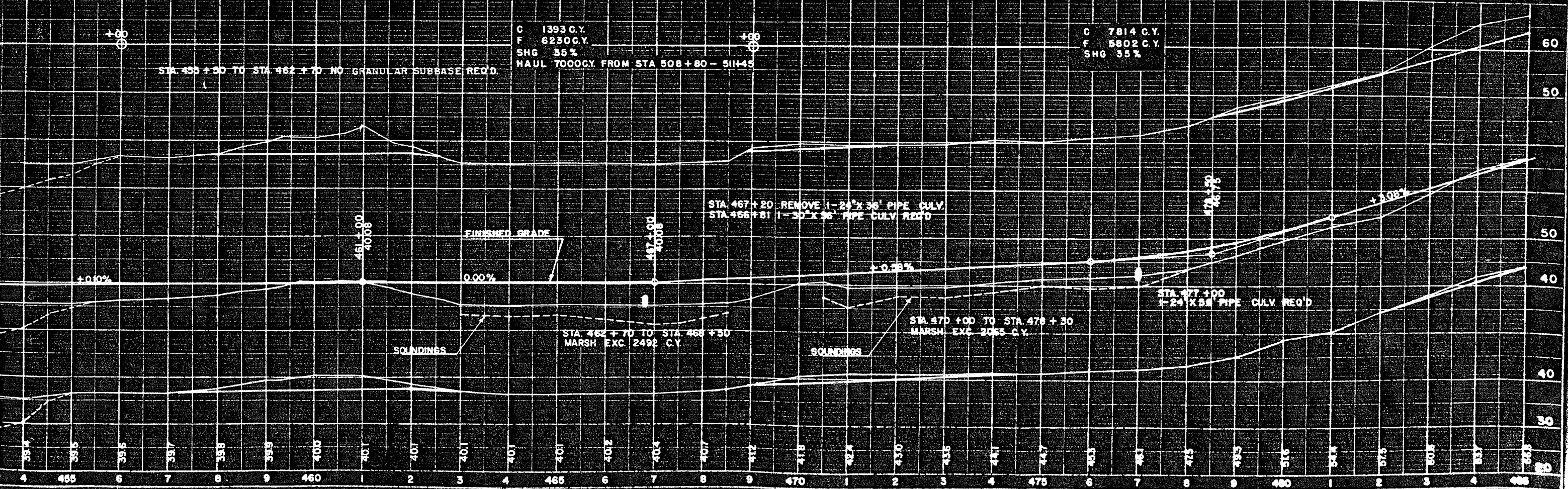

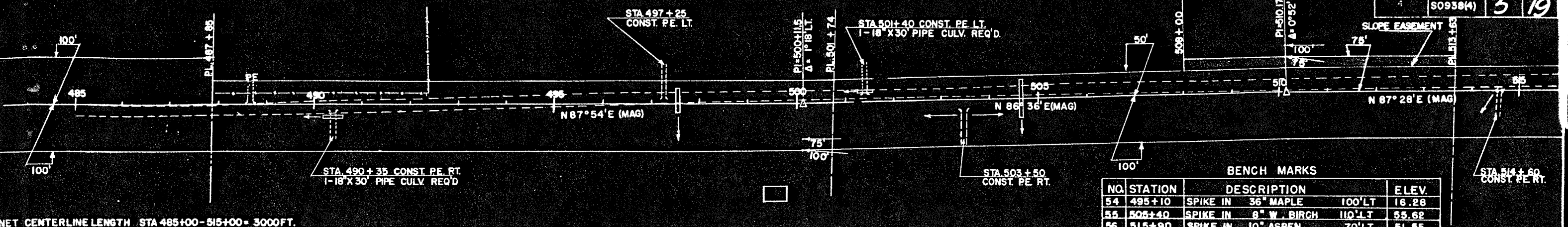

BENCH MARKS

NO.	STATION	DESCRIPTION	ELEV.
54	495+10	SPIKE IN 36" MAPLE 100' LT	16.29
55	505+40	SPIKE IN 8" W. BIRCH 110' LT	55.62
56	515+90	SPIKE IN 10" ASPEN 70' LT	51.55

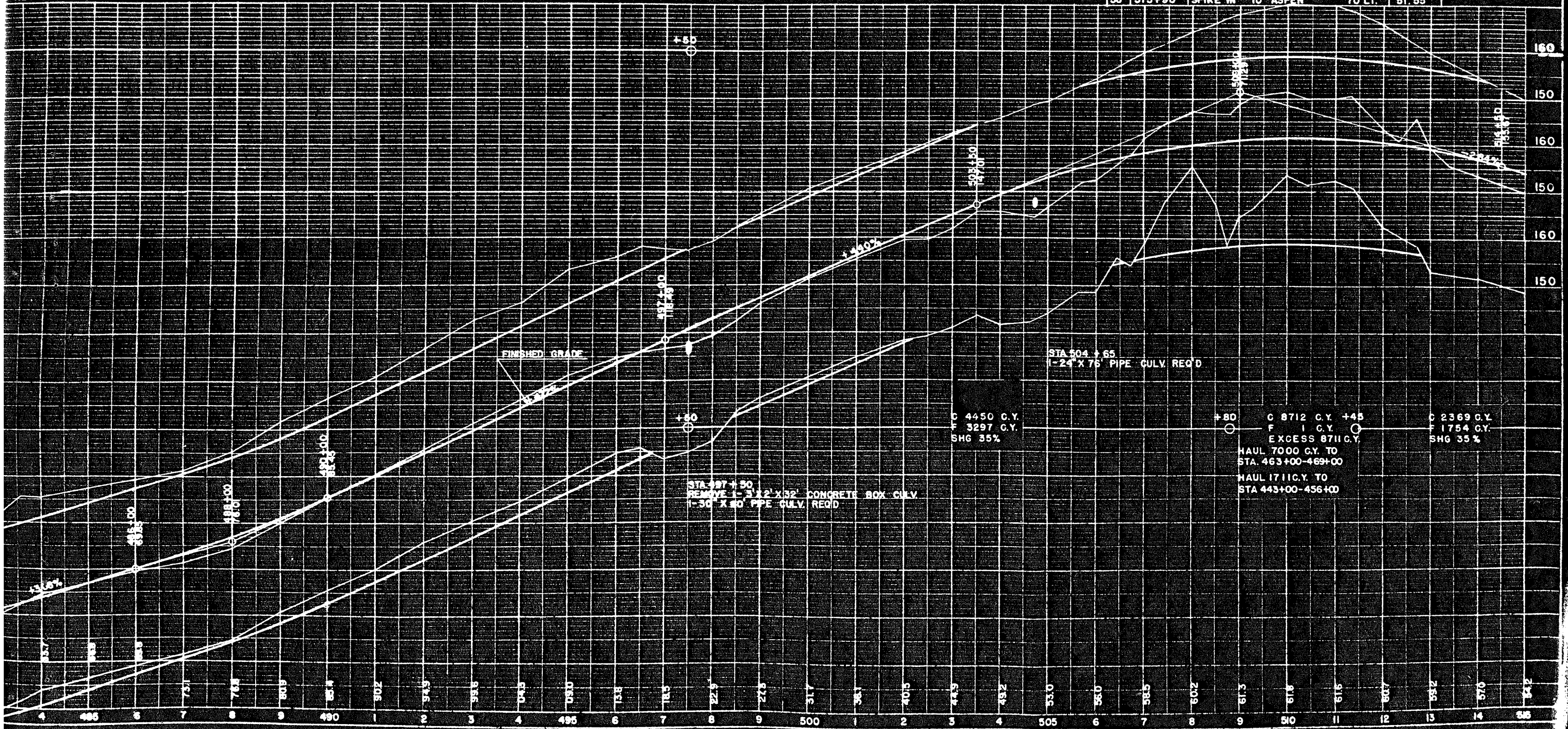

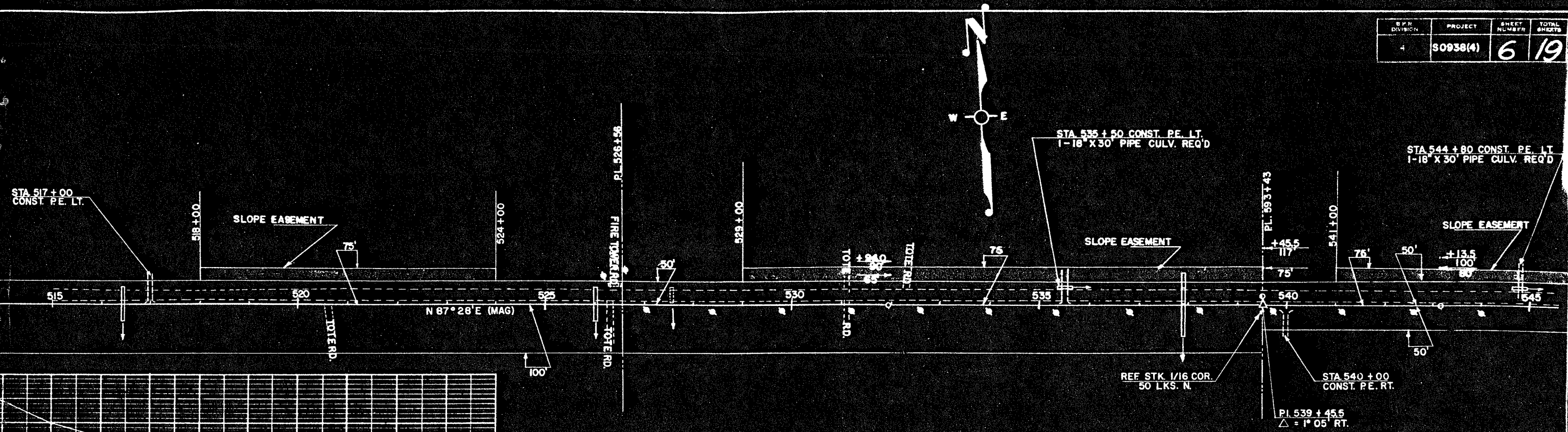

BENCH MARKS

NO	STATION	DESCRIPTION	ELEV.
57	526+00	SPIKE IN 18" HEMLOCK 100' LT.	22.20
58	536+10	SPIKE IN 36" YELLOW BIRCH 80' LT.	96.48
59	545+40	SPIKE IN 24" MAPLE 100' LT.	00.46

NET CENTER LINE LENGTH STA 515+00-545+00 = 3000FT.

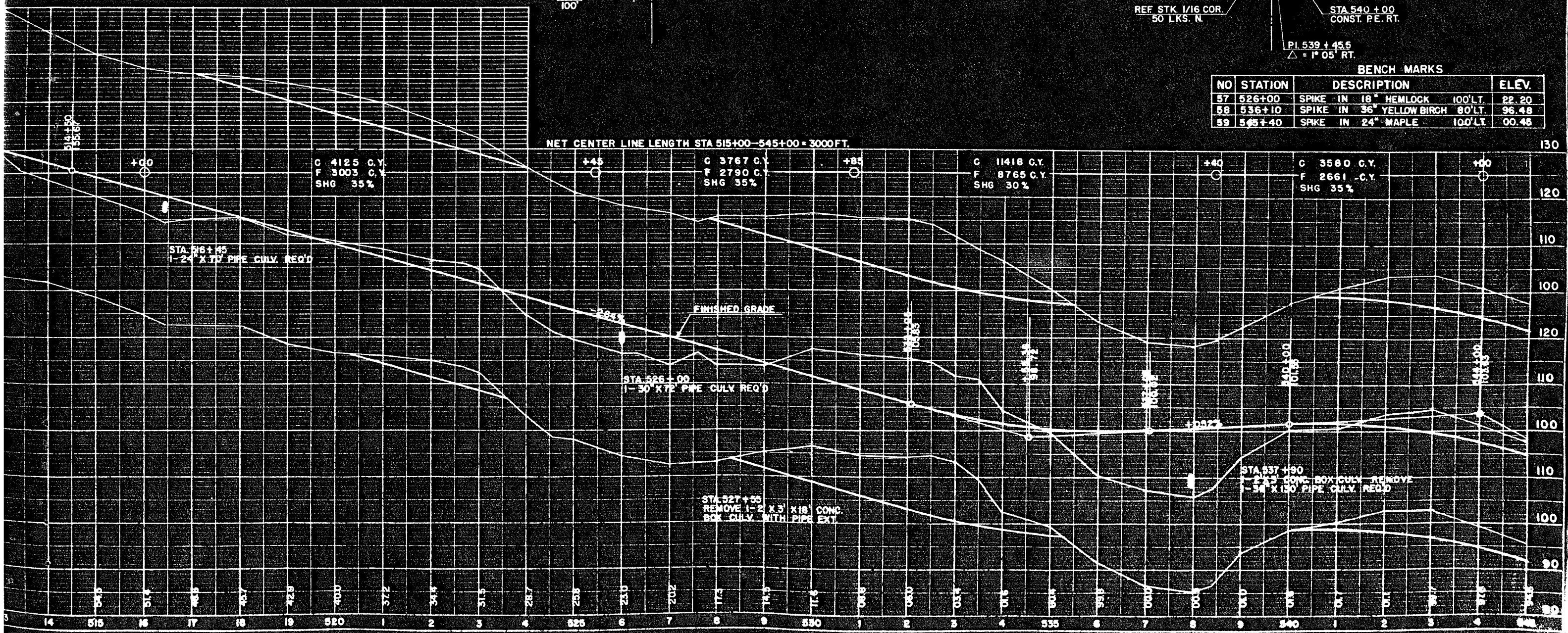

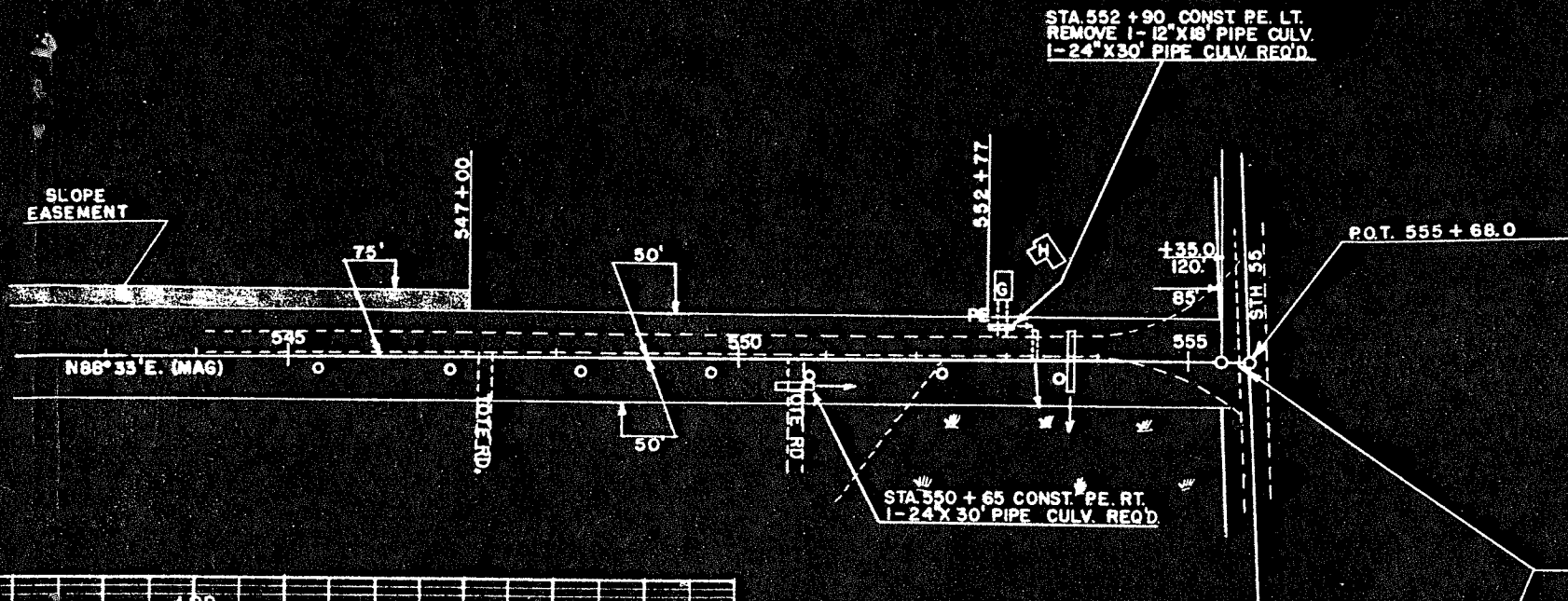

STA 555 + 50 END OF PROJECT S0938 (4)

BENCH MARKS

NO.	STATION	DESCRIPTION	ELEV.
60	552+45	SPIKE IN 7" ASPEN	60.15

NET CENTER LINE LENGTH STA. 545+00 - 555+50 = 1050 FT.

