

INDEX OF SHEETS

Sheet No.	Title
Sheet No. 1	Title
Sheet No. 2 - 2.5	Typical Sections and Details
Sheet No. 3 - 3.1	Estimate of Quantities
Sheet No. 3A - 3C	Miscellaneous Quantities
Sheet No. 4 - 4.1	Right of Way Plat
Sheet No. 5 - 5.8	Plan and Profile
Sheet No. 6 - 6.1B	Standard Detail Drawings
Sheet No. -	Sign Plates
Sheet No. -	Structure Plans
Sheet No. -	Computer Earthwork Data
Sheet No. 9 - 9.10	Cross Sections

TOTAL SHEETS = 53



STATE OF WISCONSIN
DEPARTMENT OF TRANSPORTATION

PLAN OF PROPOSED IMPROVEMENT
NORTH AVENUE - STH 64

CITY OF ANTIGO

USH 45

LANGLADE COUNTY

STATE PROJECT	FEDERAL PROJECT	
	PROJECT	CONTRACT
1602-01-71	F07(23)	1

STATE PROJECT NUMBER
1602-01-71

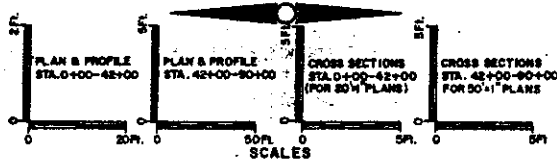

DESIGN DESIGNATION

A.D.T. 1988	= 15,625
A.D.T. 2008	= 20,930
D.H.V.	= 2,407
D.	= 60-40
T.	= 8.2%
V.	= 55 M.P.H.

BEGIN PROJECT
STA. 12+00 @ USH 45
* X 2,29,936.49
* Y 482,850.57

END PROJECT
STA. 89+00 @ USH 45

CONVENTIONAL SIGNS

COUNTY LINE	
CORPORATE LIMITS	
PROPERTY LINE	
LOT LINE	
LIMITED HIGHWAY EASEMENT	
EXISTING RIGHT OF WAY	
NEW RIGHT OF WAY	
REFERENCE LINE	
SLOPE INTERCEPT	
ORIGINAL GROUND	
MARSH OR ROCK PROFILE	
CULVERT IN PLACE	
CULVERT REQUIRED	
CULVERT REQUIRED (Profile)	

COMBUSTIBLE FLUIDS (UNDER PRESSURE)	
UNDERGROUND UTILITIES	
GAS	
ELECTRIC	
TELEPHONE	
SERVICE PEDESTAL	
CABLE MARKER	
POWER POLE	
TELEPHONE POLE	
RAILROADS	
MARSH	
WOODED AREA	

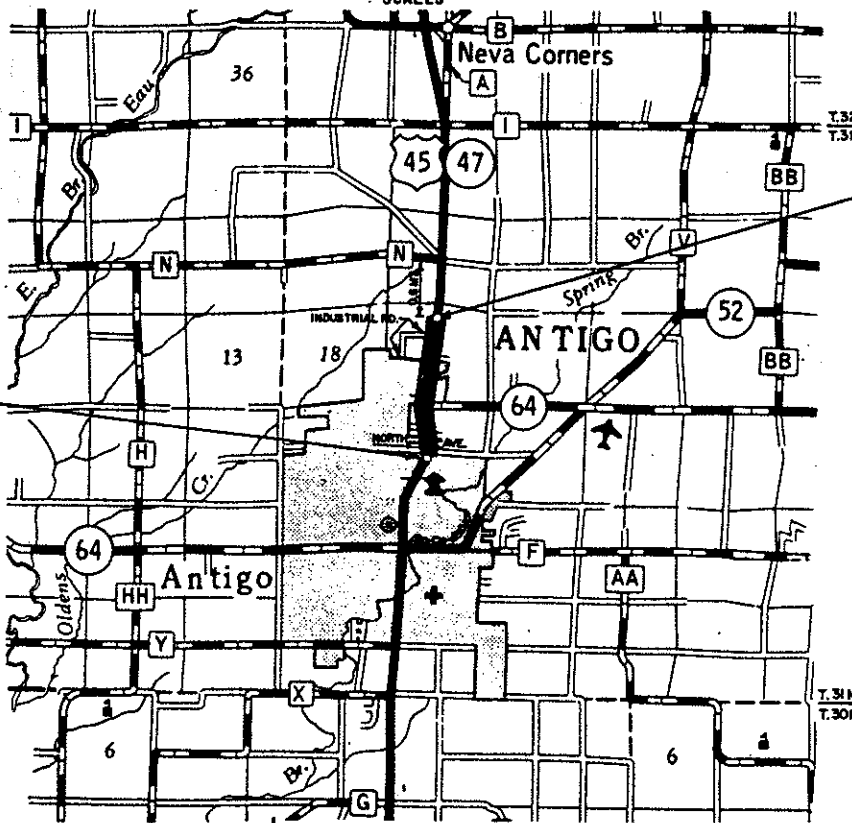
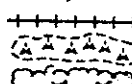
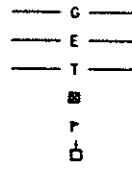

TOTAL NET LENGTH OF CENTERLINE = 1.456 MI.

RECORD # 20084
LANGLADE COUNTY SURVEYORS OFFICE
DATE FILED: 4/5/95 BY: D.T.
* ALL COORDINATES SHOWN ON THIS PLAN ARE REFERENCED TO THE WISCONSIN COORDINATE SYSTEM, NORTH ZONE.

STATE OF WISCONSIN DEPARTMENT OF TRANSPORTATION	
Surveyor <u>J.R.W.</u>	District Checker <u>P.H.</u>
Designer <u>F.V.S.</u>	C.O. Checker <u>AK</u>
District Supervisor <u>P.M.J.</u>	C.O. Coordinator <u>L.A.S.</u>
APPROVED:	
DATE: <u>9-3-87</u>	<u>Robert R. Fisher</u> DISTRICT TRANSPORTATION DIRECTOR
APPROVED:	
DATE: <u>10/2/87</u>	<u>R. L. Bowen</u> STATE DESIGN ENGINEER FOR HWYS.
APPROVED:	
DATE: <u>10/6/87</u>	<u>E. J. Busch</u> DIRECTOR OF ENGINEERING DEVELOPMENT
U.S. DEPARTMENT OF TRANSPORTATION FEDERAL HIGHWAY ADMINISTRATION REGION 5 WISCONSIN DIVISION	
APPROVED:	
DATE:	DIVISION ADMINISTRATOR

STATE PROJECT NUMBER	SHEET NO.
1602-01-71	25
STORM SEWER & DRAINAGE DITCH DETAIL SHEET	
FOR	
U.S.H. 45	LANGLADE CO.

Scale
0' 50'

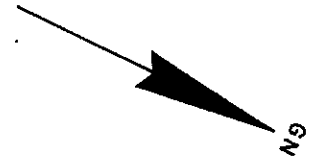

PERMANENT DRAINAGE EASEMENT

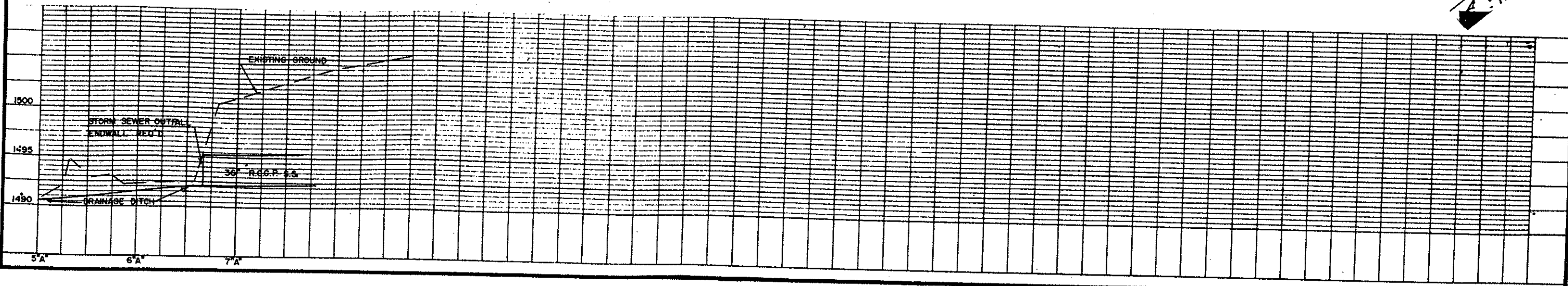
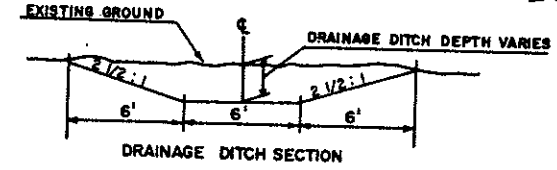
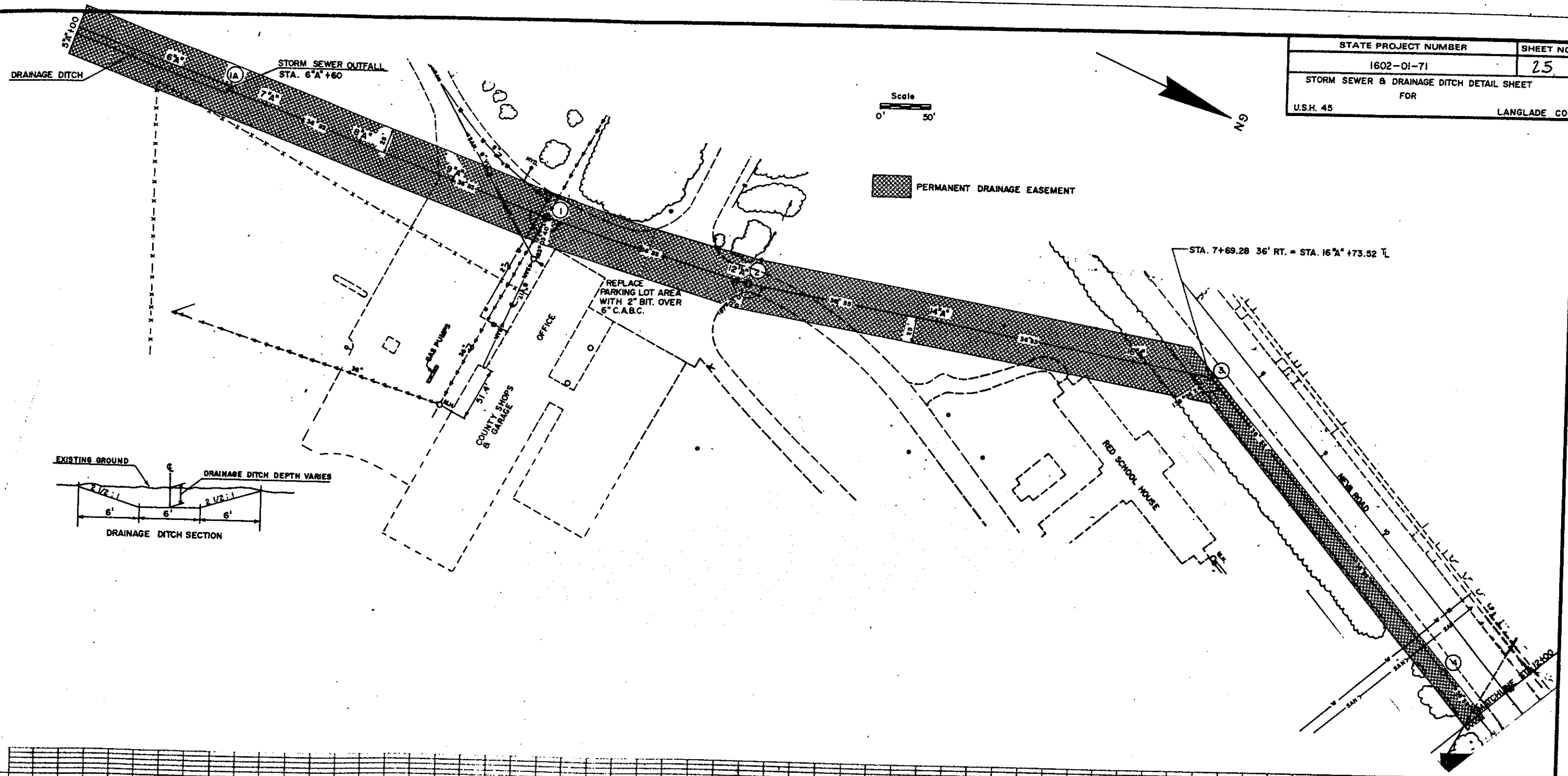

SCHEDULE OF LANDS & INTERESTS REQUIRED

PARCEL NUMBER	SHEET NUMBER	OWNERS	INTEREST REQUIRED	TOTAL ACRES	R/W ACRES	NEW	EXISTING	TOTAL	TOTAL ACRES REMAINING	L.H.E. ACRES TEMP.	L.H.E. ACRES PERM.
1.	4.1	STATE OF WISCONSIN	L.H.E.								0.16
2.	4.1	LANGLADE COUNTY	L.H.E.								1.36
3.	4.1	CITY OF ANTIGO	L.H.E.								0.09
4.	4.1	DONALD P. PETERS	L.H.E.								0.02
5.	4.1	GENERAL TELEPHONE (40)	RELEASE OF RIGHTS								
6.	4.1	WISCONSIN PUBLIC SERVICE CORP. (41)	RELEASE OF RIGHTS								

REVISION DATE	ROUTE U.S.H. 45	COUNTY LANGLADE	DATE 6-29-87	R/W PROJECT NUMBER 1602-01-21	SHEET NUMBER 4.1
	SCALE FT. 0 100 200	GRID FACTOR 1.000095		FEDERAL PROJECT NUMBER 1602-01-71	

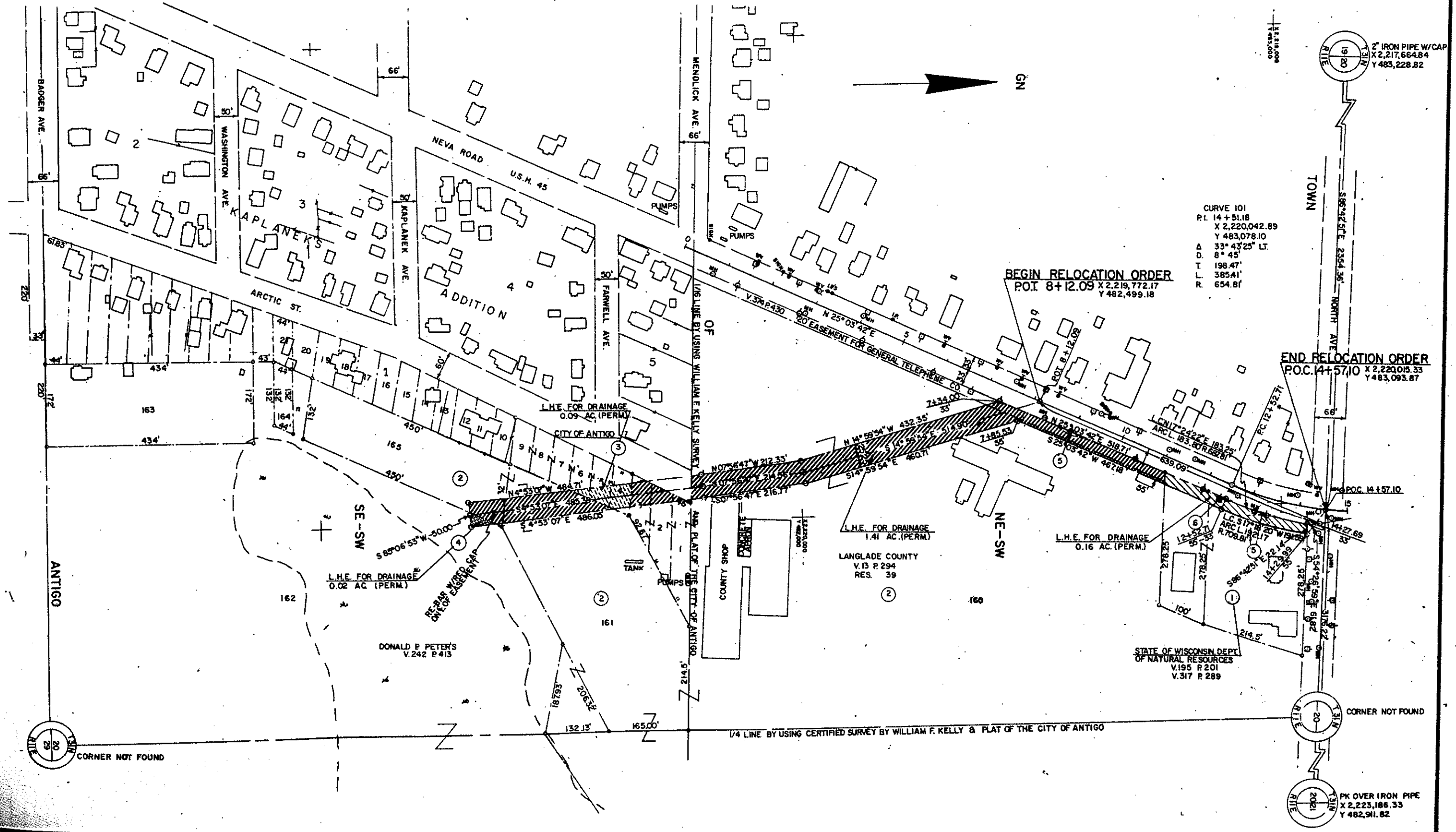

CURVE 101
 P.I. 14 + 51.18
 X 2,220,042.89
 Y 483,078.10
 A 33° 43' 25" LT.
 D. 8° 45'
 T. 198.47'
 L. 385.41'
 R. 654.81'

BEGIN RELOCATION ORDER
 POI 8+12.09 X 2,219,772.17
 Y 482,499.18

END RELOCATION ORDER
 POC 14+57.10 X 2,220,015.33
 Y 483,093.87

L.H.E. FOR DRAINAGE
 1.41 AC. (PERM.)
 LANGLADE COUNTY
 V.13 P.294
 RES. 39

L.H.E. FOR DRAINAGE
 0.16 AC. (PERM.)

L.H.E. FOR DRAINAGE
 0.02 AC. (PERM.)

STATE OF WISCONSIN DEPT.
 OF NATURAL RESOURCES
 V.195 P.201
 V.317 P.289

1/4 LINE BY USING CERTIFIED SURVEY BY WILLIAM F. KELLY & PLAT OF THE CITY OF ANTIGO

CORNER NOT FOUND

CORNER NOT FOUND

PK OVER IRON PIPE
 X 2,223,186.33
 Y 482,911.82



SCALE
0 20 FT

CURVE 101
 P.I. 14+51.18 E STH 45
 X 2,220,042.89
 Y 483,078.10
 Δ 33°43'25" LT.
 A 8°45'00"
 D 198.47'
 L 385.41'
 S.E. .04%

STATION EQUATION
 P.T. 16+38.12 E USH 45 BK.
 STA. 16+38.12 E USH 45 BK.
 STA. 16+38.12 E USH 45 BK.

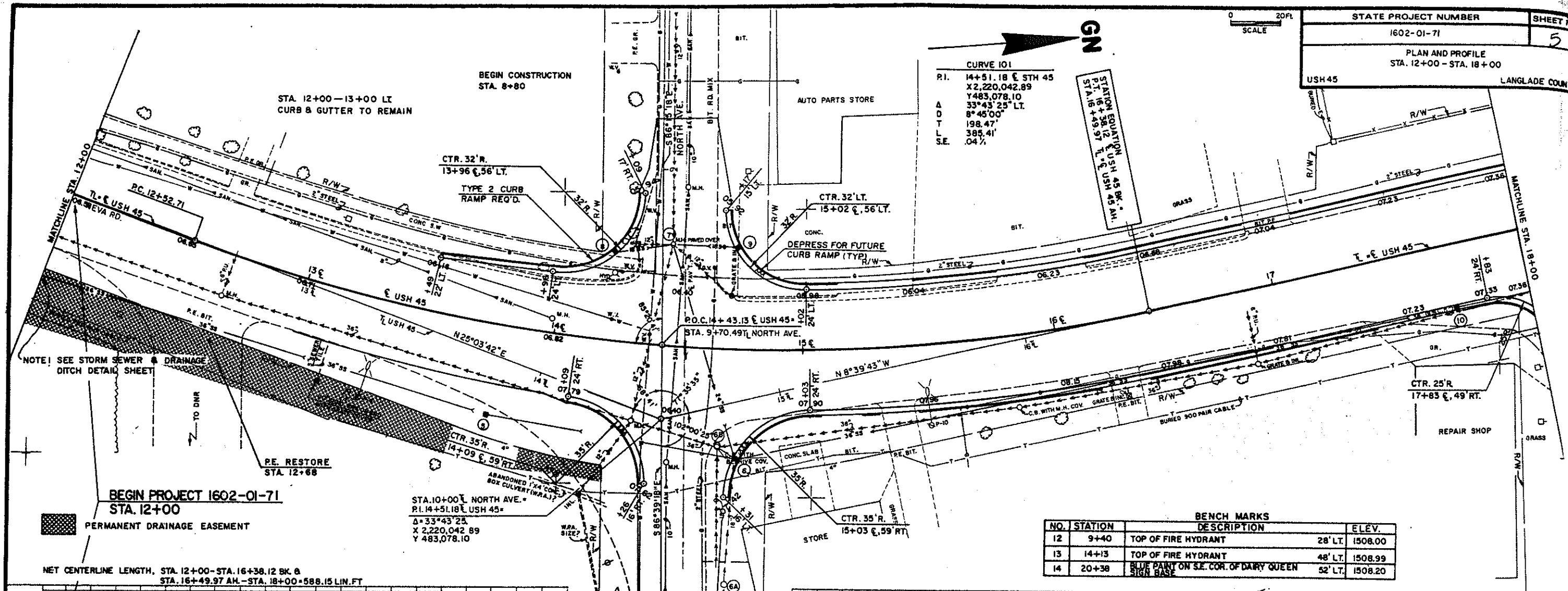

BENCH MARKS

NO.	STATION	DESCRIPTION	ELEV.
12	9+40	TOP OF FIRE HYDRANT 28' LT.	1508.00
13	14+13	TOP OF FIRE HYDRANT 48' LT.	1508.99
14	20+38	BLUE PAINT ON S.E. COR. OF DAIRY QUEEN SIGN BASE	1508.20

NET CENTERLINE LENGTH, STA. 12+00 - STA. 16+38.12 BK. @
 STA. 16+49.97 AH. - STA. 18+00 = 588.15 LIN. FT

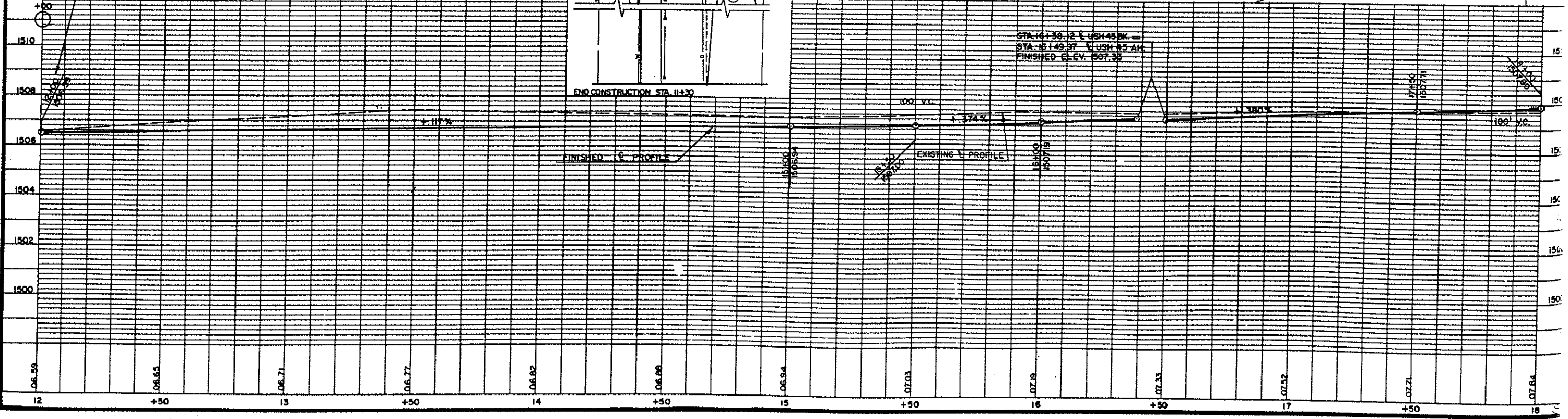

STATE PROJECT NUMBER	SHEET NO.
1602-01-71	51
PLAN AND PROFILE	
STA. 18+00 - STA. 24+00	
USH 45 LANGLADE COUNTY	

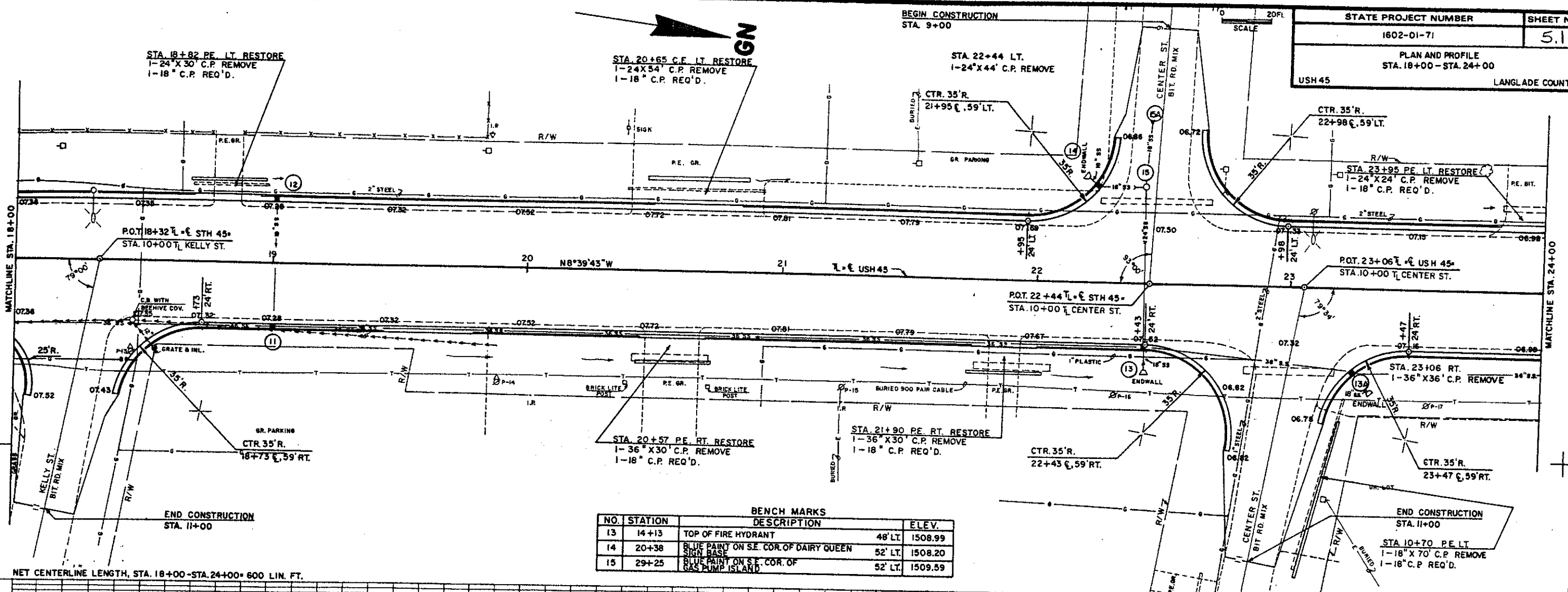

BENCH MARKS

NO.	STATION	DESCRIPTION	ELEV.
13	14+13	TOP OF FIRE HYDRANT	48' LT. 1508.99
14	20+38	BLUE PAINT ON S.E. COR. OF DAIRY QUEEN SIGN BASE	52' LT. 1508.20
15	29+25	BLUE PAINT ON S.E. COR. OF GAS PUMP ISLAND	52' LT. 1509.59

NET CENTERLINE LENGTH, STA. 18+00 - STA. 24+00 = 600 LIN. FT.

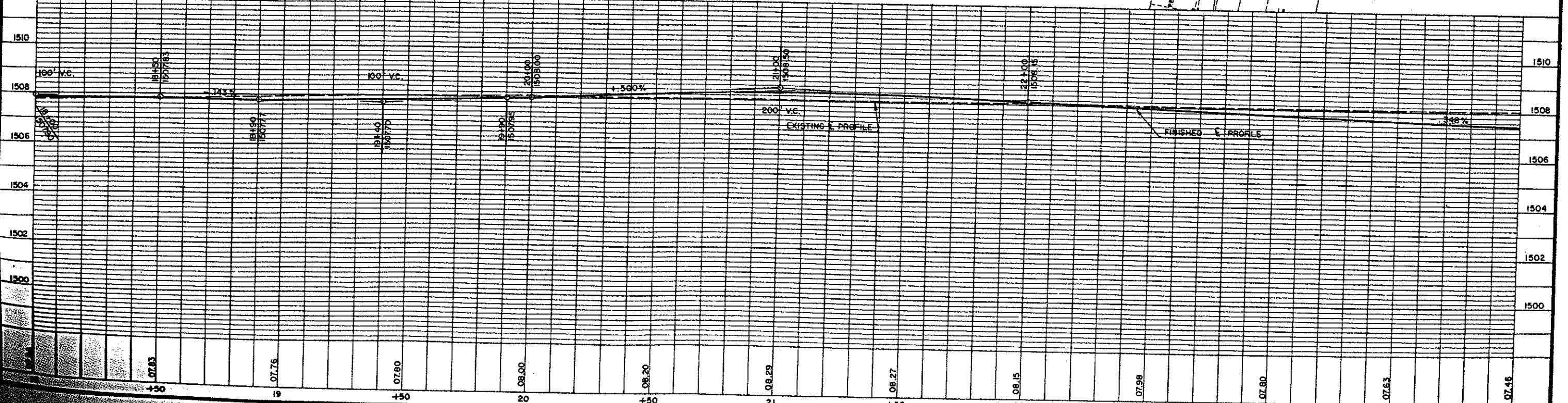

STATE PROJECT NUMBER	SI
1602-01-71	
PLAN AND PROFILE	
STA. 24+00 - STA. 30+00	
USH 45	LANGLADE

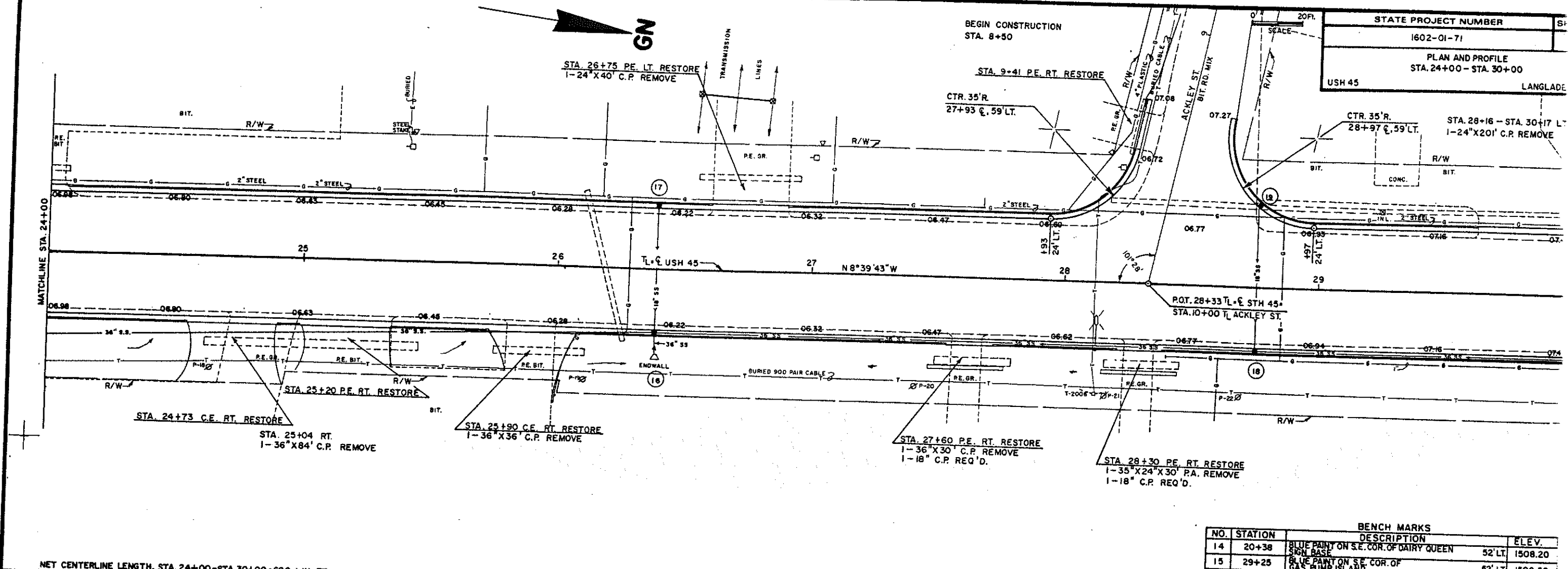

NET CENTERLINE LENGTH, STA. 24+00-STA. 30+00=600 LIN. FT.

BENCH MARKS			
NO.	STATION	DESCRIPTION	ELEV.
14	20+38	BLUE PAINT ON S.E. COR. OF DAIRY QUEEN SIGN BASE	52' LT. 1508.20
15	29+25	BLUE PAINT ON S.E. COR. OF GAS PUMP ISLAND	52' LT. 1509.59
16	34+20	BLUE PAINT, E. BOLT OF LIGHT POLE BASE	52' LT. 1511.18

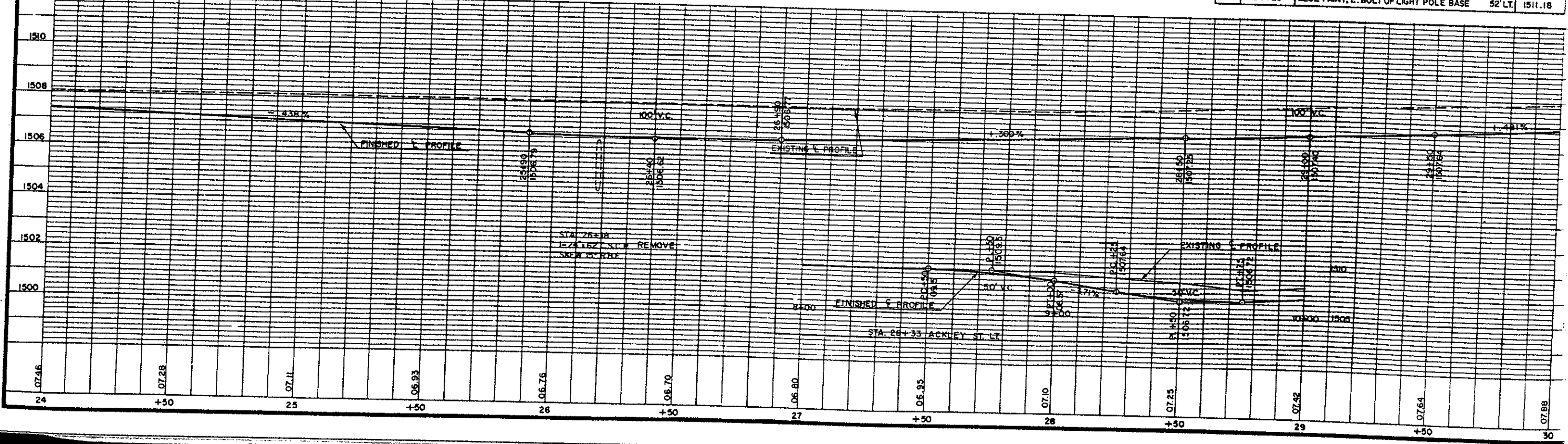

STATE PROJECT NUMBER	SHEET NO.
1602-01-71	53
PLAN AND PROFILE	
STA. 30+00 - STA. 36+00	
USH 45	LANGLADE COUNTY

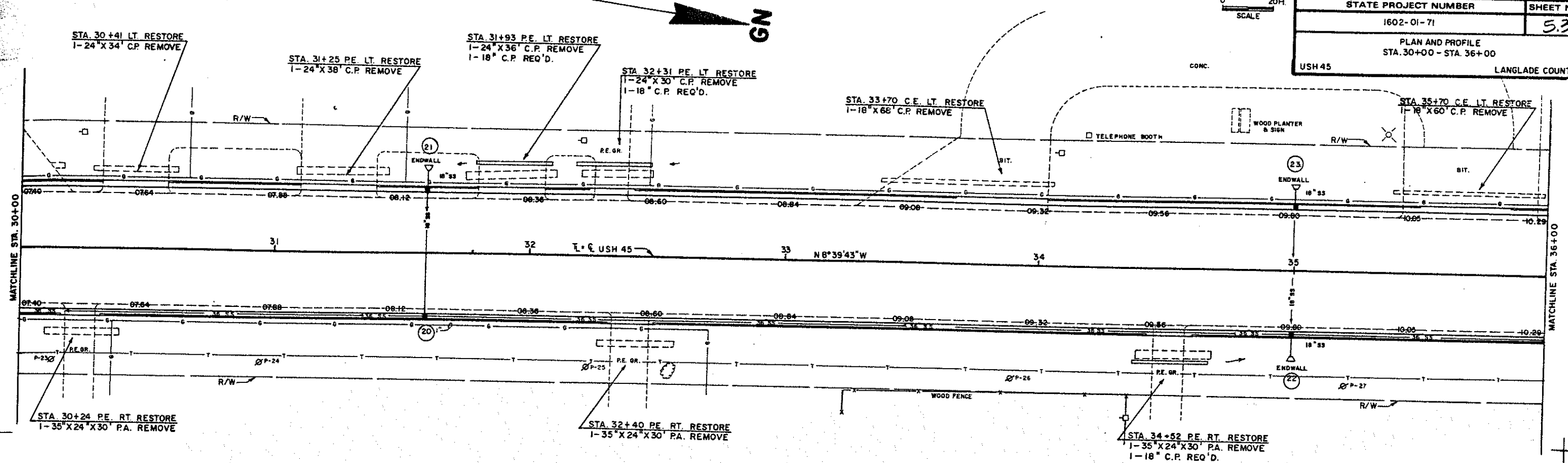

NET CENTERLINE LENGTH, STA. 30+00 - STA. 36+00 = 600 LIN. FT.

BENCH MARKS			
NO.	STATION	DESCRIPTION	ELEV.
15	29+25	BLUE PAINT ON S.E. COR OF GAS PUMP ISLAND	52' LT. 1509.59
16	34+20	BLUE PAINT, E. BOLT OF LIGHT POLE BASE	52' LT. 1511.18
17	40+17	TOP OF FIRE HYDRANT	64' LT. 1514.01

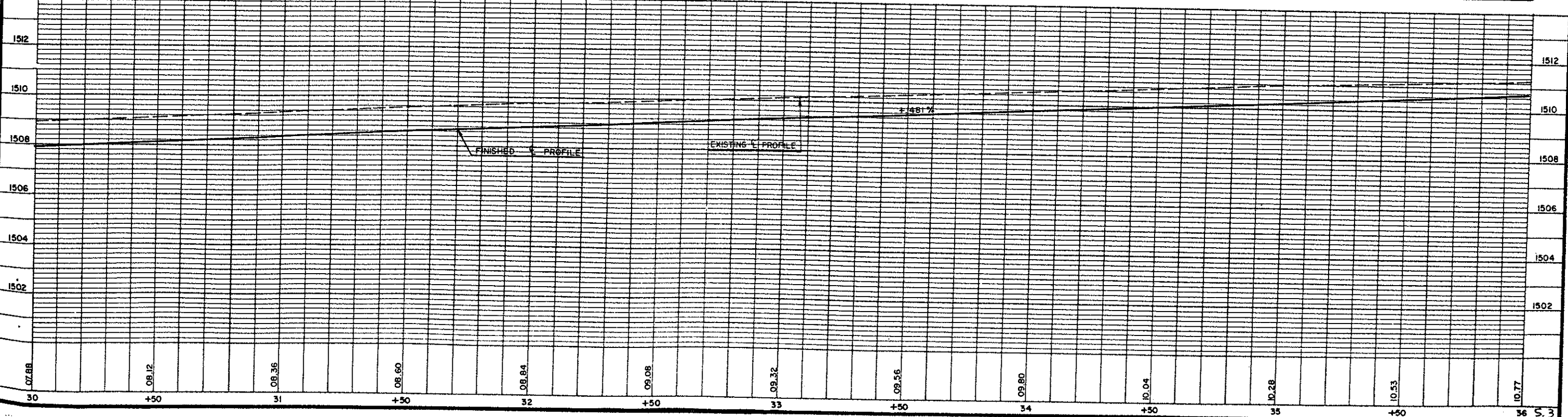

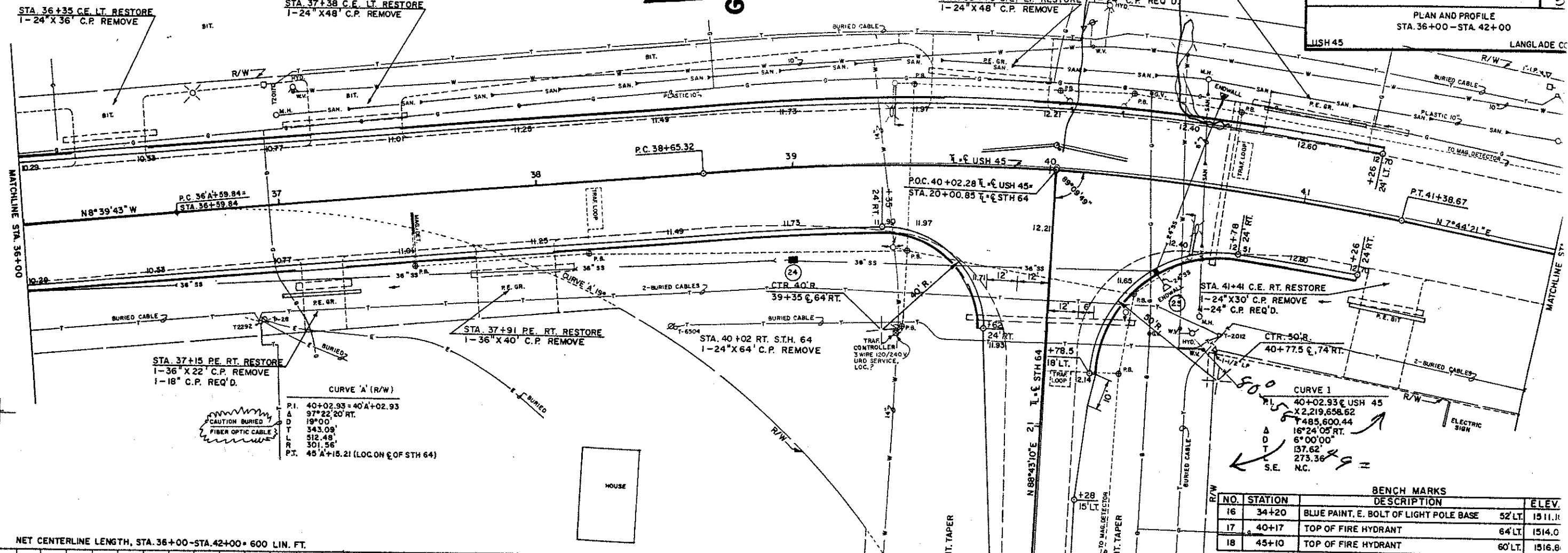

CURVE A (R/W)

P.I.	40+02.93 = 40'A+02.93
A	97°22'20" RT.
D	19°00'
T	343.09'
L	512.48'
R	301.56'
P.T.	45'A+18.21 (LOC ON E OF STH 64)

CURVE 1

P.I.	40+02.93 @ USH 45
A	X 2,219,658.62
D	X 485,600.44
T	X 16'24'05" RT.
L	X 6°00'00"
R	X 137.62'
P.T.	X 273.36'
S.E. N.C.	

BENCH MARKS

NO.	STATION	DESCRIPTION	ELEV.
16	34+20	BLUE PAINT, E. BOLT OF LIGHT POLE BASE	52' LT. 1511.1
17	40+17	TOP OF FIRE HYDRANT	64' LT. 1514.0
18	45+10	TOP OF FIRE HYDRANT	60' LT. 1516.8

NET CENTERLINE LENGTH, STA. 36+00 - STA. 42+00 = 600 LIN. FT.

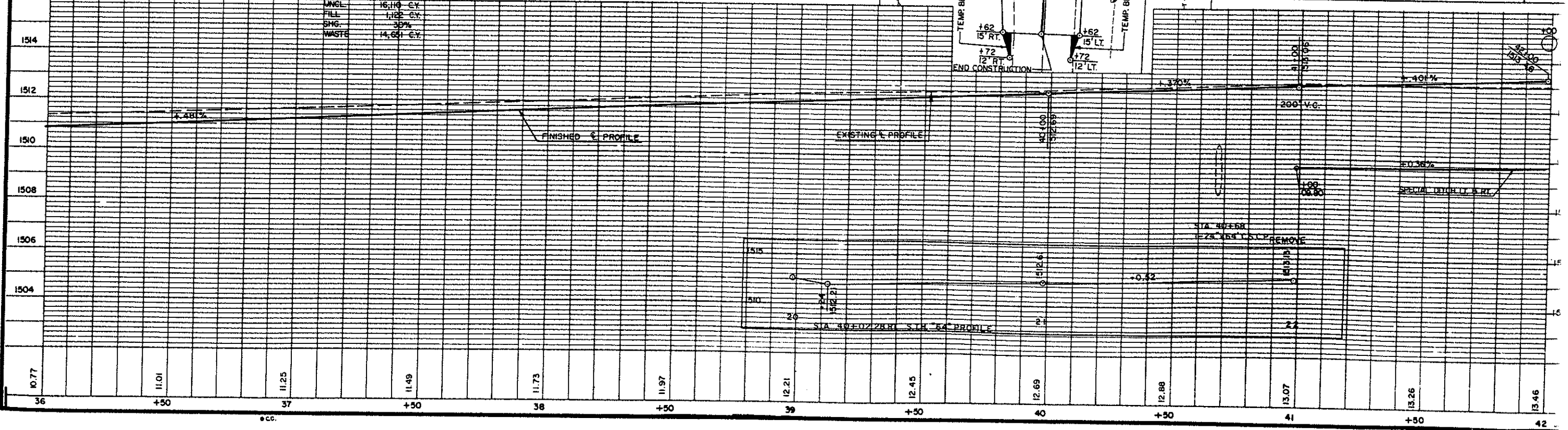

STATE PROJECT NUMBER	SHEET NO.
1602-01-71	55
PLAN AND PROFILE STA. 42+00 - STA. 57+00	
USH 45	LANGLADE COUNTY

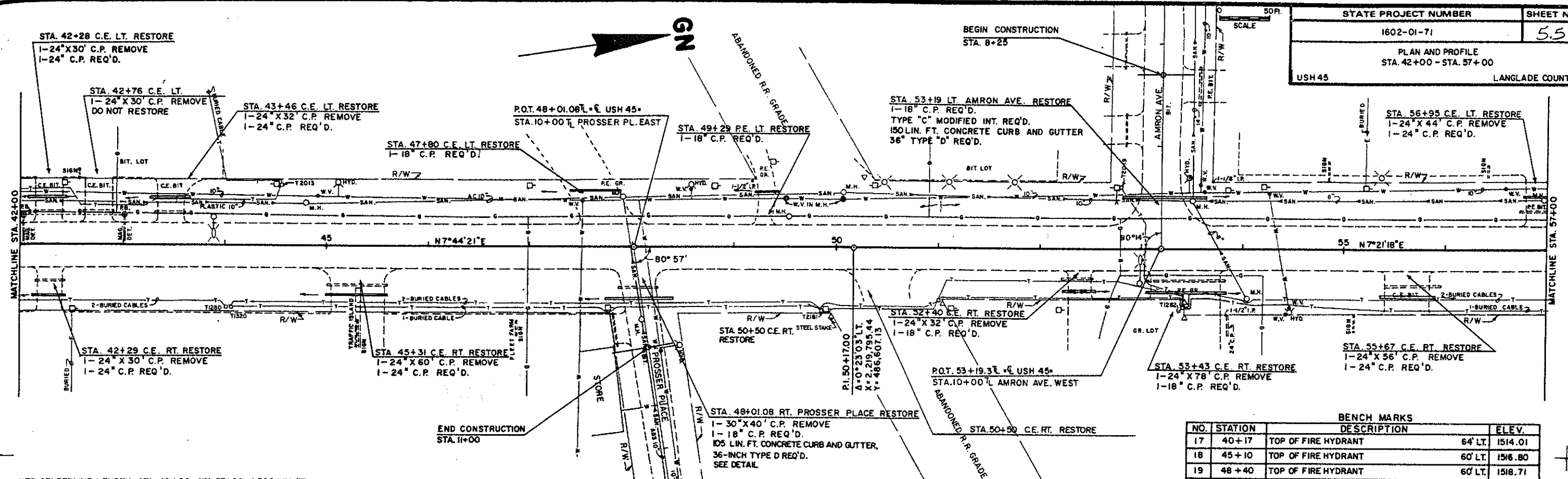

NET CENTERLINE LENGTH, STA. 42+00 - STA. 57+00 = 1,500 LIN. FT.

BENCH MARKS			
NO.	STATION	DESCRIPTION	ELEV.
17	40+17	TOP OF FIRE HYDRANT	64' LT. 1514.01
18	45+10	TOP OF FIRE HYDRANT	60' LT. 1516.80
19	48+40	TOP OF FIRE HYDRANT	60' LT. 1518.71
20	53+45	TOP OF FIRE HYDRANT	60' LT. 1516.01

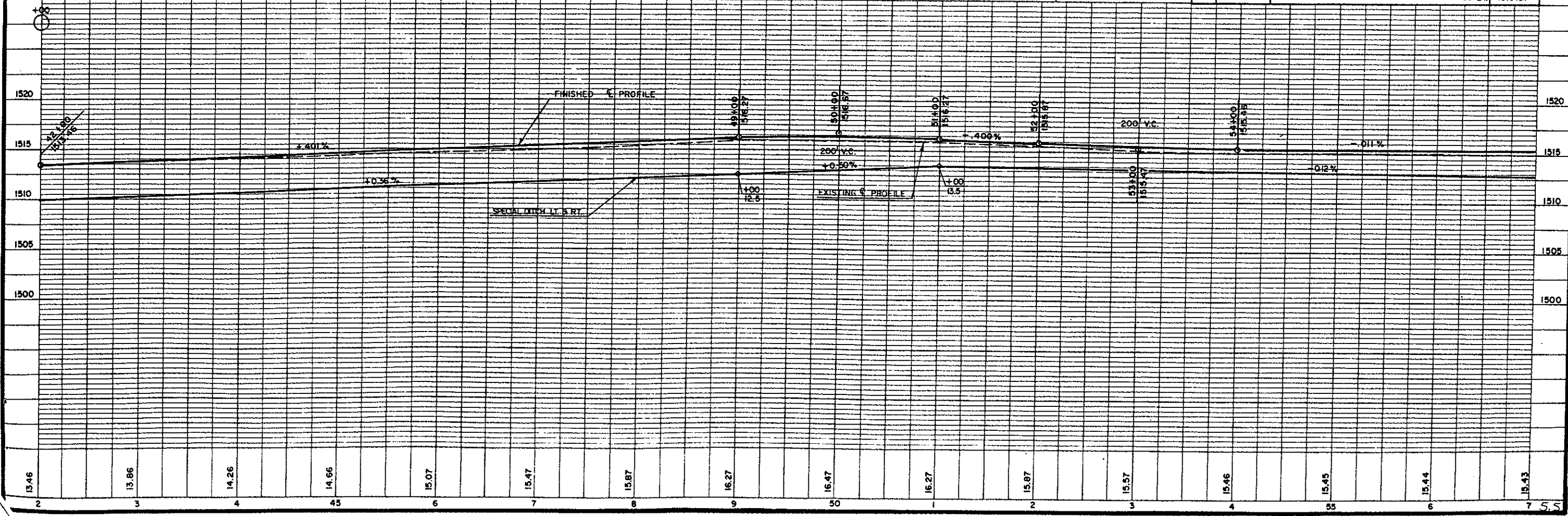

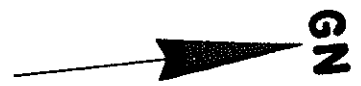

0 50 FT.
SCALE

STATE PROJECT NUMBER	SHEET
1602-01-71	5
PLAN AND PROFILE	
STA. 57+00 - STA. 72+00	
USH 45	LANGLADE CO

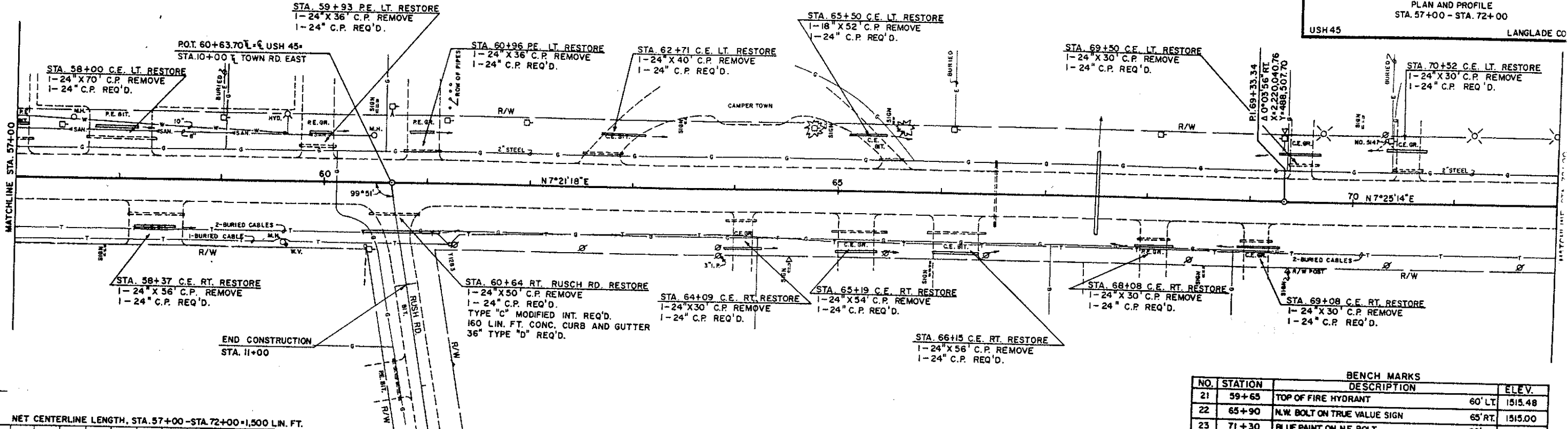

BENCH MARKS			
NO.	STATION	DESCRIPTION	ELEV.
21	59+65	TOP OF FIRE HYDRANT	60' LT. 1515.48
22	65+90	N.W. BOLT ON TRUE VALUE SIGN	65' RT. 1515.00
23	71+30	BLUE PAINT ON N.E. BOLT	60' LT. 1516.33

NET CENTERLINE LENGTH, STA. 57+00 - STA. 72+00 = 1,500 L.N. FT.

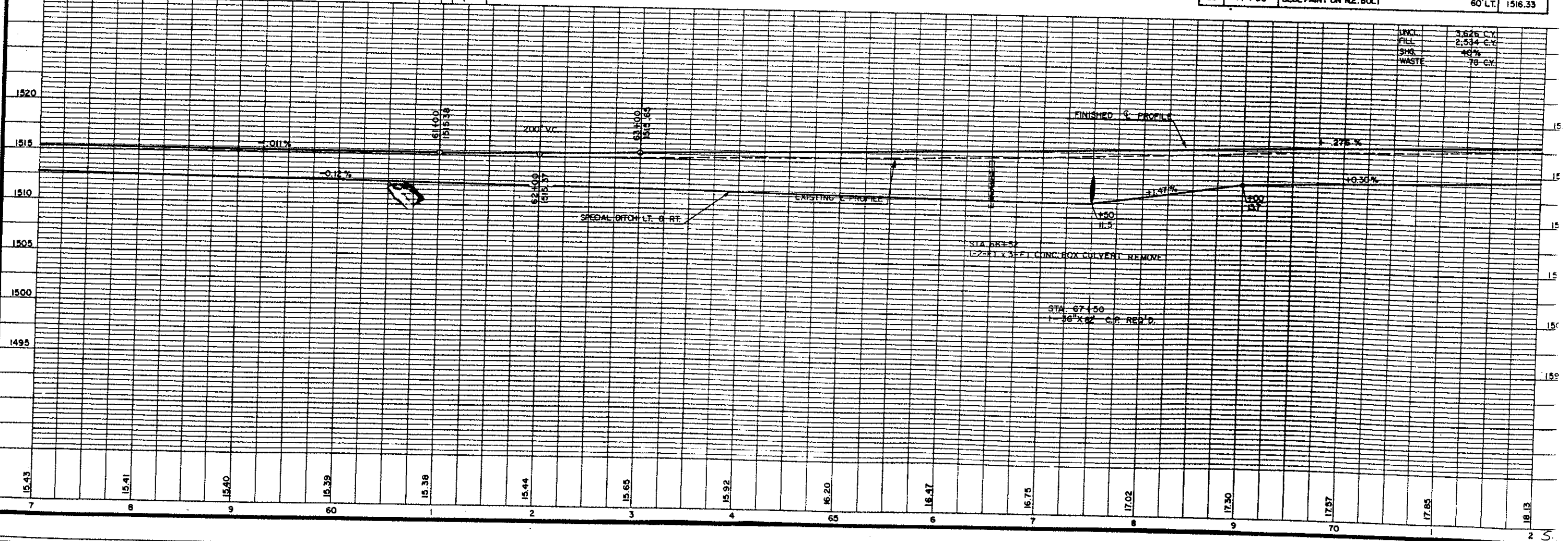

UNCL.	3,626 C.Y.
FILL	2,534 C.Y.
SHG.	48%
WASTE	78 C.Y.

STATE PROJECT NUMBER	SHEET NO.
1602-01-71	5.7
PLAN AND PROFILE	
STA. 72+00 - STA. 87+00	
USH 45	LANGLADE COUNTY

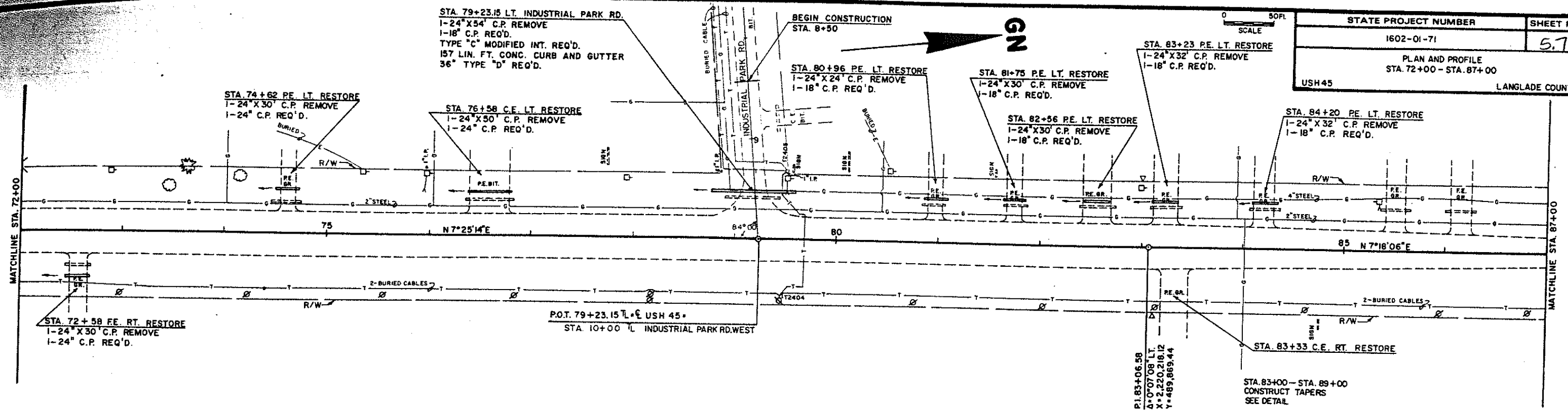

NET CENTERLINE LENGTH, STA. 72+00 - STA. 87+00 = 1,500 LIN. FT.

BENCH MARKS			
NO.	STATION	DESCRIPTION	ELEV.
23	71+30	BLUE PAINT ON N.E. BOLT	60' LT 1516.33
24	76+80	50d SPIKE IN TEL. POLE	50' RT 1517.50
25	82+00	50d SPIKE IN TEL. POLE	50' RT 1519.04
26	86+85	50d SPIKE IN TEL. POLE	50' RT 1519.47

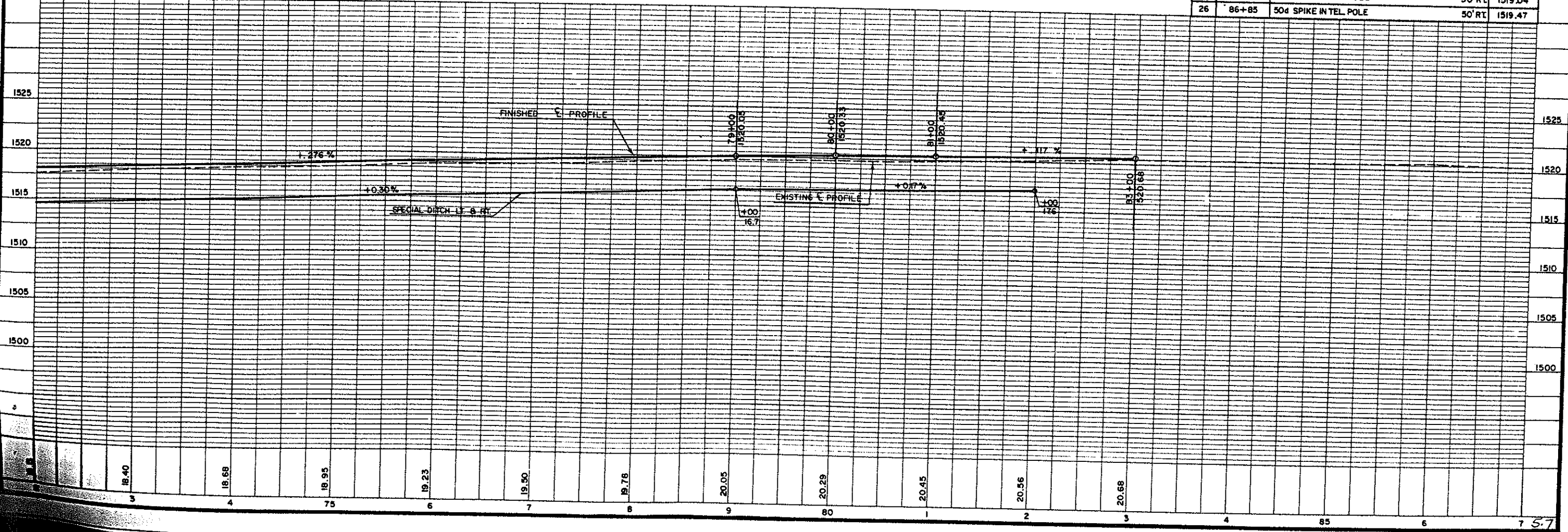



0 50 Ft
SCALE

STATE PROJECT NUMBER
1602-01-71
PLAN AND PROFILE
STA. 87+00 - STA. 91+00
USH45

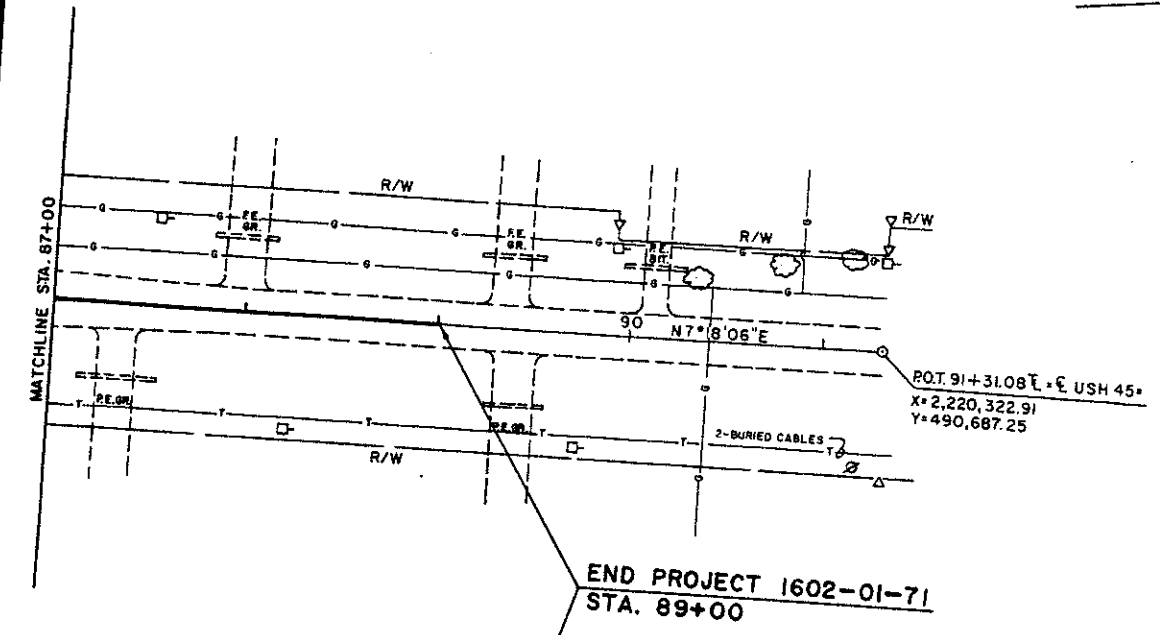

NET CENTERLINE LENGTH, STA. 87+00 - STA. 89+00 = 200 LIN. FT.

NO.	STATION	BENCH MARKS	
		DESCRIPTION	
26	86+85	50d SPIKE IN TEL. POLE	50' RT.
27	92+50	50d SPIKE IN TEL. POLE	50' RT.

