

RECORD # 20237

LANGLADE COUNTY SURVEYORS OFFICE

DATE FILED: 6/12/03 BY: D. TRUSTY

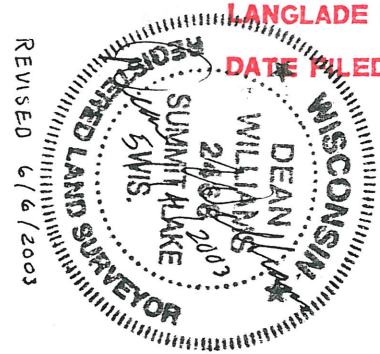

I, DEAN A. WILLIAMS CERTIFY THAT I HAVE ACCURATELY SURVEYED, DIVIDED AND MAPPED UNDER THE DIRECTION OF EDDIE WOODY AND RANDY JOHNSON; THE E 1/2 OF THE NW 1/4 IN SEC. 4 T32N-R9E, TOWN OF VILAS, LANGLADE COUNTY, WISCONSIN.



TIMBER WOLF LAND SURVEYING
DEAN WILLIAMS RLS-2468
715-275-4322

BEARINGS REFERENCED TO THE NORTH LINE OF THE NW 1/4 OF SECTION 4 T32N R9E ASSUMED TO BEAR: N89°14'41"E

TIMBER WOLF LAND SURVEYING
DEAN A. WILLIAMS RLS-2468
EDDIE WOODY & RANDY JOHNSON
5/14/2003 MAP# 2003-6

MAP OF SURVEY

