

TIMBER WOLF LAND SURVEYING - DEAN A. WILLIAMS RLS - 2468 715-627-2500

# MAP OF SURVEY

E 1/2 OF THE SW1/4-SE1/4, EXCEPT THE SOUTH 15 RODS OF THE WEST 21 RODS, AND EXCEPT HWY. 64 R/W.

BEARINGS REFERENCED TO THE EAST LINE OF THE SE 1/4 SECTION 8, T31N, R14E, ASSUMED TO BEAR: S89°59'52"W.



I, DEAN A. WILLIAMS, REGISTERED LAND SURVEYOR HEREBY CERTIFY THAT I HAVE SURVEYED AND MAPPED DOCUMENT #382045, PARCEL #034-0127.001 FOR MARY AND ROBERT PETERSON, A PARCEL OF LAND BEING THE EAST HALF OF THE SW-SE, SECTION 8, T31N, R14E EXCEPT THE S. 15 RODS OF THE W. 21 RODS AND EXCEPT NEW HWY. 64 R/W, MORE PARTICULARLY DESCRIBED AS FOLLOWS:

PARCEL 1; COMMENCING AT THE SOUTHEAST CORNER OF SAID SECTION 8; THENCE S89°59'52"W, 1331.87' TO THE POINT OF BEGINNING; THENCE CONTINUING S89°59'52"W, 318.74'; THENCE N3°37'44"E, 248.00'; THENCE S89°59'52"W, 347.20'; THENCE N3°37'44"E, 22.41'; THENCE 874.10' ALONG AN ARC OF A 2351.89' RADIUS CURVE CONCAVE TO THE NORTHWEST WHOSE LONG CHORD BEARS N46°18'04"E, 703.31'; THENCE N37°07'24"E, 87.80'; THENCE S3°06'30"W, 923.33' TO THE POINT OF BEGINNING.

PARCEL 2; COMMENCING AT THE SOUTHEAST CORNER OF SAID SECTION 8; THENCE S89°59'52"W, 1331.87'; THENCE CONTINUING S89°59'52"W, 318.74'; THENCE N3°37'44"E, 248.00'; THENCE S89°59'52"W, 347.20'; THENCE N3°37'44"E, 22.41'; THENCE CONTINUING N3°37'44"E 199.22' TO POINT OF BEGINNING; THENCE CONTINUING N3°37'44"E, 845.05'; THENCE N89°40'52"E, 654.18'; THENCE S3°06'30"W, 108.25'; THENCE 706.36' ALONG AN ARC OF A 2191.89' RADIUS CURVE CONCAVE TO THE NORTHWEST WHOSE LONG CHORD BEARS S47°48'12"W, 703.31' TO THE POINT OF BEGINNING.

THESE PARCELS CONTAIN 14.30 ACRES OR 622,528 SQUARE FEET OF WHICH 10,522 SQUARE FEET ARE ROAD R/W.

CURVE TABLE		
	A-B	C-D
△	21°14'40"	18°27'51"
RADIUS	2351.89'	2191.89'
LENGTH	874.10'	706.36'
CHORD	869.07'	703.31'
CHORD BEARING	N47°48'12"E	S46°18'04"W

- LEGEND**
- ⊕ — FOUND RR SPIKE
  - — FOUND ALUM. MON.
  - — FOUND .75" I.R.
  - — FOUND 1" I.P.
  - — SET 1" X 24" I.P. 1.03 LBS/FT
  - ⊙ — SET SURVEY NAIL

SW COR. S89°03'11"W 2645.20' BY TIES

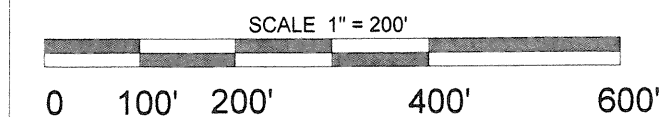

INSTRUMENT DRAFTED BY DEAN A. WILLIAMS 7/11/2013

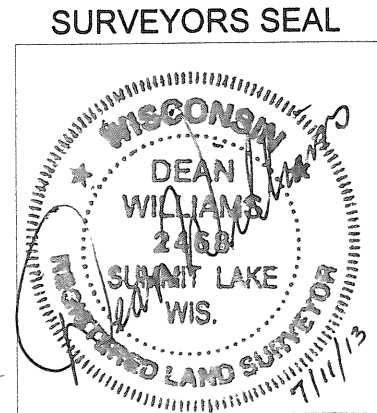

RECORD # 20423  
 LANGLADE COUNTY SURVEYORS OFFICE  
 DATE FILED: 7/16/13 BY: D.J. LUSTY

