

PLAT OF SURVEY

PART OF THE NE1/4 OF THE SE1/4 OF SECTION 5, T33N-R12E,
TOWN OF AINSWORTH, LANGLADE COUNTY, WISCONSIN

LEGEND

- () YEAR PARCEL FIRST CONVEYED
- △ COMPUTED POINT
- FOUND 1.3" IRON PIPE
- ⊙ FOUND 2" IRON PIPE
- SET 1.05" O.D. X 18" LONG IRON PIPE WEIGHING 1.13 LBS/LF

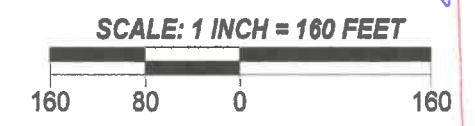

RECORD # 20504
 LANGLADE COUNTY SURVEYORS OFFICE
 BY: D. TUSTY
 DATE FILED: 11/20/2020

I, TIMOTHY J. RUSCH, PROFESSIONAL LAND SURVEYOR, DO HEREBY CERTIFY:

THAT I HAVE SURVEYED AND MAPPED BY THE ORDER OF CRAIG PRIEM, OWNER, A PART BEING OF THE NE1/4 OF THE SE1/4 OF SECTION 5, T33N-R12E.

DESCRIBED AS FOLLOWS:
 COMMENCING AT THE EAST 1/4 CORNER OF SECTION 5; THENCE S01°00'01"E, ALONG THE EAST LINE OF THE NE1/4 SE1/4 OF SAID SECTION, 665.05 FEET TO THE POINT OF BEGINNING; THENCE N88°50'47"W, ALONG THE NORTH LINE OF THE SOUTH 1/2 OF SAID NE1/4 SE1/4, 660.47 FEET; THENCE S01°00'01"E, ALONG THE WEST LINE OF THE NORTH 165' OF THE SOUTH 660' OF THE EAST 660' OF SAID SE1/4 NE1/4, 166.82 FEET; THENCE S88°36'14"E, ALONG THE SOUTH LINE OF SAID NORTH 165' OF THE SOUTH 660' OF THE EAST 660' OF SAID NE1/4 SE1/4, 9.87 FEET; THENCE S01°01'52"W, ALONG THE EAST LINE OF CERTIFIED SURVEY MAP VOLUME 2 PAGE 242, 330.01 FEET TO THE POINT OF TERMINATION.

THAT THIS SURVEY WAS FOR THE PURPOSE OF LOCATING CERTAIN PROPERTY BOUNDARIES ONLY. OTHER GEOGRAPHICAL FEATURES WERE NOT MAPPED.

THAT THIS IS A TRUE AND CORRECT REPRESENTATION OF THE BOUNDARIES SURVEYED TO THE BEST OF MY KNOWLEDGE AND BELIEF.

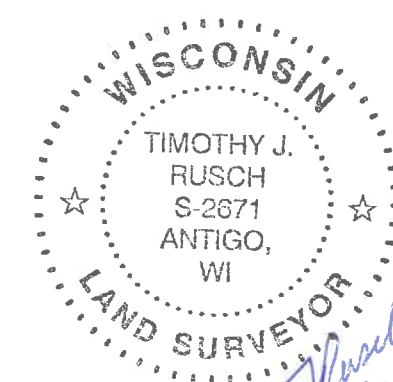

T. Rusch
12-13-2019

SURVEYED BY:
 RUSCH ENGINEERING & SURVEYING LLC
 400 RUSCH ROAD
 ANTIGO, WI 54409
 (715)623-5044
 PROJECT # 19-5952
 FIELD WORK COMPLETED 07/17/2019

