

DESCRIPTION

A parcel of land located in the Southeast one-quarter (SE $\frac{1}{4}$) of the Southeast one-quarter (SE $\frac{1}{4}$) of Section 1, T.33N., R.10E., Town of Upham West Part, Langlade County, Wisconsin, being more particularly described as follows;

Commencing at the Southeast Corner of Section 1, T.33N., R.10E., Town of Upham West Part, Langlade County, Wisconsin, Thence N6°-59'-39\"E along the East line of Section 1, 678.48 feet to the Point of Beginning, Thence continuing N6°-59'-39\"E along the East Line of Section 1, 660.00 feet to the South one-eighth (S1/8) line, Thence S88°-42'-10\"W along the South one-eighth (S1/8) line, 330.00 feet, Thence S6°-59'-39\"W parallel with the East section line of the Southeast one-quarter (SE $\frac{1}{4}$) of Section 1, 660.00 feet, Thence N88°-42'-10\"E parallel with the South one-eighth (S1/8) line of Section 1, 330.00 feet to the Point of Beginning.

I, Gary A. Radtke, Registered Land Surveyor certify that this map is a correct representation of all exterior boundaries of this survey and was done under the direction of Mr. Eugene Houdek owner of said property.

Gary A. Radtke
 Gary A. Radtke S-1248



LOCATION SKETCH

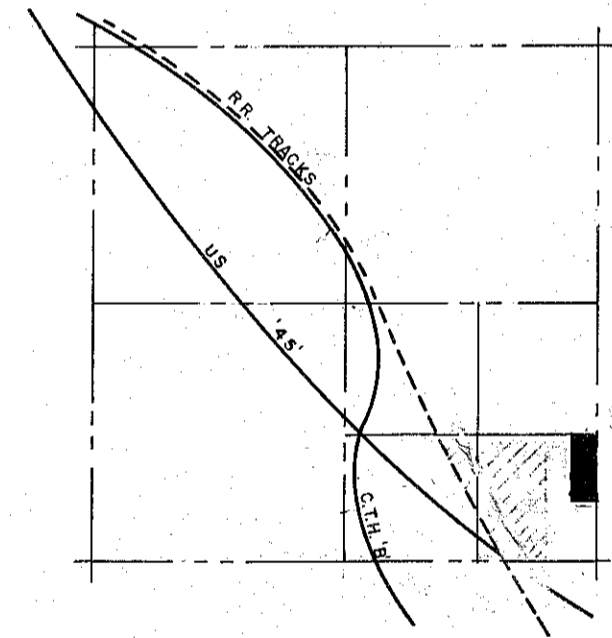

SEC. 1 T.33N. - R.10E. TOWN OF UPHAM, LANGLADE CO. WISC.

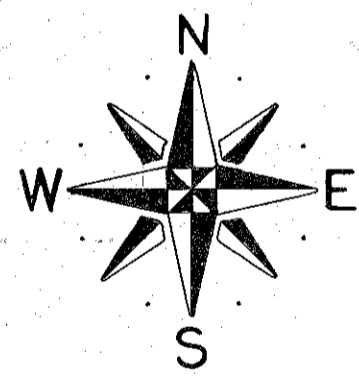

RECORD # 30034
 LANGLADE COUNTY SURVEYORS OFFICE
 DATE FILED: 5/24/93 BY: D.T.

DYNAMIC ENGINEERING - SURVEYING INC.			
SCALE	1" = 100'	REVISIONS	BY DATE
DATE	10-24-77		
DR'N.	DK.	CKD.	GR
AP'VD.	GR		
TITLE	HOUDEK		NO. 773-775