

PLAT OF SURVEY

PART OF THE NE1/4 NE1/4, SE1/4 NE1/4 AND NE1/4 SE1/4,
SECTION 27, T33N-R13E, TOWN OF LANGLADE,
LANGLADE COUNTY, WISCONSIN

SCALE: 1 INCH = 250 FEET

PARCEL DESCRIPTION:

Commencing at the Southeast Corner of Section 27; Thence N89°11'28"W, along the south line of the SE1/4 of said Section, 1319.15 feet; Thence N00°59'16"E, along the west line of the SE1/4 SE1/4 of said Section, 1299.16 feet to the Point of Beginning; Thence continuing N00°59'16"E, along the west line of the NE1/4 SE1/4 of said Section, 1299.16 feet; Thence N00°26'20"E, along the west line of the East 1/2 of said Section, 2593.66 feet; Thence N87°18'07"E, along the north line of the NE1/4 NE1/4 of said Section, 337.92 feet; Thence S00°26'18"W, 982.54 feet; Thence S45°26'27"E, 448.92 feet; Thence N88°40'46"E, along the north line of the SE1/4 NE1/4 of the SE1/4 NE1/4 of said Section, 676.42 feet; Thence S35°25'22"W, 99.83 feet; Thence S22°36'30"W, 95.11 feet; Thence S58°26'41"E, 75.04 feet; Thence S10°18'34"W, 103.02 feet; Thence S03°56'31"E, 55.20 feet; Thence S53°20'12"W, 145.69 feet; Thence N89°29'33"W, 92.51 feet; Thence S65°49'06"W, 75.34 feet; Thence S43°42'27"W, 63.32 feet; Thence S53°10'53"W, 117.18 feet; Thence S30°59'18"W, 55.77 feet to a meander corner which lies N89°56'29"W, 38 feet more or less from the center thread of the Lily River; Thence N89°56'29"W, 36.99 feet to a meander corner; Thence S34°38'32"W, along a meander line, 399.78 feet; Thence S07°47'48"W, along a meander line, 981.21 feet to a meander corner which lies N89°34'14"W, 80 feet more or less from the center thread of the Lily River; Thence N89°34'14"W, along the south line of the NE1/4 SE1/4 of said Section, 373.65 feet to the Point of Beginning; Including the lands between the meander line and the center thread of the Lily River between the parcel lines extended in the NE1/4 SE1/4 as shown herewith.

TOTAL AREA
67.71 ACRES
(2,949,649 SQ FT)

ID	Bearing	Distance
L1	S 35°25'22" W	99.83'
L2	S 22°36'30" W	95.11'
L3	N 84°40'13" W	89.57'
L4	S 21°02'29" W	50.07'
L5	S 58°26'41" E	75.04'
L6	S 10°18'34" W	103.02'
L7	S 03°56'31" E	55.20'
L8	S 53°20'12" W	145.69'
L9	N 80°29'33" W	92.51'
L10	S 65°49'06" W	75.34'
L11	S 43°42'27" W	63.32'
L12	S 53°10'53" W	117.18'
L13	S 30°59'18" W	55.77'

1-A- FOUND IRON PIPE IS S85°08'45"W, 0.91'
OF OLD LOCATED SECTION,
2- FOUND IRON PIPE IS S83°58'18"W,
CALCULATED 40 LINE
3- FOUND IRON PIPE IS N89°59'18"E, 9.74'
OF CALCULATED POINT ON 40 LINE

- LEGEND**
- WOODS ROAD/TRAIL
 - COMPUTED POINT
 - FOUND 1" IRON PIPE
 - SET 1.05" O.D. X 24" LONG IRON PIPE WEIGHING 1.13 LBS/LF
 - SET 1.05" O.D. X 48" LONG IRON PIPE WEIGHING 1.13 LBS/LF

RECORD # 30052
LANGLADE COUNTY SURVEYORS OFFICE
DATE FILED: 5/10/17 BY: D. Tussy

BEARINGS REFERENCED TO THE LANGLADE COUNTY COORDINATE SYSTEM GRID

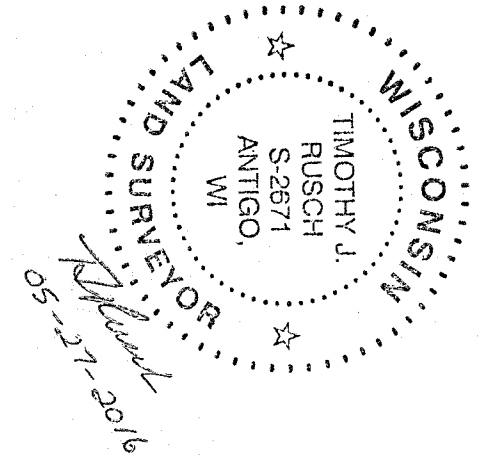

I, Timothy J. Rusch, Professional Land Surveyor, do hereby certify:
That I have surveyed and mapped by the order of Louise Keating, property described in Deed #314571, being part of the NE1/4 NE1/4, SE1/4 NE1/4 and NE1/4 SE1/4, Section 27, T33N-R13E. That this survey was for the purpose of locating property boundaries only. Other geographical features were not mapped.
That this is a true and correct representation of the boundaries surveyed to the best of my knowledge and belief.

SURVEYED BY:
RUSCH ENGINEERING & SURVEYING LLC
400 RUSCH ROAD
ANTIGO, WI 54409
(715)623-5044
PROJECT # 16-5562

