

NE. COR.  
SEC. 25  
T. 31N. - R. 10E.

DESCRIPTION

A parcel of land located in the West one-half (1/2) of the Northeast one-quarter (NE 1/4) of the Northeast one-quarter (NE 1/4) of Section 25, T. 31N., R. 10E., Town of Ackley, Langlade County, Wisconsin being more particularly described as follows;

Commencing at the Northeast Corner of Section 25, T. 31N., R. 10E., Town of Ackley, Langlade County, Wisconsin. Thence N90°-00'-00"W along the North line of said Section 637.67 feet to the point of beginning, which is the Northeast corner of the Northwest one-quarter (NW 1/4) of the Northeast one-quarter (NE 1/4) of the Northeast one-quarter (NE 1/4) of Section 25, T. 31N., R. 10E., Thence S2°-29'-30"W along the East line of said NW 1/4 250.00 feet. Thence N90°-00'-00"W 112.00 feet, Thence N2°-29'-30"E to the north line of said Sec., Thence S90°-00'-00"E along the North line of said Sec. 112.00 feet to the point of beginning, except road right of way

I, Gary A. Radtke, Registered Land Surveyor certify that I made such survey and map under the direction of Mr. Don Bloedorn owner of said land. That the map is a correct representation of exterior boundaries of the survey.

*Gary A. Radtke*  
GARY A. RADTKE S-1248

Dated 25 May 77

LOCATION SKETCH

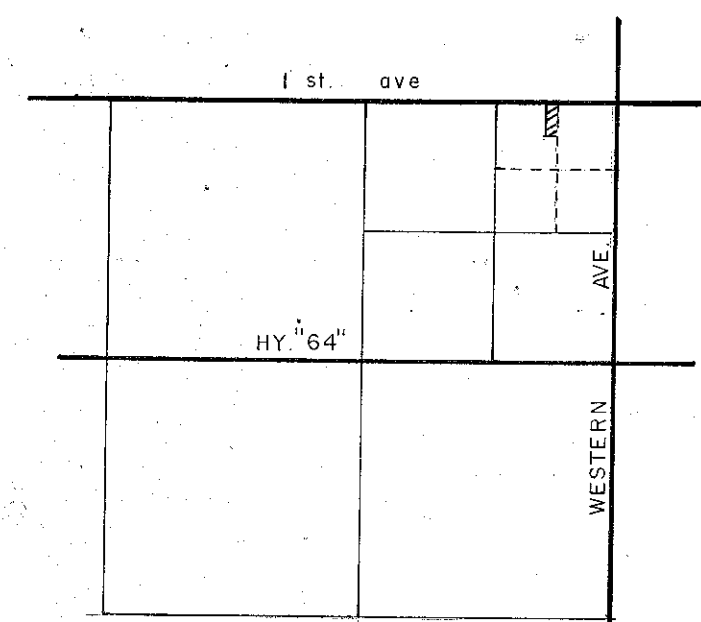

SEC. 25 T. 31N. - R. 10E.  
LANGLADE CO., WIS.

RECORD # 30069  
LANGLADE COUNTY SURVEYORS OFFICE  
DATE FILED: 5/24/93 BY: D.T.

DYNAMIC ENGINEERING & SURVEYING			
SCALE	REVISIONS	BY	DATE
1" = 20'			
DATE	5-25-77	Eliminate forty and put NE 1/4	PV 77
DRN	PV	CHK	PV
AP'VD	PV		
TITLE	DON BLOEDORN		
NO.	651 S 77		