

DESCRIPTION

Southeast (SE 1/4) (SE 1/4)

A parcel of land located in the Southwest one-quarter (SW 1/4) of the Southwest one-quarter of Section 20, T.31N., R.13E., Town of Evergreen, Langlade County, Wisconsin, being more particularly described as follows;

Commencing at the South one-quarter (S 1/4) of Section 20, T.31N., R.13E., Town of Evergreen, Langlade County, Wisconsin, Thence N0°-00'-00"E, along the Center Section Line of said Section 20, 923.50 feet to the Point of Beginning, Thence continuing N0°-00'-00"E along the Center Section Line and Center Line of Flak Road, 400.00 feet, Thence S88°-14'-00"W, along an existing fence line (1977), north line of said forty, 217.80 feet, Thence S0°-00'-00"W, 400.00 feet, Thence N88°-14'-00"E, 217.80 feet to the Point of Beginning, except road Right of Way for Flak Road.

I, Gary A. Radtke, Registered Land Surveyor certify that I have surveyed and mapped under the direction of Jim Flak, owner of said land. That the map is a correct representation of all exterior boundaries of the survey.

*Gary A. Radtke*  
GARY A. RADTKE S-1248

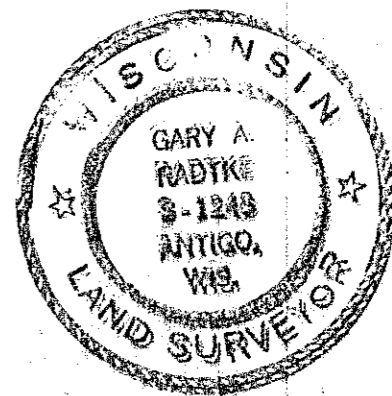

LOCATION SKETCH

SCALE 1"=2000'

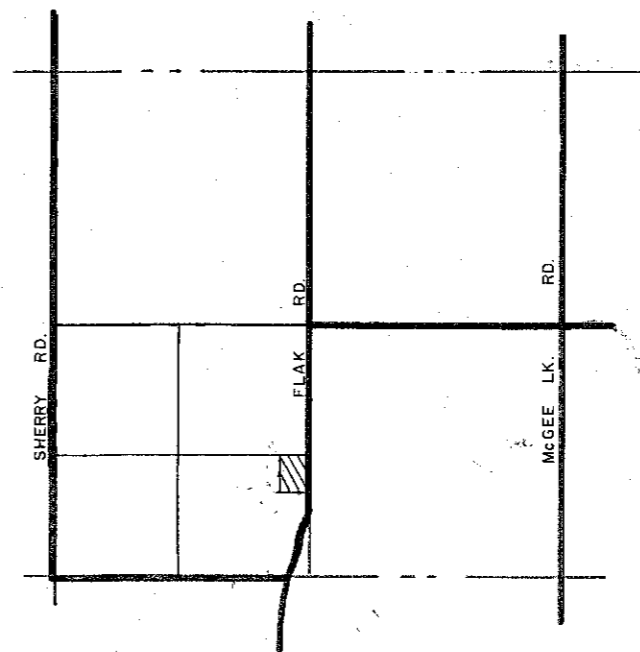

SECTION 20 T.31N. - R.13E.  
TOWN OF EVERGREEN

RECORD # 30078  
LANGLADE COUNTY SURVEYORS OFFICE  
DATE FILED: 5/24/93 BY: D.T.

DYNAMIC ENGINEERING - SURVEYING			
SCALE	REVISIONS	BY	DATE
1" = 60'			
DATE			
4-20-77	SE 1/4 & SW 1/4	GAR	7/1/77
DR'N.	J.F.	CKD	
AP'VD.	GAR		
TITLE	FLAK		NO.
			606